

SKY VISTA COMMONS (#4819)

PORTION OF SE 1/4 OF SECTION 5, T20N - R19E

STATE OF NEVADA
WASHOE COUNTY
ASSESSOR'S OFFICE
 Michael E. Clark, Assessor

1001 East Ninth Street
 Building D
 Reno, Nevada 89512
 (775) 328-2231

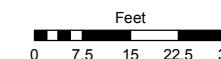

1 inch = 30 feet



created by: JMO 04/25/2016

last updated: _____

area previously shown on map(s)

NOTE: This map was prepared for the use of the Washoe County Assessor for assessment and illustrative purposes only. It does not represent a survey of the premises. No liability is assumed as to the sufficiency or accuracy of the data delineated hereon.

BUILDINGS 18 & 19

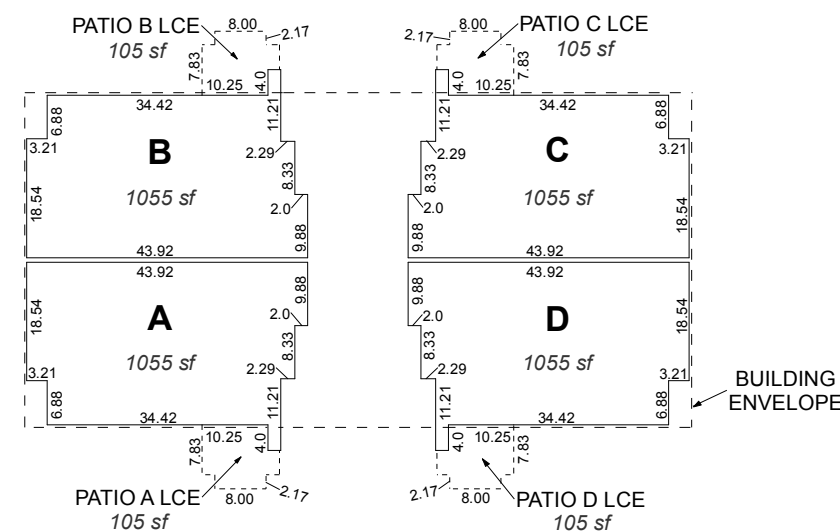

FIRST FLOOR

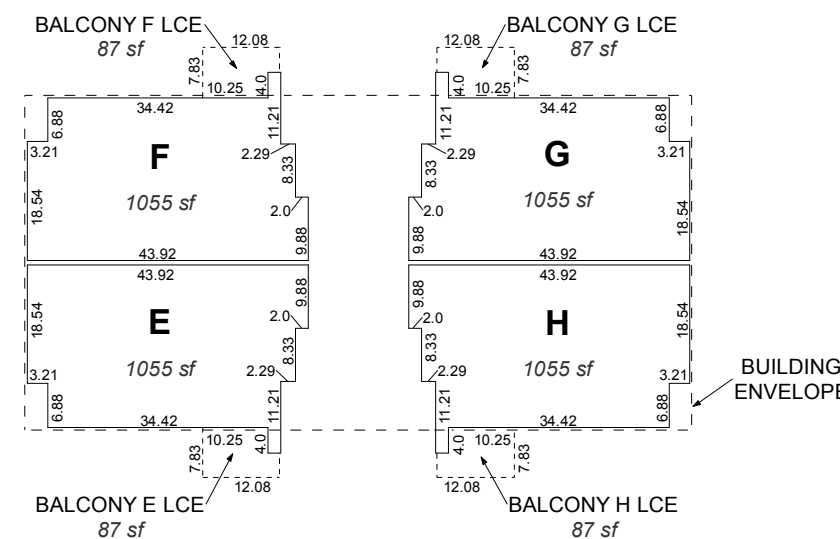

SECOND FLOOR

NOTES:

LCE = LIMITED COMMON ELEMENT

Square footage of each unit includes all internal living space. It does not include the Limited Common Element (LCE).

All dimensions are to front face of stud.

BUILDING 29

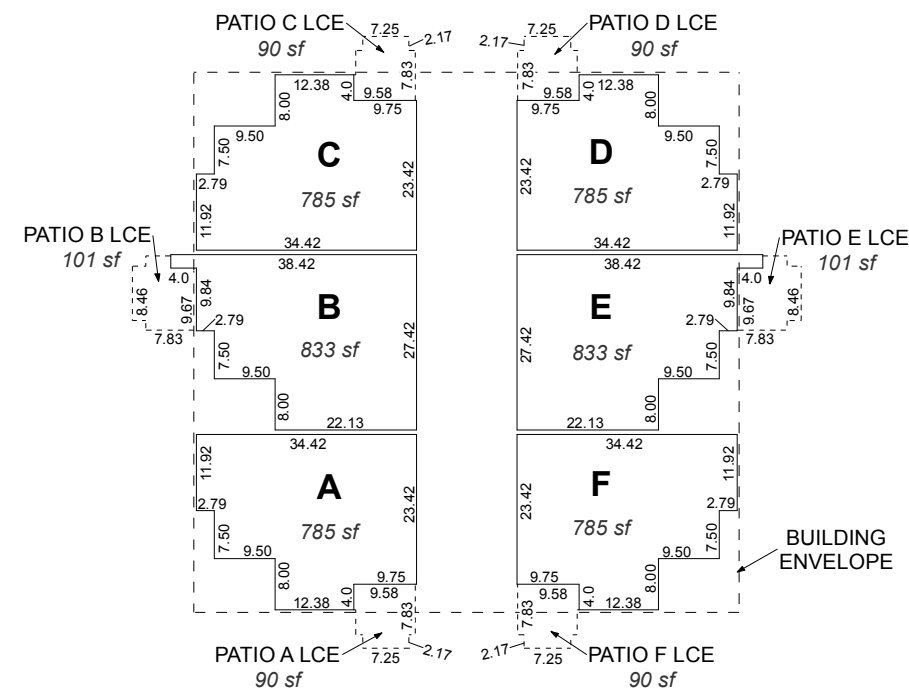

FIRST FLOOR

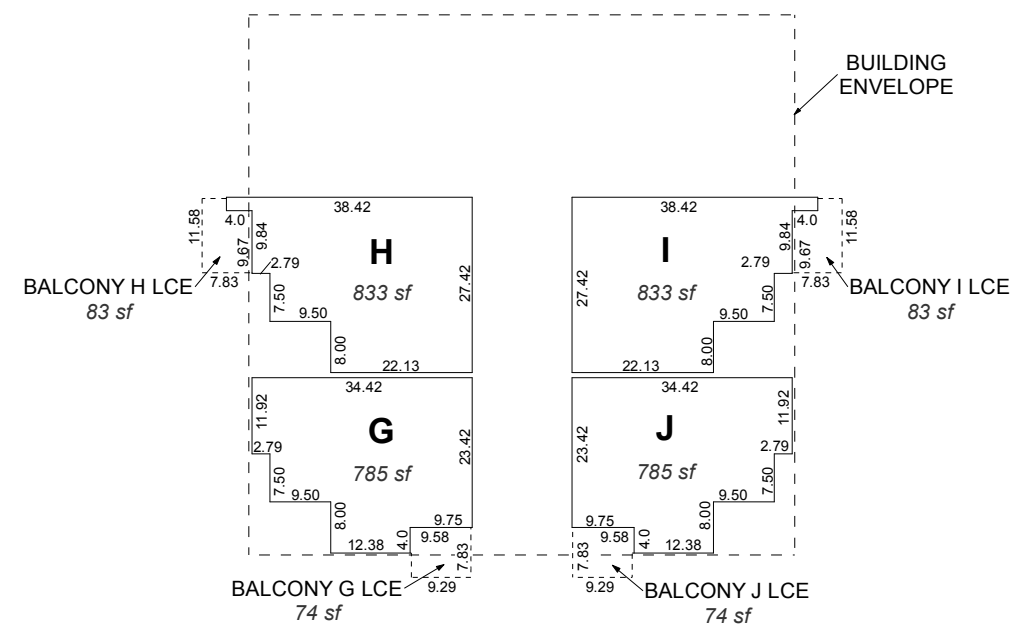

SECOND FLOOR