

STATE OF NEVADA  
**WASHOE COUNTY**  
ASSESSOR'S OFFICE  
1001 East Ninth Street, Building D  
Reno, Nevada 89512  
(775) 328-2231

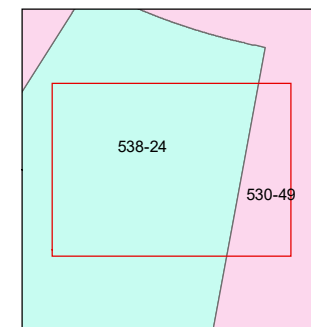

1 inch = 20 feet

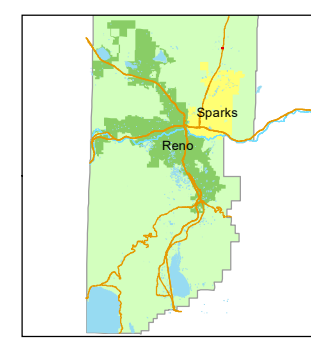

created by: SR 01/19/2021

updated: \_\_\_\_\_

area previously shown on map(s):  
530-49

NOTE: This map was prepared for the use of the Washoe County Assessor for assessment and illustrative purposes only. It does not represent a survey of the premises. No liability is assumed as to the sufficiency or accuracy of the data delineated hereon.

COMMON AREA WITHIN BUILDING

242

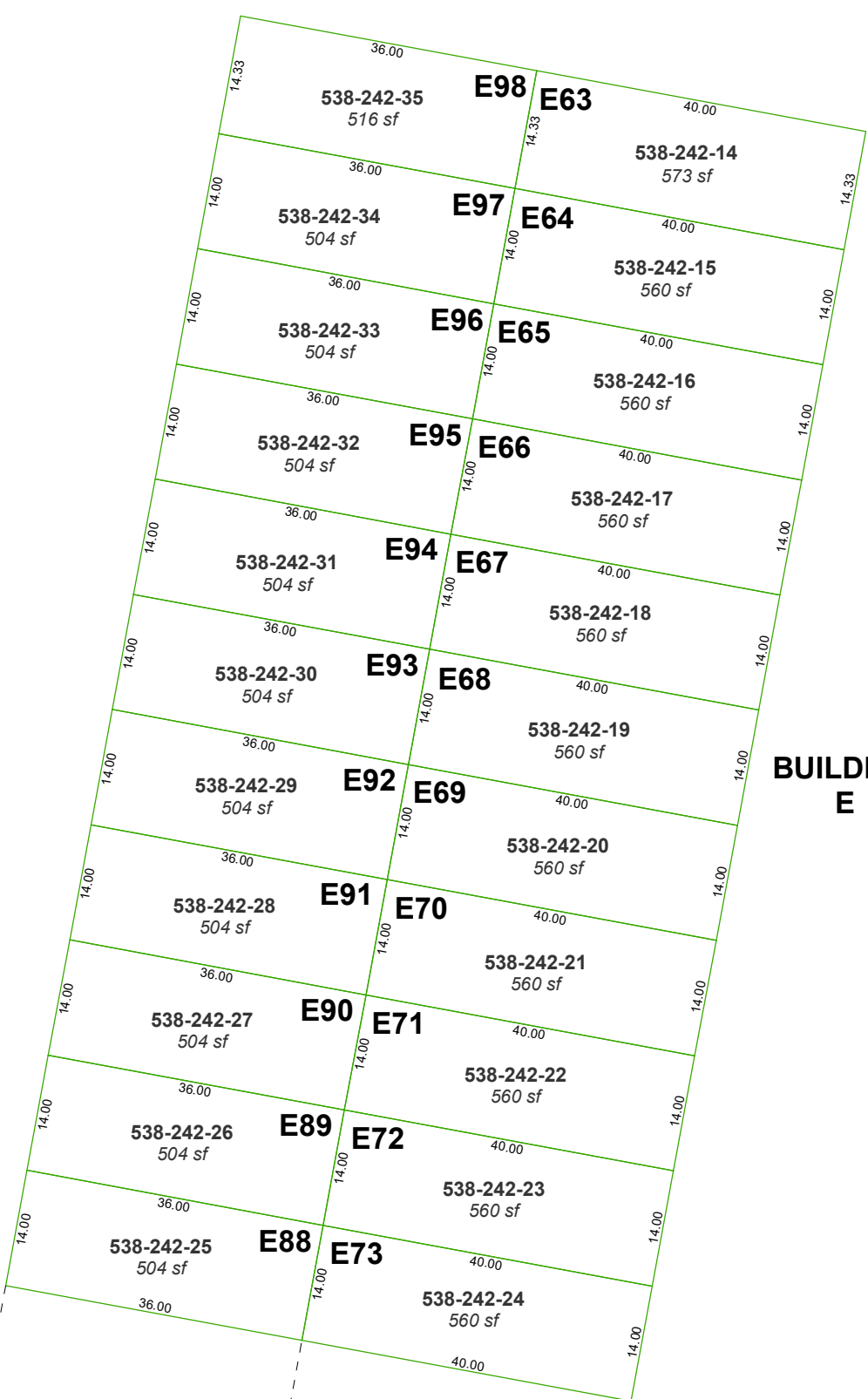

**BUILDING E**

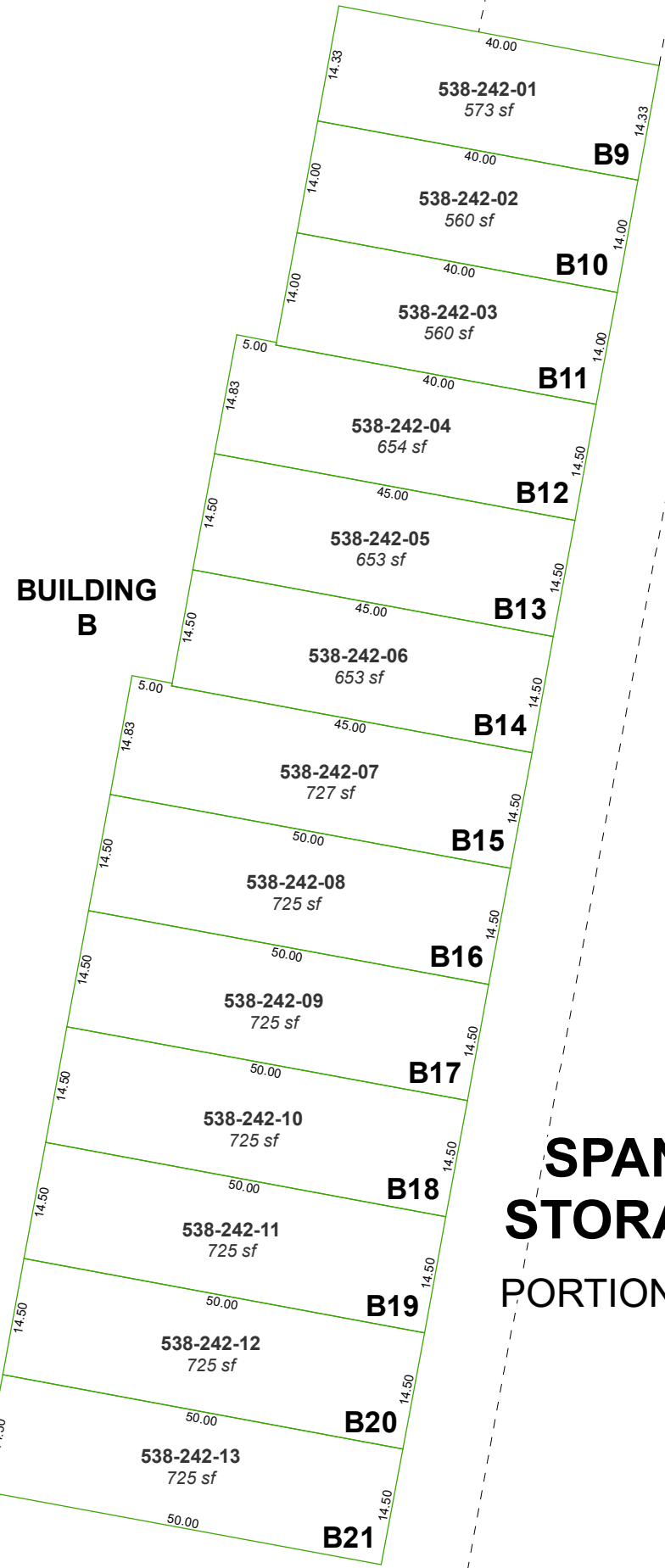

**BUILDING B**

**(#5403)**  
**SPANISH SPRINGS**  
**STORAGE PARTNERS**  
PORTION OF NE¼ SECTION 23  
T21N - R20E

NOTE: ALL PARCELS ARE FOR NON-RESIDENTIAL USE ONLY

538-24-S3