

STATE OF NEVADA  
**WASHOE COUNTY**  
ASSESSOR'S OFFICE

1001 East Ninth Street, Building D  
Reno, Nevada 89512  
(775) 328-2231

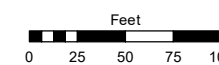

1 inch = 100 feet

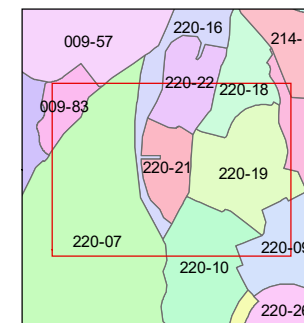
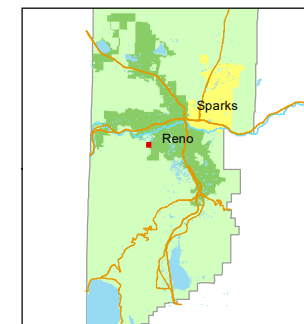

created by: JRA 12/10/2020

updated: \_\_\_\_\_

area previously shown on map(s):  
220-16

**(#3752)**  
**EVERGREEN - UNIT FOUR**  
A PLANNED UNIT DEVELOPMENT  
AT THE CAUGHLIN RANCH  
PORTION OF THE NE 1/4 SECTION 29  
PORTION OF THE SE 1/4 SECTION 20  
T19N - R19E

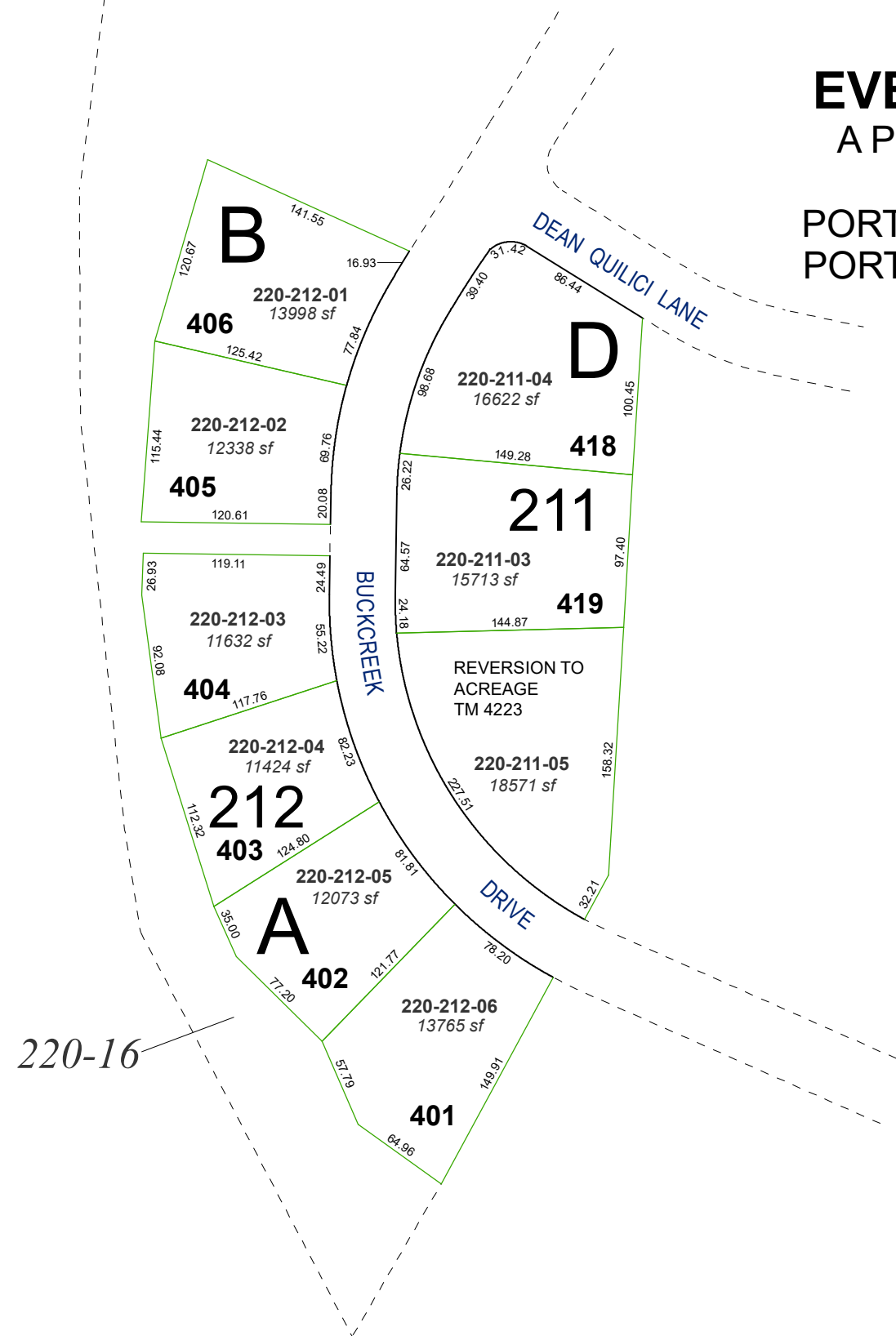

NOTE: Common Area "B" is parceled on 220-16

NOTE: This map was prepared for the use of the Washoe County Assessor for assessment and illustrative purposes only. It does not represent a survey of the premises. No liability is assumed as to the sufficiency or accuracy of the data delineated hereon.