

(#3298)

PINEWOOD CONDOMINIUMS

POR. SW ¼ SEC. 15, T16N - R18E
TO EACH AN UNDIVIDED 1/24th INTEREST

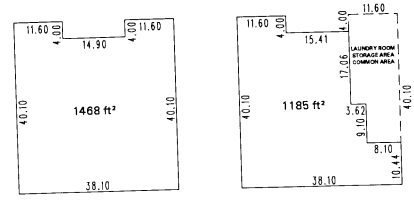

TYPICAL UNIT (EXCEPT UNIT 4)
SCALE: 1" = 30'

132-23

127-03

132-58

SOUTHWOOD BOULEVARD

INCLINE WAY

127-480-00
73370 sf

COMMON AREA

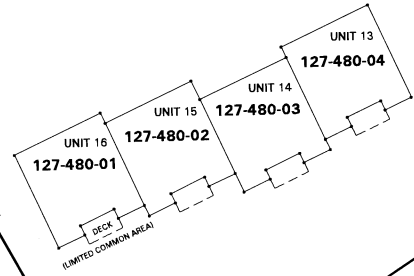
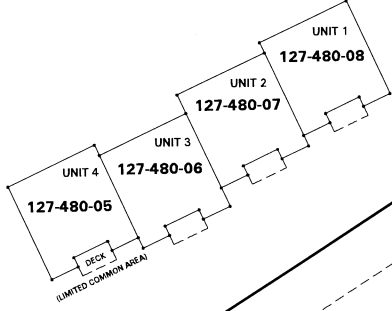

127-07

127-02

127-46

FIRST FLOOR



1" = 50'

NOTE: This map is prepared for the use of the Washoe County Assessor for assessment and illustrative purposes only. It does not represent a survey of the premises. No liability is assumed as to the sufficiency or the accuracy of the data delineated hereon.

Office of Washoe County Assessor, Nevada - Joshua G. Wilson

This area previously shown on _____

NOTE: Areas of parcels which are less than 2 acres are shown in square feet.

Drawn by	TWT	01/28/08
Revised		