

**(#5206)**  
**FOUNTAINHOUSE AT VICTORIAN SQUARE**  
**PHASE 2**  
 A CONDOMINIUM SUBDIVISION

POR. OF SE ¼ SECTION 5, T19N - R20E

*SECOND FLOOR LIVING UNITS*

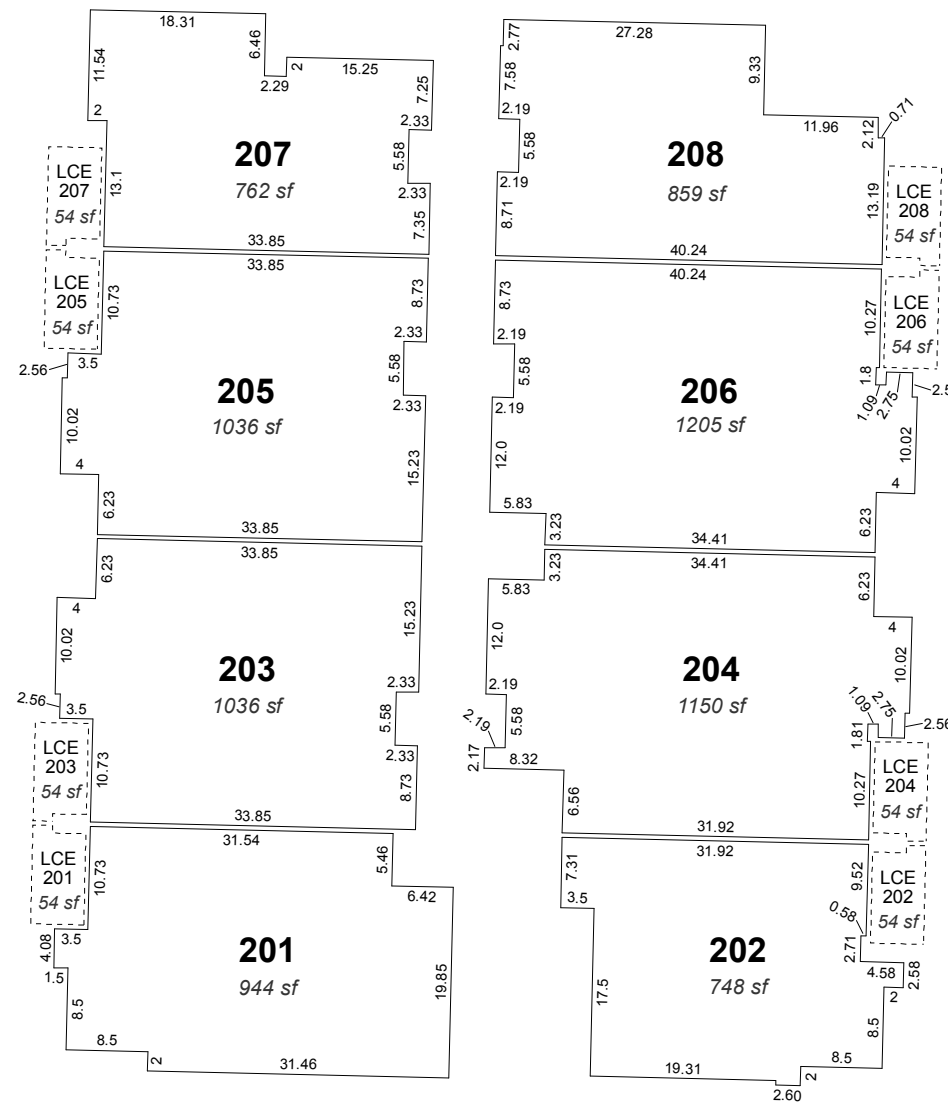

**204** = UNIT NUMBER

LCE 204 = LCE Attached to Unit 204

LCE = LIMITED COMMON ELEMENT

All dimensions are to front face of stud.

The boundaries of each unit include all internal living space. The lotted areas include a portion of the garage area (First Floor) and the LCE and living area as shown.

Assessor's Map Number

**032-37**

STATE OF NEVADA  
**WASHOE COUNTY**  
 ASSESSOR'S OFFICE  
 Michael E. Clark, Assessor

1001 East Ninth Street  
 Building D  
 Reno, Nevada 89512  
 (775) 328-2231

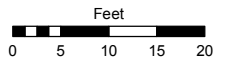

1 inch = 20 feet



created by: KSB 6/26/2017

last updated: \_\_\_\_\_

area previously shown on map(s)  
 \_\_\_\_\_

NOTE: This map was prepared for the use of the Washoe County Assessor for assessment and illustrative purposes only. It does not represent a survey of the premises. No liability is assumed as to the sufficiency or accuracy of the data delineated hereon.