

STATE OF NEVADA  
**WASHOE COUNTY**  
**ASSESSOR'S OFFICE**  
Joshua G. Wilson, Assessor

1001 East Ninth Street  
Building D  
Reno, Nevada 89512  
(775) 328-2231

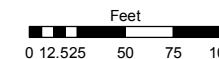

1 inch = 100 feet

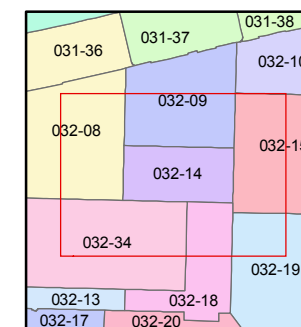
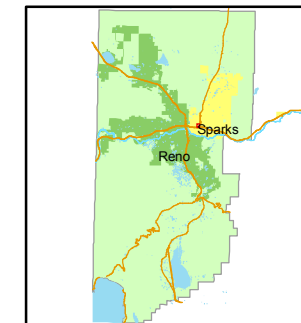

created by: NLH 5/13/2010

last updated: \_\_\_\_\_

area previously shown on map(s)  
\_\_\_\_\_

NOTE: This map was prepared for the use of the Washoe County Assessor for assessment and illustrative purposes only. It does not represent a survey of the premises. No liability is assumed as to the sufficiency or accuracy of the data delineated hereon.

**(#106)**  
**ROBISON'S ADDITION**  
A POR. OF THE SE 1/4 OF SEC. 5,  
T19N - R20E

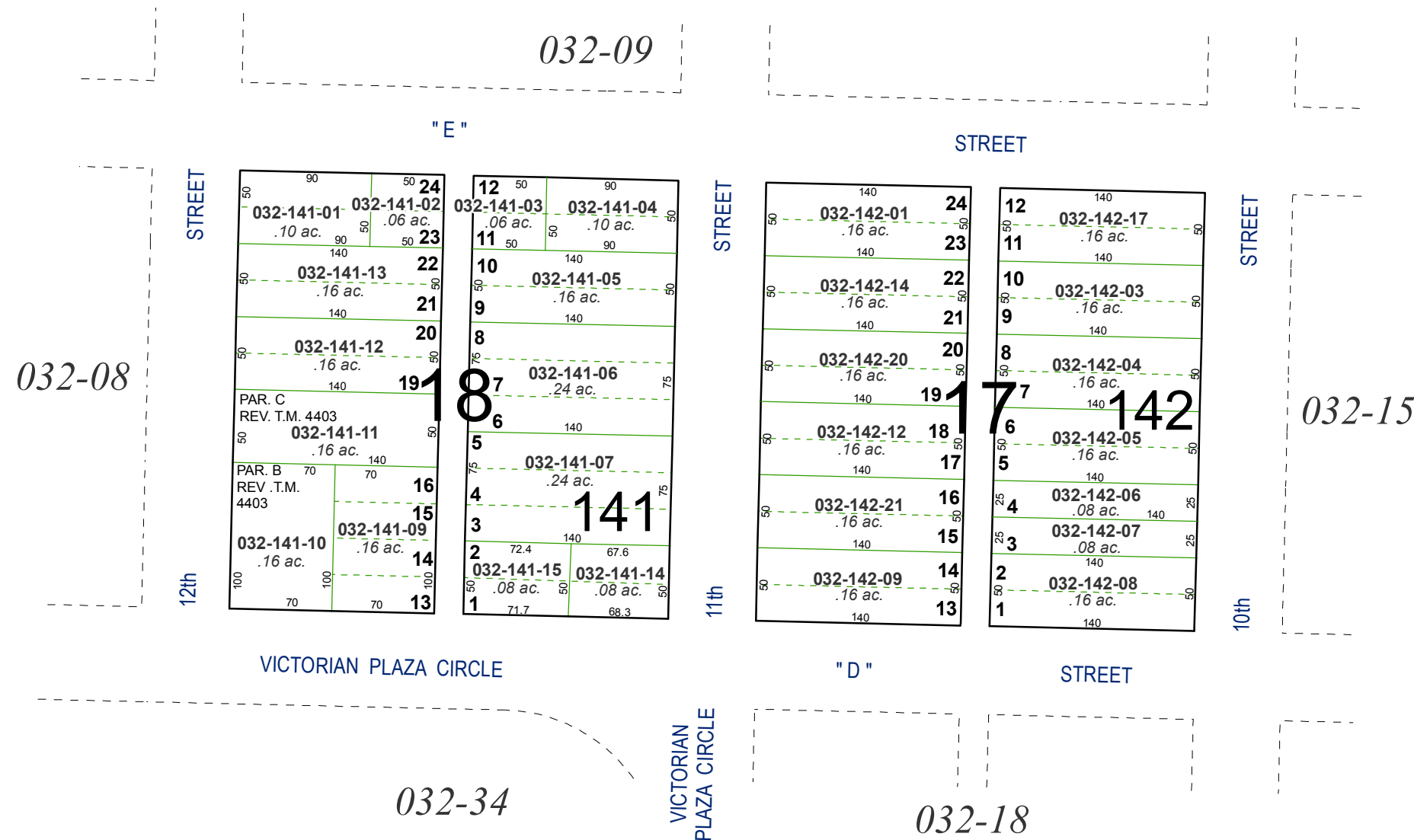

24 032-141-01 .10 ac.	23 032-141-02 .06 ac.	12 032-141-03 .06 ac.	9 032-141-04 .10 ac.
22 032-141-13 .16 ac.	21 032-141-12 .16 ac.	10 032-141-05 .16 ac.	8 032-141-06 .24 ac.
19 032-141-11 .16 ac.	18 032-141-10 .16 ac.	7 032-141-07 .24 ac.	6 032-141-15 .08 ac.
16 032-141-10 .16 ac.	15 032-141-09 .16 ac.	5 032-141-14 .08 ac.	4 032-141-14 .08 ac.
14 032-141-10 .16 ac.	13 032-141-09 .16 ac.	3 032-141-15 .08 ac.	2 032-141-14 .08 ac.
13	14	1	1

24 032-142-01 .16 ac.	23 032-142-17 .16 ac.	12 032-142-17 .16 ac.	11 032-142-17 .16 ac.
22 032-142-14 .16 ac.	21 032-142-14 .16 ac.	10 032-142-03 .16 ac.	9 032-142-03 .16 ac.
20 032-142-20 .16 ac.	19 032-142-20 .16 ac.	8 032-142-04 .16 ac.	7 032-142-04 .16 ac.
18 032-142-12 .16 ac.	17 032-142-12 .16 ac.	6 032-142-05 .16 ac.	5 032-142-05 .16 ac.
16 032-142-21 .16 ac.	15 032-142-21 .16 ac.	4 032-142-06 .08 ac.	3 032-142-07 .08 ac.
14 032-142-09 .16 ac.	13 032-142-09 .16 ac.	2 032-142-08 .16 ac.	1 032-142-08 .16 ac.

032-34

032-18

032-08

032-09

032-15