

T19N - R19E

STATE OF NEVADA
WASHOE COUNTY
ASSESSOR'S OFFICE
Michael E. Clark, Assessor

1001 East Ninth Street
Building D
Reno, Nevada 89512
(775) 328-2231

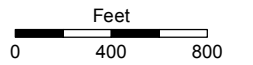

1 inch = 800 feet

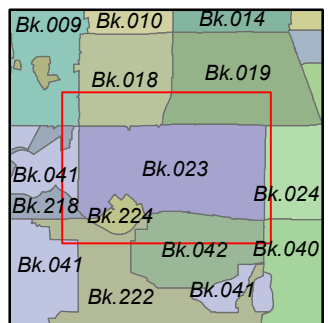
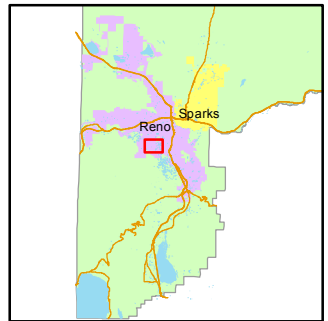

created by: CFB 02/10/2015

last updated: KSB 7/01/16

NOTE: This map was prepared for the use of the Washoe County Assessor for assessment and illustrative purposes only. It does not represent a survey of the premises. No liability is assumed as to the sufficiency or accuracy of the data delineated hereon.

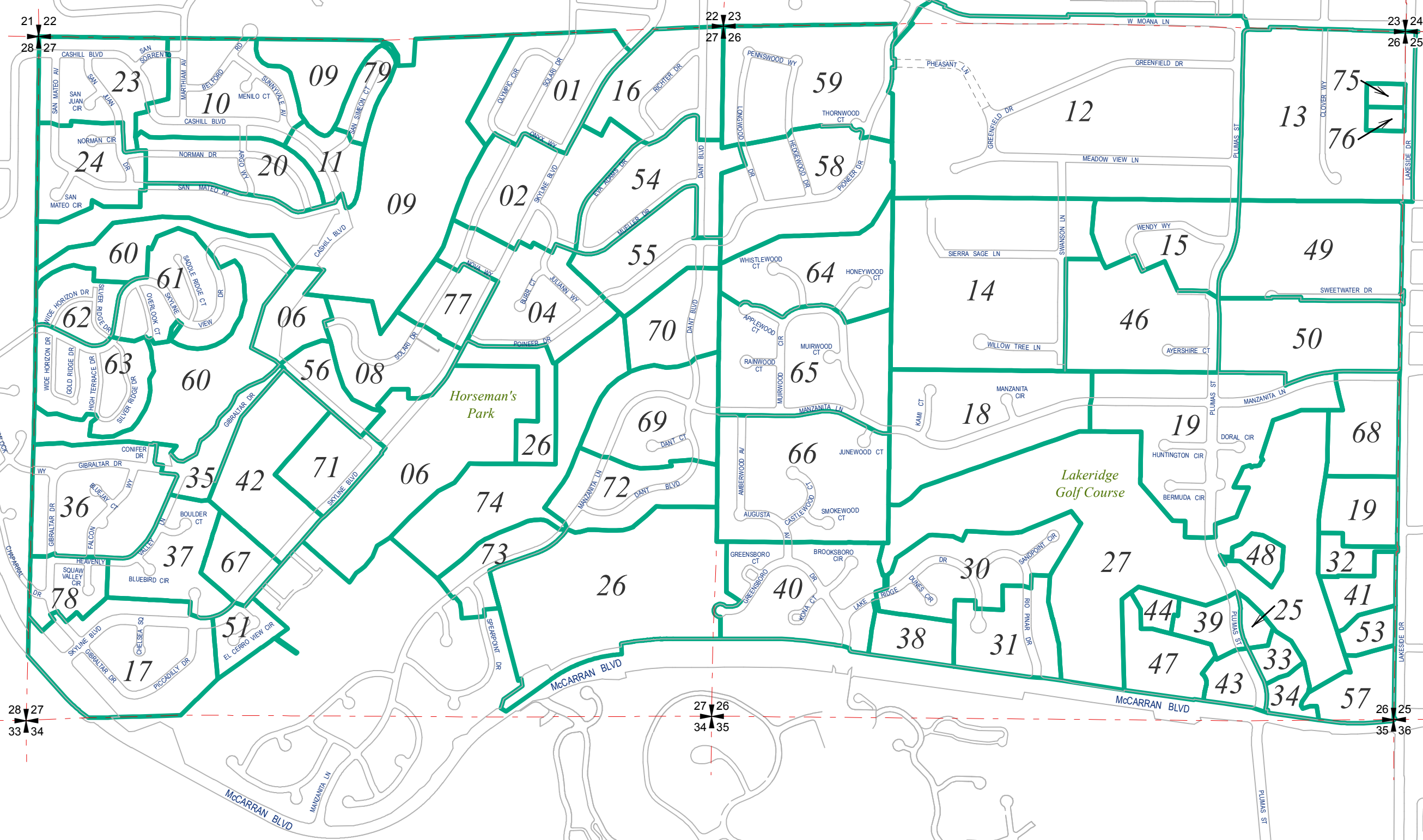

21 22 22 23 23 24
28 27 27 26 26 25

28 27 27 26 26 25
33 34 34 35 35 36