

Assessor's Map Number

014-29

STATE OF NEVADA
WASHOE COUNTY
ASSESSOR'S OFFICE
Joshua G. Wilson, Assessor

1001 East Ninth Street
Building D
Reno, Nevada 89512
(775) 328-2231

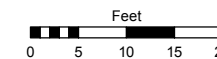

1 inch = 20 feet

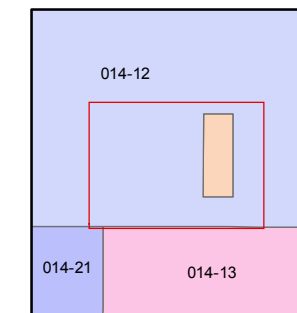
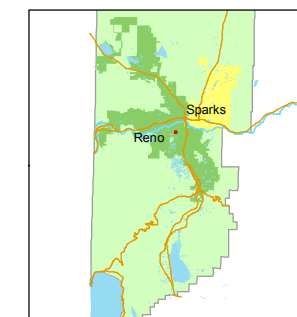

created by: TWT 2/28/2014

last updated: _____

area previously shown on map(s)

014-12

NOTE: This map was prepared for the use of the Washoe County Assessor for assessment and illustrative purposes only. It does not represent a survey of the premises. No liability is assumed as to the sufficiency or accuracy of the data delineated hereon.

ALLEY

COMMON AREA

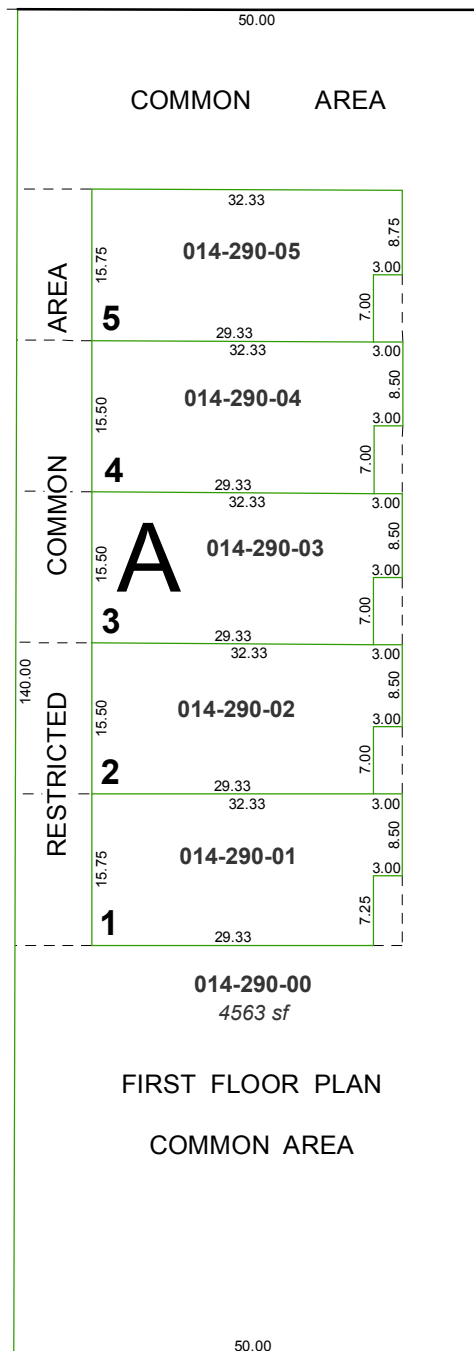

014-290-00
4563 sf

FIRST FLOOR PLAN
COMMON AREA

(#2327) PUEBLO PLACE

A CONDOMINIUM SUBDIVISION
PORTION OF THE SW 1/4 OF SECTION 13
T19N - R19E

TO EACH AN UNDIVIDED 1/5 TH
INTEREST IN THE COMMON AREA

HASKELL STREET

HASKELL STREET

WEST

PUEBLO

STREET