

STATE OF NEVADA  
**WASHOE COUNTY**  
**ASSESSOR'S OFFICE**  
Michael E. Clark, Assessor  
1001 East Ninth Street  
Building D  
Reno, Nevada 89512  
(775) 328-2231

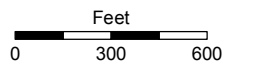

1 inch = 600 feet

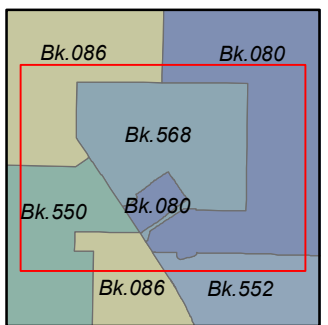
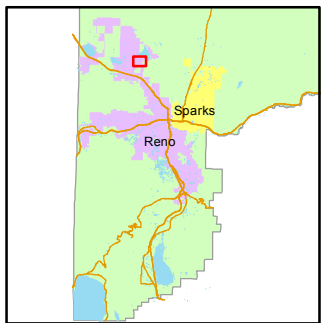

created by: NLH 02/21/2012  
last updated: NLH 6/25/12 EMG 6/22/16

**T21N - R19E**

**T20N - R19E**

*SEE INDEX  
PAGE 01*

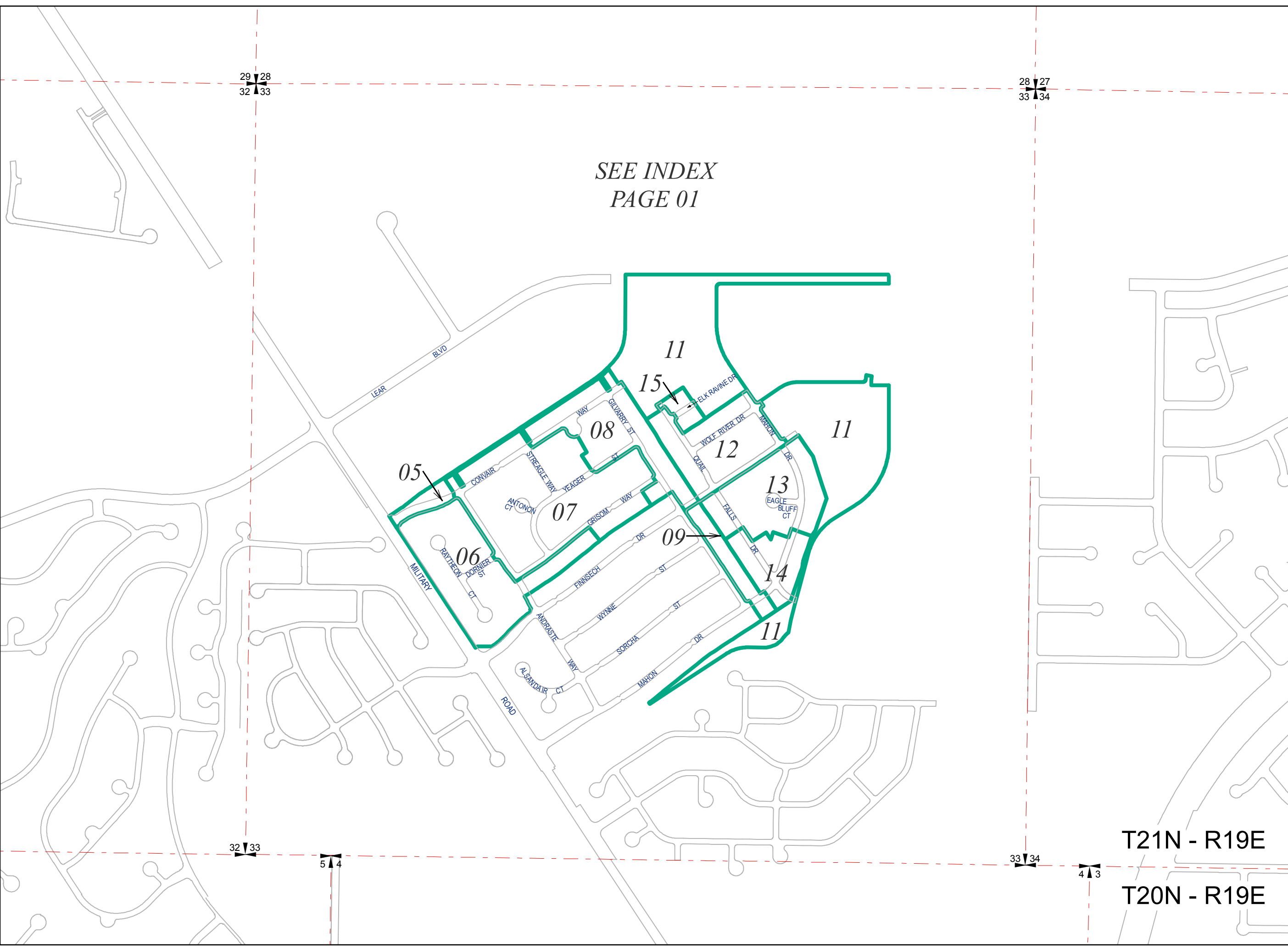

29 28  
32 33

28 27  
33 34

32 33

5 4

33 34

4 3

NOTE: This map was prepared for the use of the Washoe County Assessor for assessment and illustrative purposes only. It does not represent a survey of the premises. No liability is assumed as to the sufficiency or accuracy of the data delineated herein.