

EVERGREEN UNIT TWO (#3192)
 A PLANNED UNIT DEVELOPMENT AT CAUGHLIN RANCH
 (FORMERLY JUNIPER TRAILS UNIT 8)
 POR. NE ¼ SEC. 29, T19N - R19E

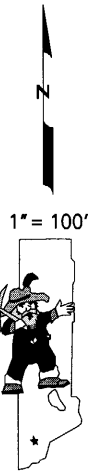
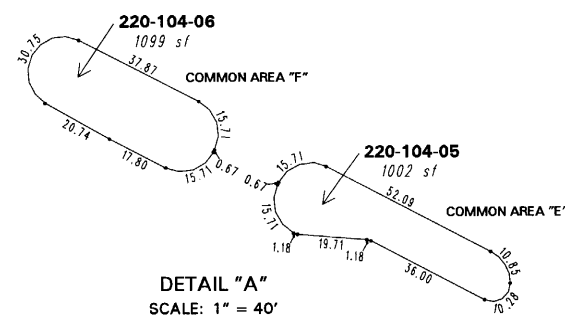

NOTE: This map is prepared for the use of the Washoe County Assessor for assessment and illustrative purposes only. It does not represent a survey of the premises. No liability is assumed as to the sufficiency or the accuracy of the data delineated hereon.

220-11
 Office of Washoe County Assessor, Nevada - Robert W. McGowan

This area previously shown on 220-08

NOTE: Areas of parcels which are less than 2 acres are shown in square feet.

Drawn by GZ 11/06/95
 Revised KSB 5/03/05