

HIGHLAND PLACE ACTIVE SENIOR CONDOMINIUMS A CONDOMINIUM SUBDIVISION

POR. OF THE SW 1/4 OF SEC. 5
T19N - R19E

NO ACTIVE PARCELS SEE BOOK 204, PAGE 56 9/8/06

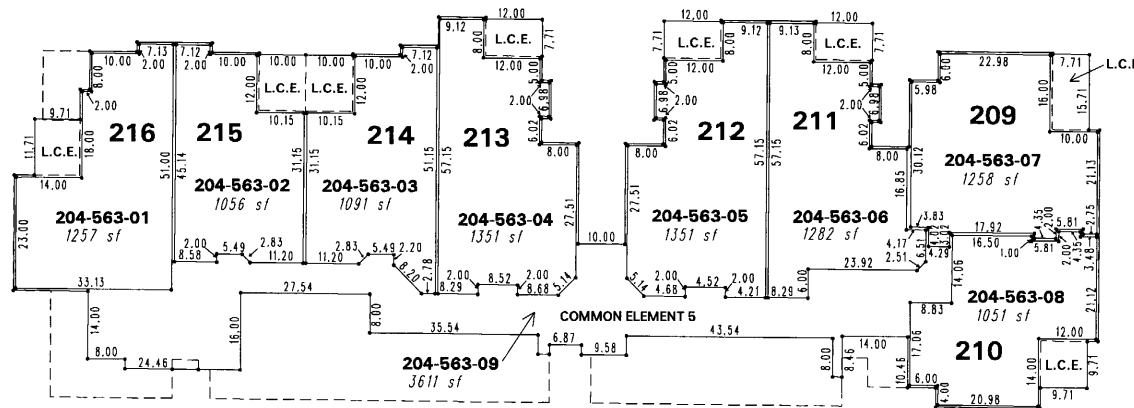

SECOND FLOOR AREA TOTALS

TOTAL LOT AREA	20432 SQ.FT.
COMMON ELEMENT	6076 SQ.FT.
LIMITED COMMON ELEMENT	1870 SQ.FT.
TOTAL COMMON ELEMENT AREA	7946 SQ.FT.

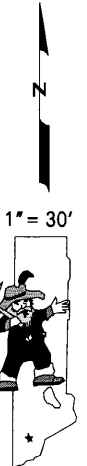

NOTE: This map is prepared for the use of the Washoe County Assessor for assessment and illustrative purposes only. It does not represent a survey of the premises. No liability is assumed as to the sufficiency or the accuracy of the data delineated hereon.

Office of Washoe County Assessor, Nevada - Robert W. McGowan

This area previously shown on 204-02

NOTE: Areas of parcels which are less than 2 acres are shown in square feet.

Drawn by	HCS 9/25/01
Revised	PK 9/8/06