

W. SEVENTH ST

# HIGHLAND PLACE ACTIVE SENIOR CONDOMINIUMS A CONDOMINIUM SUBDIVISION

POR. OF THE SW 1/4 OF SEC. 5  
T19N - R19E

ROBB DRIVE

# NO ACTIVE PARCELS SEE BOOK 204, PAGE 56 562 9/8/06

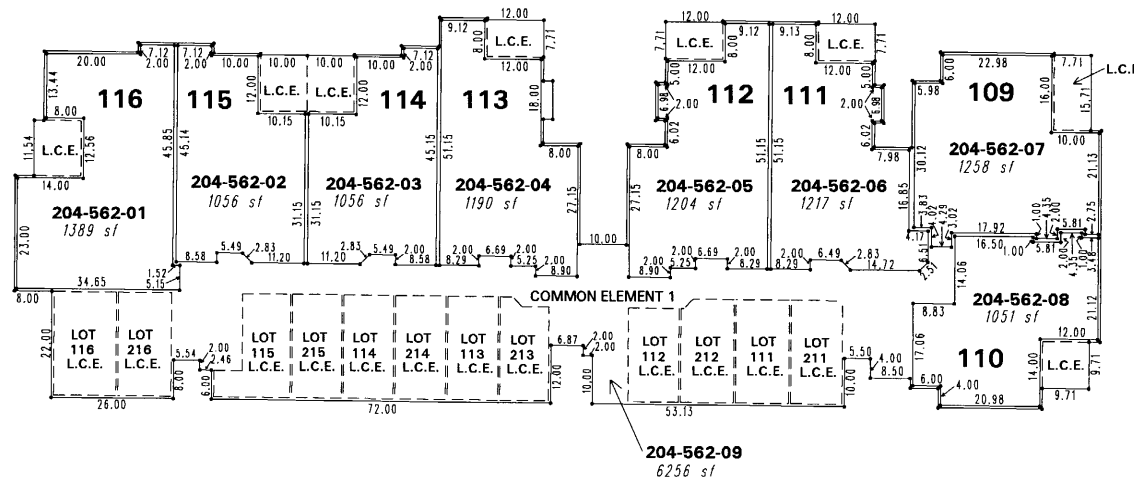

## FIRST FLOOR AREA TOTALS

TOTAL LOT AREA	20071 SQ.FT.
COMMON ELEMENT	7644 SQ.FT.
LIMITED COMMON ELEMENT	5690 SQ.FT.
TOTAL COMMON ELEMENT AREA	13334 SQ.FT.

NOTE: This map is prepared for the use of the Washoe County Assessor for assessment and illustrative purposes only. It does not represent a survey of the premises. No liability is assumed as to the sufficiency or the accuracy of the data delineated hereon.

Office of Washoe County Assessor, Nevada - Robert W. McGowan

This area previously shown on 204-20

NOTE: Areas of parcels which are less than 2 acres are shown in square feet.

Drawn by	HCS 9/25/01
Revised/PK	9/8/06