

3/4/2004 - THIS IS THE MOST RECENT MAP - PLEASE DISCARD ALL OTHERS

(#4142)

FLEUR DE LIS - PHASE 1

A MERGER AND RESUBDIVISION OF DOUBLE DIAMOND RANCH VILLAGE 26, TRACT MAP #4010

PLANNED UNIT DEVELOPMENT
A COMMON-INTEREST COMMUNITY

PORTION OF SECTION 9
T18N - R20E

161-11

161-08

WILBUR MAY PARKWAY

FLEUR DE LIS WAY (PRIVATE)

FLEUR DE LIS WAY (PRIVATE)

082

161-08-S6
161-08-S7

1" = 50'

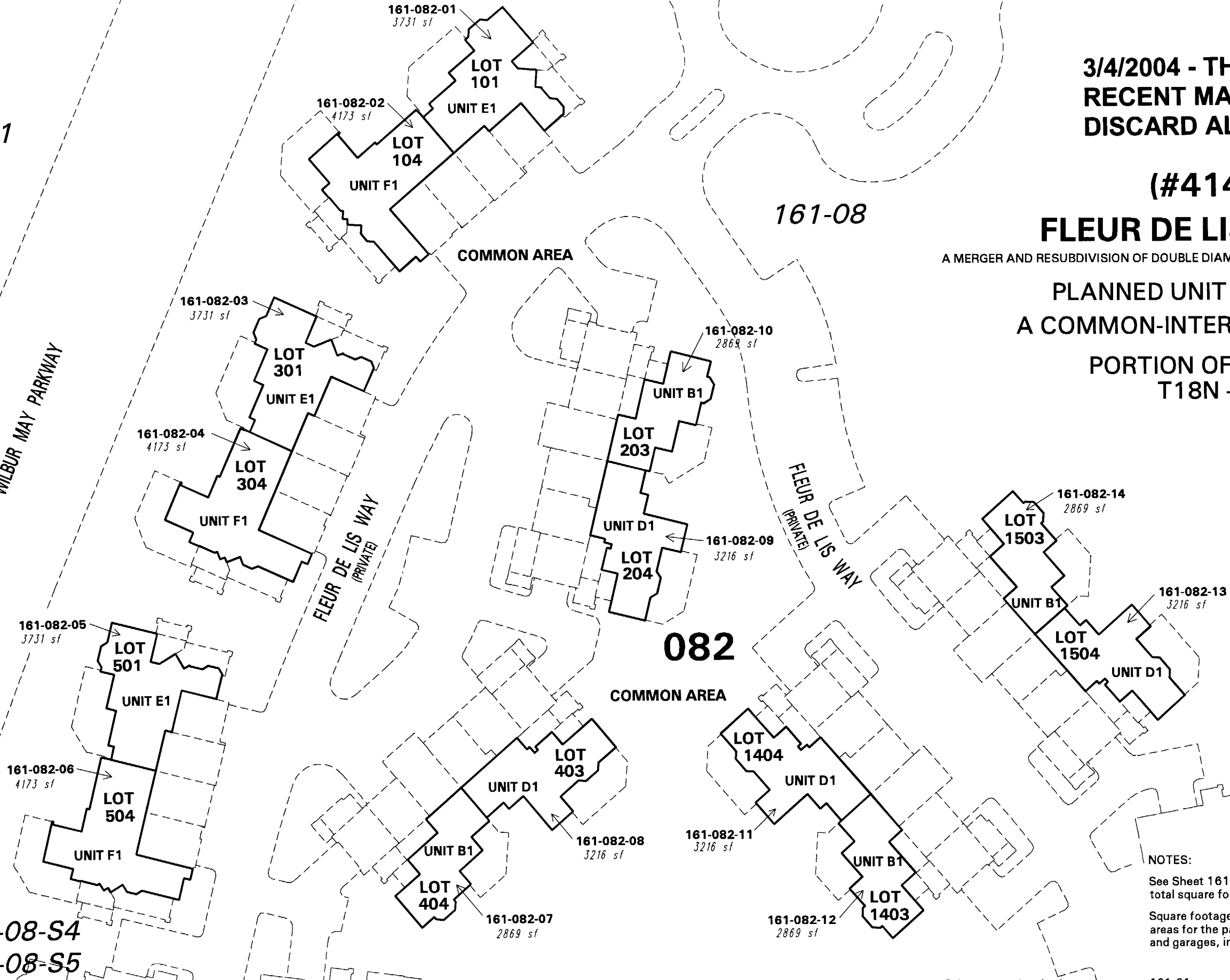

161-08-S4
161-08-S5

FIRST FLOOR UNITS

Office of Washoe County Assessor, Nevada - Robert W. McGowan

NOTES:

See Sheet 16108 for parcel dimensions and total square footage details

Square footage of each unit includes the areas for the patio, balcony, foyer, courtyard and garages, in addition to that of the living area

This area previously shown on 161-01

NOTE: Areas of parcels which are less than 2 acres are shown in square feet.

Drawn by	HCS 11/06/01
Revised	HCS 11/13/01 HCS 11/26/02
	CFB 2/26/2003 HCS 5/15/03; 7/10/03

NOTE: This map is prepared for the use of the Washoe County Assessor for assessment and illustrative purposes only. It does not represent a survey of the premises. No liability is assumed as to the sufficiency or the accuracy of the data delineated hereon.