

ESPLANADE AT DAMONTE RANCH VILLAGE 24-C UNIT 2 (#5138)

A CONDOMINIUM SUBDIVISION

POR. OF SW ¼ SECTION 15, T18N - R20E

UNIT DETAILS

Assessor's Map Number

141-42-S1

STATE OF NEVADA

**WASHOE COUNTY
ASSESSOR'S OFFICE**

Michael E. Clark, Assessor

1001 East Ninth Street
Building D
Reno, Nevada 89512
(775) 328-2231

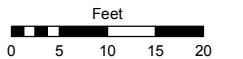

1 inch = 20 feet



created by: KSB 11/17/2015

last updated: _____

area previously shown on map(s)

NOTE: This map was prepared for the use of the Washoe County Assessor for assessment and illustrative purposes only. It does not represent a survey of the premises. No liability is assumed as to the sufficiency or accuracy of the data delineated hereon.

**BUILDING TYPE A
FIRST FLOOR**

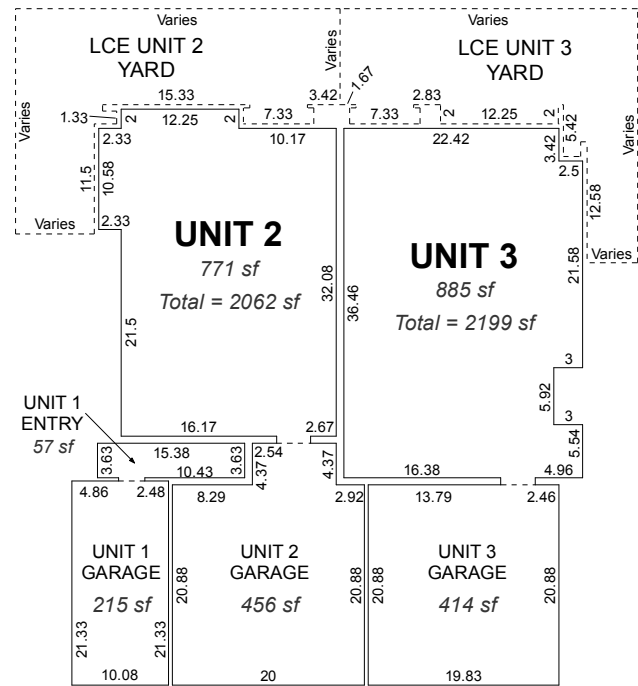

**BUILDING TYPE B
FIRST FLOOR**

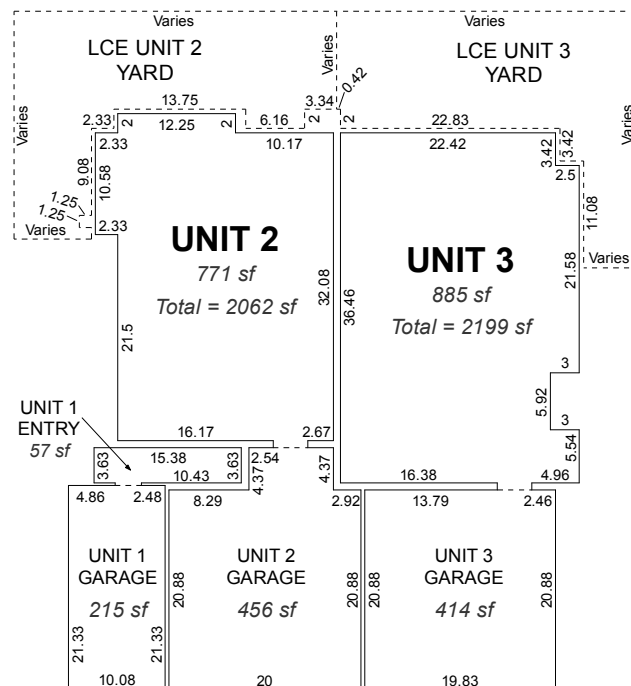

**BUILDING TYPE C
FIRST FLOOR**

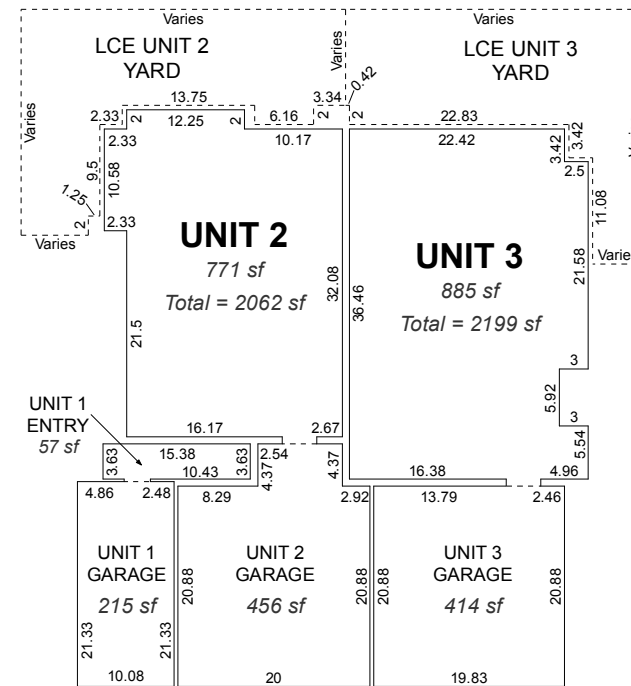

SECOND FLOOR

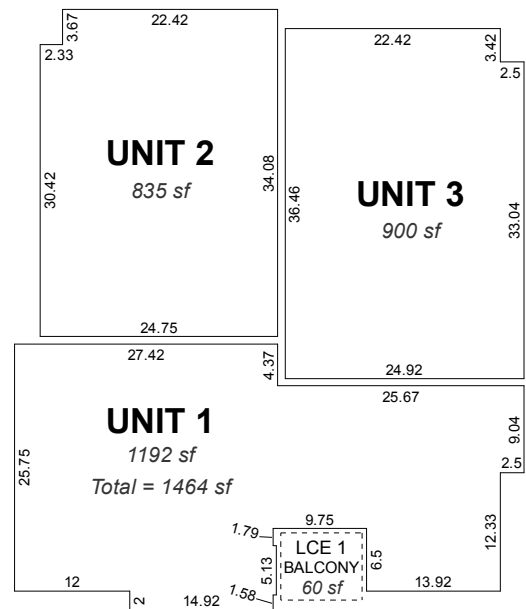

SECOND FLOOR

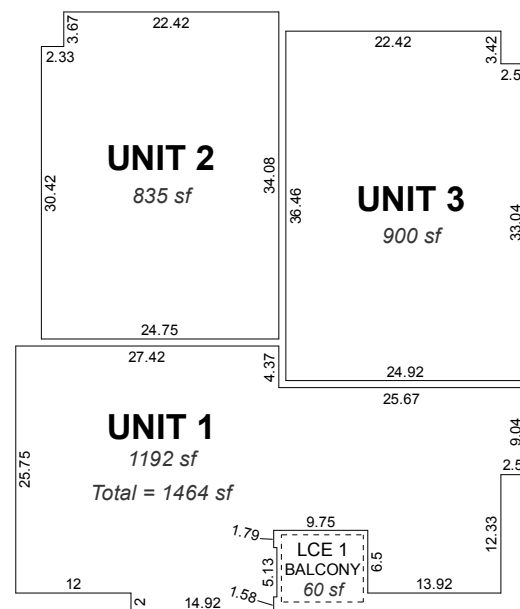

SECOND FLOOR

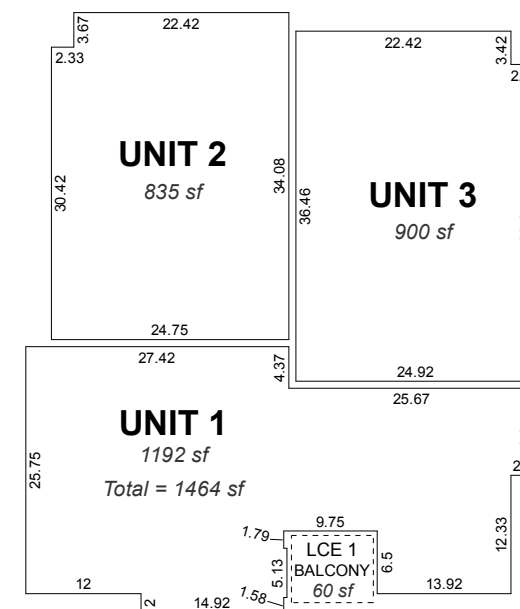

NOTES:

LCE = LIMITED COMMON ELEMENT

Areas for LCE Yards vary (Units 2 & 3). Areas are shown with each specific unit.

Total square footage of each unit includes garage area.