

132-45 132-53

132-32

CONDOMINIUM PARCEL MAP NO. 3263

LOT 25, SOUTHWOOD SUBDIVISION NO. 1
POR. SE 1/4 SEC. 16, T16N - R18E
TO EACH AN UNDIVIDED 1/2 INTEREST IN COMMON AREA

132-33

132-21

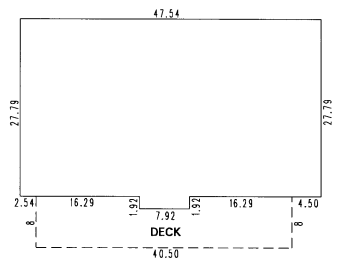

SECOND FLOOR - UNIT 2

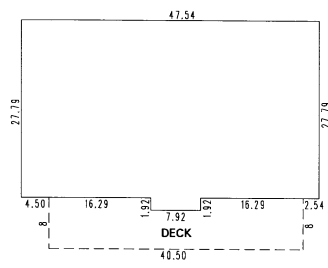

SECOND FLOOR - UNIT 1

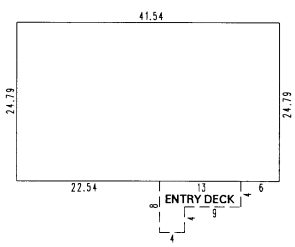

FIRST FLOOR - UNIT 2

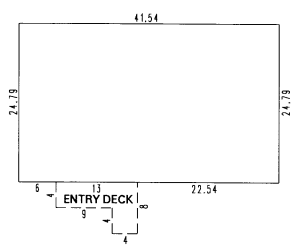

FIRST FLOOR - UNIT 1

ROBIN DRIVE

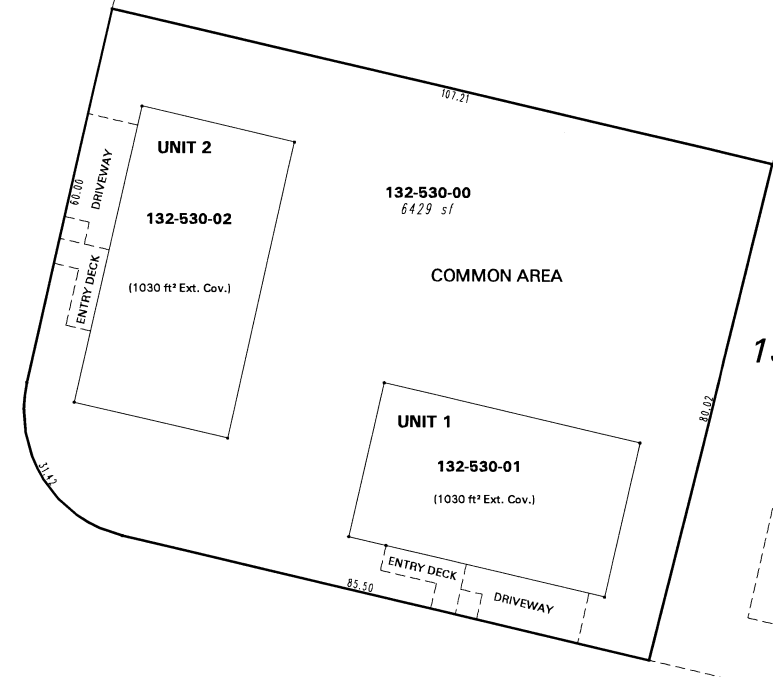

132-35

132-44

SOUTHWOOD BOULEVARD



1" = 20'



NOTE: This map is prepared for the use of the Washoe County Assessor for assessment and illustrative purposes only. It does not represent a survey of the premises. No liability is assumed as to the sufficiency or the accuracy of the data delineated herein.

Office of Washoe County Assessor, Nevada - Joshua G. Wilson

BK 127

This area previously shown on 132-21

NOTE: Areas of parcels which are less than 2 acres are shown in square feet.

Drawn by	GZ 10/30/91
Revised	DSR 4/23/98 TWT 2/28/08