

STATE OF NEVADA  
**WASHOE COUNTY**  
ASSESSOR'S OFFICE  
Joshua G. Wilson, Assessor

1001 East Ninth Street  
Building D  
Reno, Nevada 89512  
(775) 328-2231



Feet  
0 125 250 500

1 inch = 500 feet

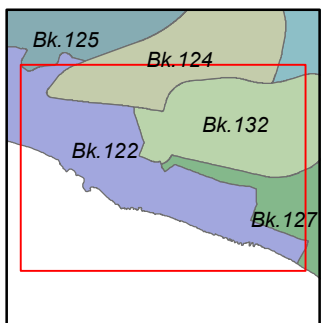
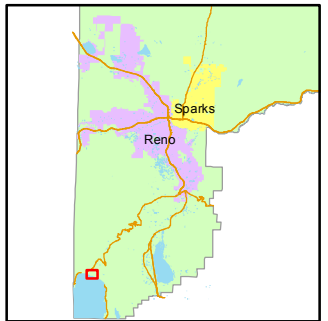

created by: CFB 01/13/2012

last updated: \_\_\_\_\_

NOTE: This map was prepared for the use of the Washoe County Assessor for assessment and illustrative purposes only. It does not represent a survey of the premises. No liability is assumed as to the sufficiency or accuracy of the data delineated herein.

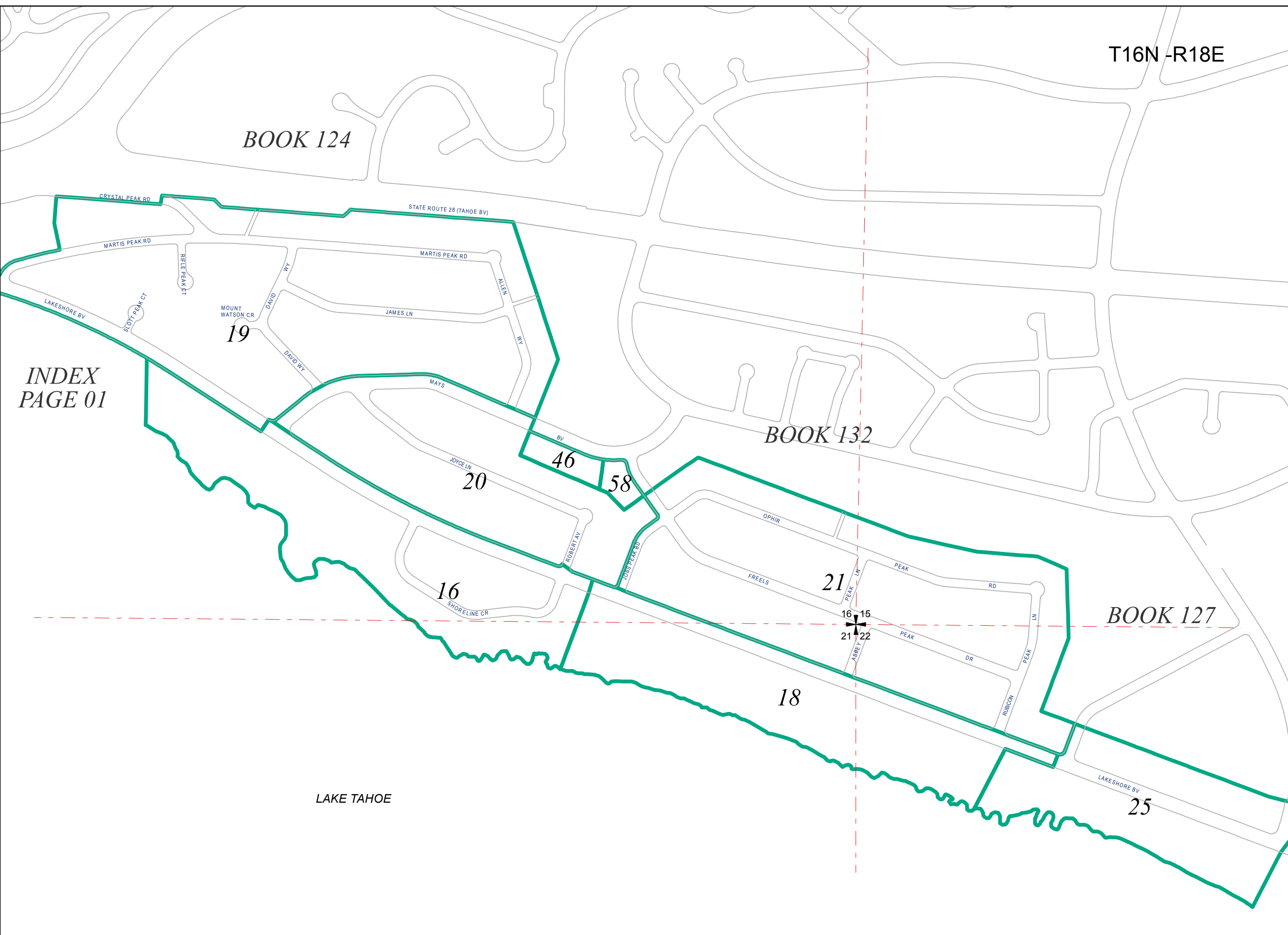

BOOK 124

T16N -R18E

19

BOOK 132

20

46

58

21

BOOK 127

16

15

18

25

LAKE TAHOE

INDEX  
PAGE 01