

STATE OF NEVADA  
**WASHOE COUNTY**  
 ASSESSOR'S OFFICE  
 Joshua G. Wilson, Assessor

1001 East Ninth Street  
 Building D  
 Reno, Nevada 89512  
 (775) 328-2231



Feet  
 0 9,000 18,000

1 inch = 15,840 feet

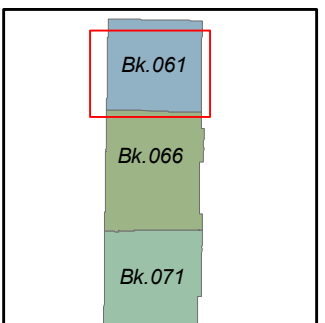
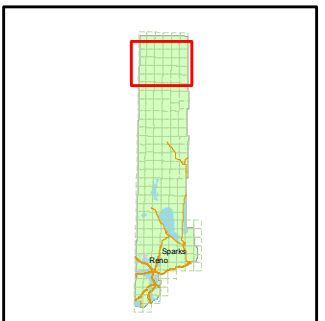

created by: CFB 03/17/2011

last updated: \_\_\_\_\_

NOTE: This map was prepared for the use of the Washoe County Assessor for assessment and illustrative purposes only. It does not represent a survey of the premises. No liability is assumed as to the sufficiency or accuracy of the data delineated herein.

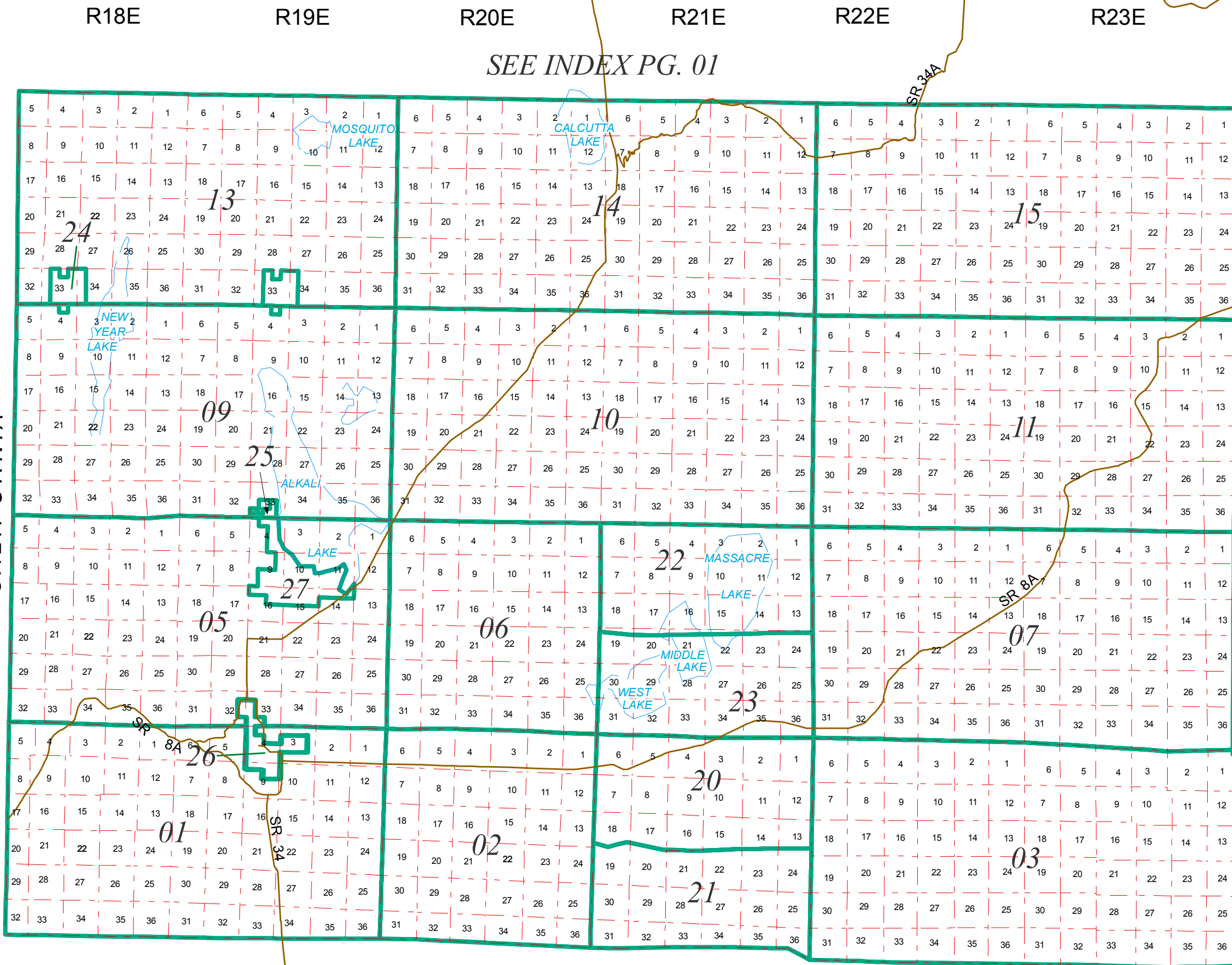

SEE INDEX PG. 01

BOOK 66

T45N

T44N

T43N

T42N

CALIFORNIA

HUMBOLDT COUNTY