

043-01

WEST HUFFAKER LANE

043-31

U.S.
365

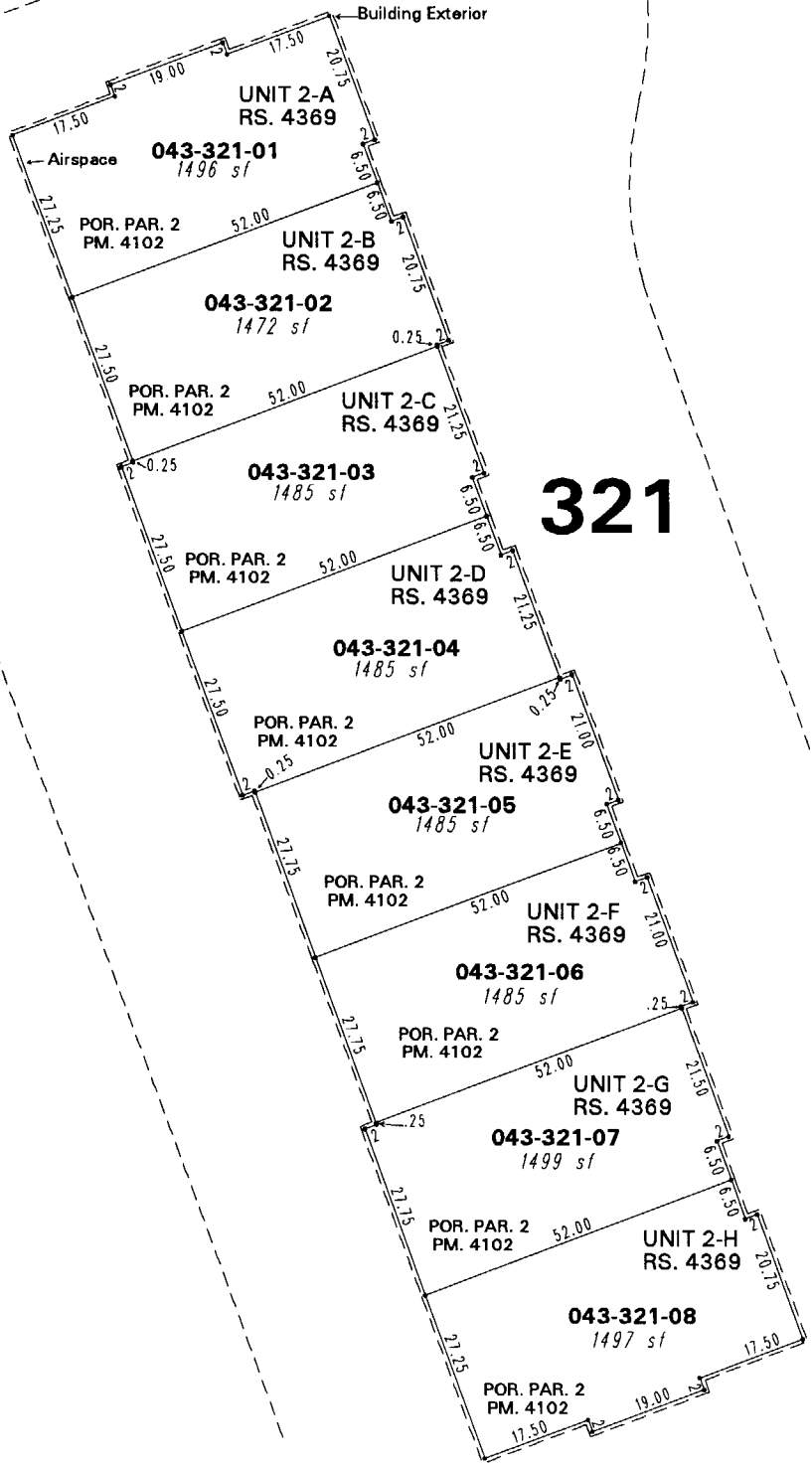

321

PARCEL MAPS 4102, 4103 AND RECORD OF SURVEY 4369
SIERRA PINES PROFESSIONAL PLAZA
 A COMMERCIAL CONDOMINIUM
 PORTION OF SECTION 6
 T18N - R20E

043-32-S4

30' Sanitary Sewer,
Access & PUE

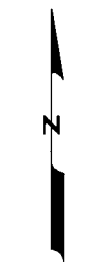

1" = 30'



30' Sanitary Sewer,
Access & PUE

This area previously shown on 43-03

NOTE: This map is prepared for the use of the Washoe County Assessor for assessment and illustrative purposes only. It does not represent a survey of the premises. No liability is assumed as to the sufficiency or the accuracy of the data delineated hereon.

043-32-S2

Office of Washoe County Assessor, Nevada - Robert W. McGowan

NOTE: Areas of parcels which are less than 2 acres are shown in square feet.

Drawn by	<u>PK 05/07/04</u>
Revised	_____