

STATE OF NEVADA
WASHOE COUNTY
ASSESSOR'S OFFICE
Joshua G. Wilson

1001 East Ninth Street
Building D
Reno, Nevada 89512
(775) 328-2231

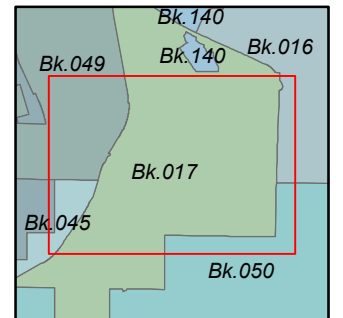

Feet
0 200 400 600 800
1 inch = 800 feet

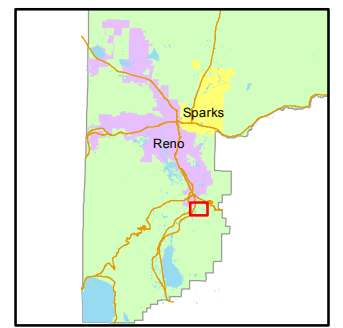

created by: TWT 10/7/2014
last updated: _____

NOTE: This map was prepared for the use of the Washoe County Assessor for assessment and illustrative purposes only. It does not represent a survey of the premises. No liability is assumed as to the sufficiency or accuracy of the data delineated herein.

INDEX PG 02

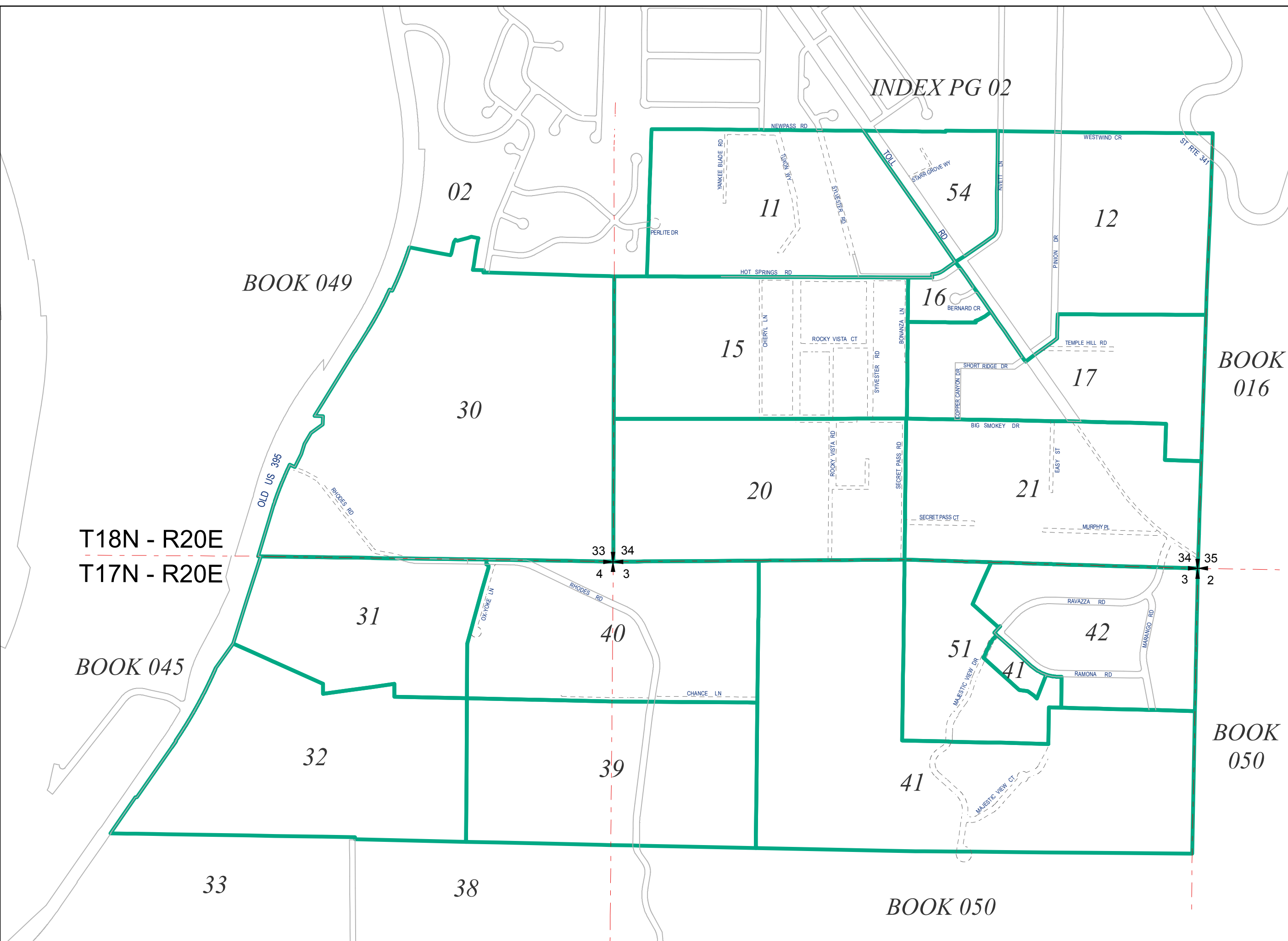

BOOK 049

BOOK 016

T18N - R20E
T17N - R20E

BOOK 045

BOOK 050

BOOK 050