

441

(#3968)
BELLA VISTA CONDOMINIUMS
A CONDOMINIUM SUBDIVISION
A PORTION OF THE NW 1/4 SECTION 11
T19N - R19E

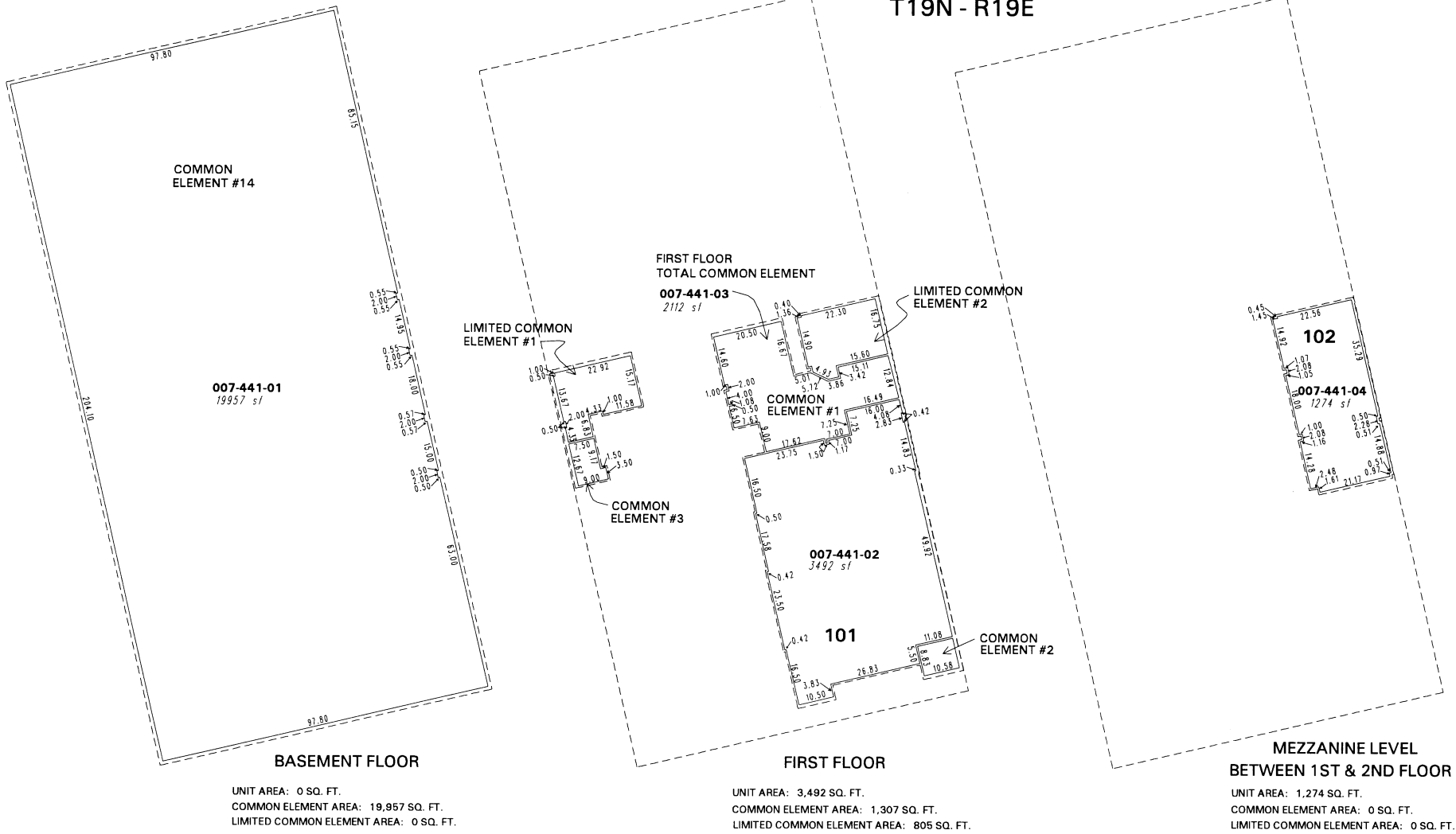

UNIT AREA: 0 SQ. FT.
COMMON ELEMENT AREA: 19,957 SQ. FT.
LIMITED COMMON ELEMENT AREA: 0 SQ. FT.

UNIT AREA: 3,492 SQ. FT.
COMMON ELEMENT AREA: 1,307 SQ. FT.
LIMITED COMMON ELEMENT AREA: 805 SQ. FT.

UNIT AREA: 1,274 SQ. FT.
COMMON ELEMENT AREA: 0 SQ. FT.
LIMITED COMMON ELEMENT AREA: 0 SQ. FT.

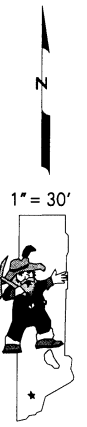

NOTE: This map is prepared for the use of the Washoe County Assessor for assessment and illustrative purposes only. It does not represent a survey of the premises. No liability is assumed as to the sufficiency or the accuracy of the data delineated hereon.

Office of Washoe County Assessor, Nevada - Robert W. McGowan

This area previously shown on 7-27

Drawn by	HCS 7/9/01
Revised	HCS 10/16/01

NOTE: Areas of parcels which are less than 2 acres are shown in square feet.