

STATE OF NEVADA
WASHOE COUNTY
ASSESSOR'S OFFICE
Michael E. Clark, Assessor

1001 East Ninth Street
Building D
Reno, Nevada 89512
(775) 328-2231

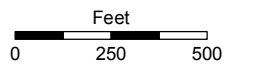

1 inch = 500 feet

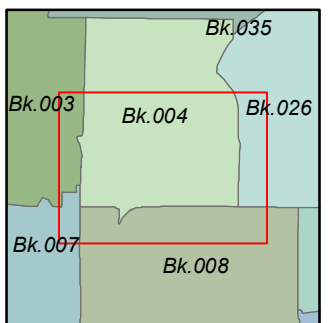
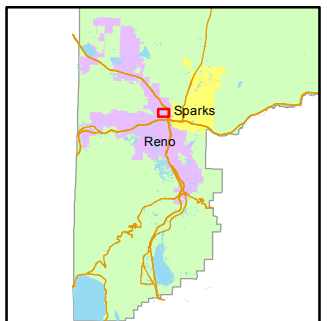

created by: CFB 01/15/2013

last updated: EMG 4/13/16

NOTE: This map was prepared for the use of the Washoe County Assessor for assessment and illustrative purposes only. It does not represent a survey of the premises. No liability is assumed as to the sufficiency or accuracy of the data delineated herein.

SEE INDEX PAGE 02

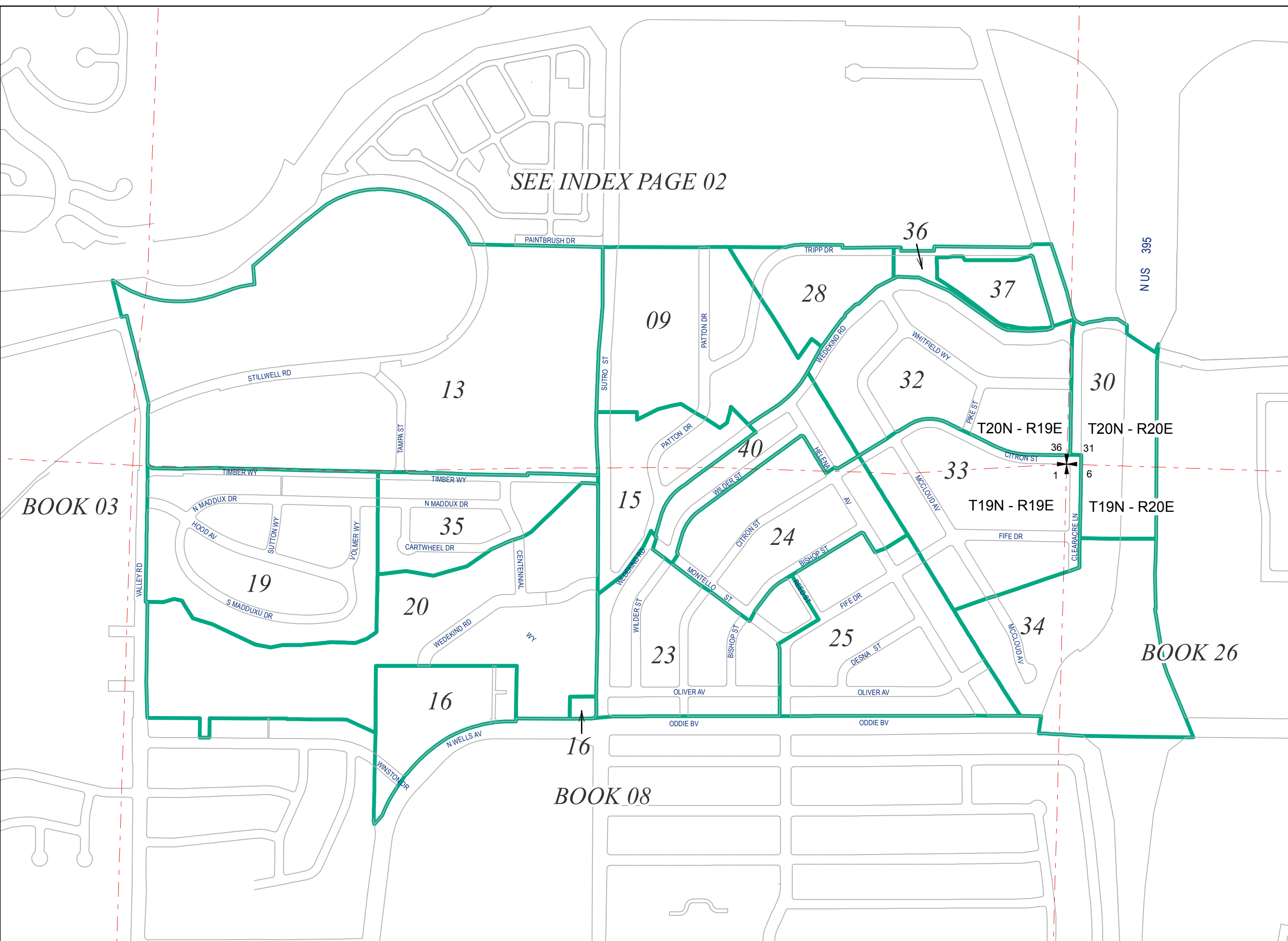

BOOK 03

BOOK 26

BOOK 08