

**(#4545)
PIONEER MEADOWS
VILLAGE III
UNIT 1**
A PLANNED COMMUNITY
PORTION OF NE 1/4 SECTION 11
T20N - R20E

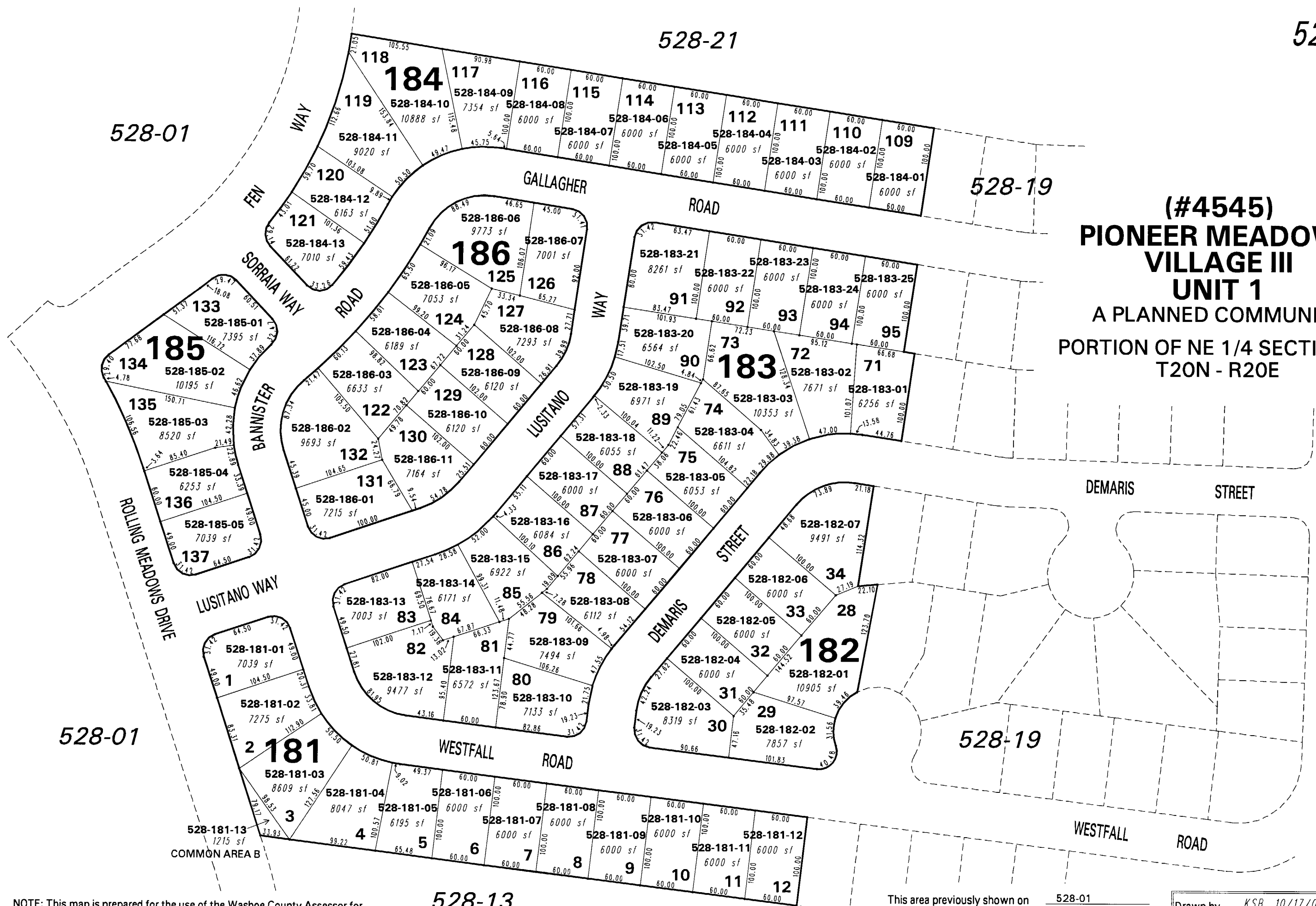

DEMARIS STREET

528-19

WESTFALL ROAD

528-13

Office of Washoe County Assessor, Nevada - Robert W. McGowan

NOTE: This map is prepared for the use of the Washoe County Assessor for assessment and illustrative purposes only. It does not represent a survey of the premises. No liability is assumed as to the sufficiency or the accuracy of the data delineated hereon.

This area previously shown on 528-01

NOTE: Areas of parcels which are less than 2 acres are shown in square feet.

Drawn by KSB 10/17/05
Revised KSB 12/20/05

