

SHARLANDS AVENUE

(#4803) SHARLANDS PLANNING, UNIT 1 VILLA TOSCANA

A COMMON INTEREST COMMUNITY

A POR. OF THE NW 1/4 OF SEC. 18
T19N - R19E

SHARLANDS AVENUE

**REVERTED TO ACREAGE
PER REVERSION TRACT MAP 5069**

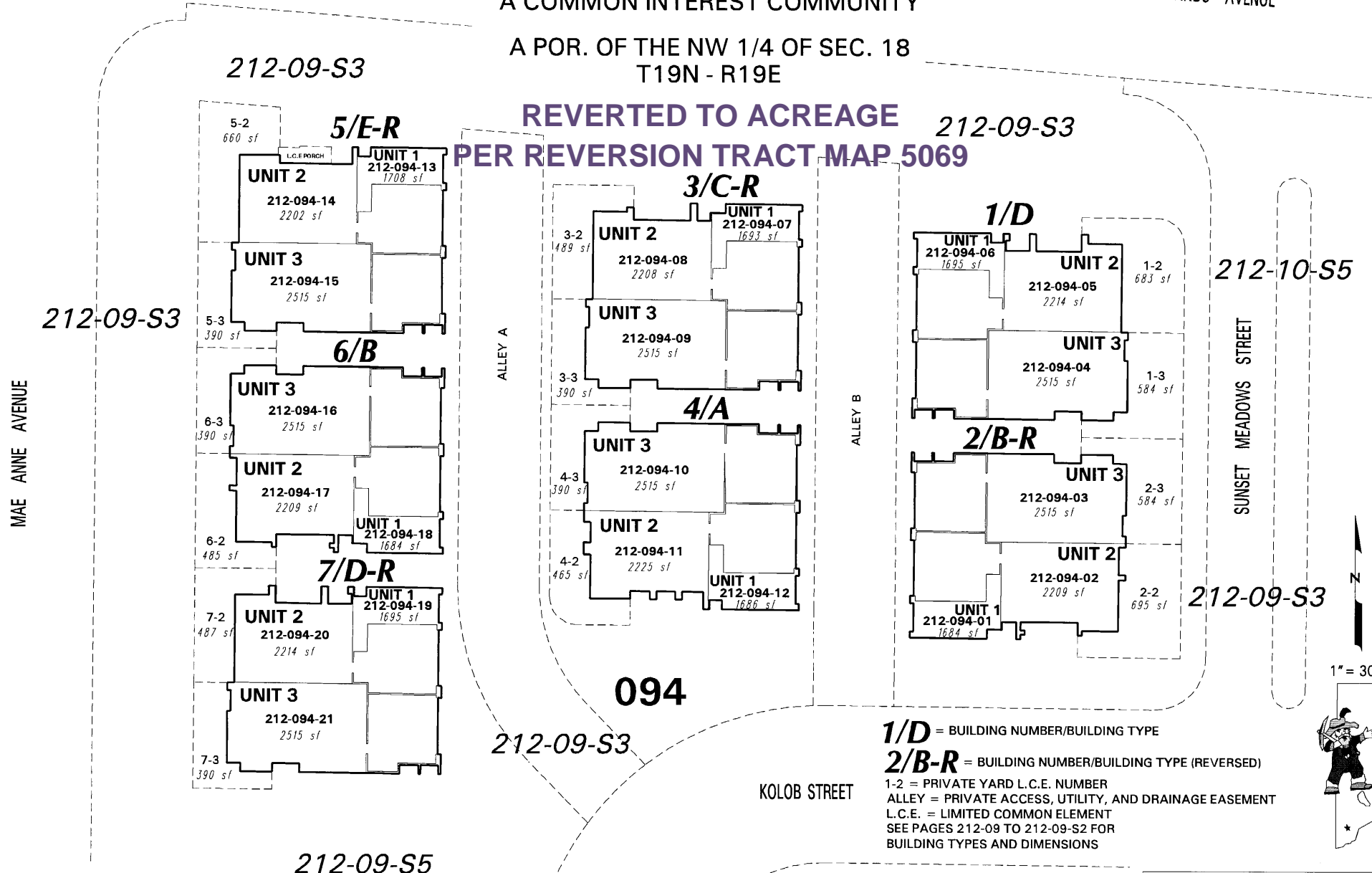

NOTE: This map is prepared for the use of the Washoe County Assessor for assessment and illustrative purposes only. It does not represent a survey of the premises. No liability is assumed as to the sufficiency or the accuracy of the data delineated hereon.

Office of Washoe County Assessor, Nevada - Joshua G. Wilson

This area previously shown on 039-11

NOTE: Areas of parcels which are less than 2 acres are shown in square feet.

Drawn by NLH 07/19/07
 Revised _____