

T18N - R19E  
T18N - R20E

INDEX PAGE 01

INDEX PAGE 03

INDEX PAGE 01

STATE OF NEVADA  
**WASHOE COUNTY**  
ASSESSOR'S OFFICE  
Joshua G. Wilson, Assessor

1001 East Ninth Street  
Building D  
Reno, Nevada 89512  
(775) 328-2231

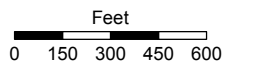

1 inch = 600 feet

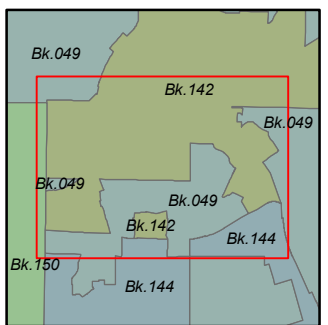

created by: *NLH 09/21/2012*

last updated: \_\_\_\_\_

NOTE: This map was prepared for the use of the Washoe County Assessor for assessment and illustrative purposes only. It does not represent a survey of the premises. No liability is assumed as to the sufficiency or accuracy of the data delineated herein.

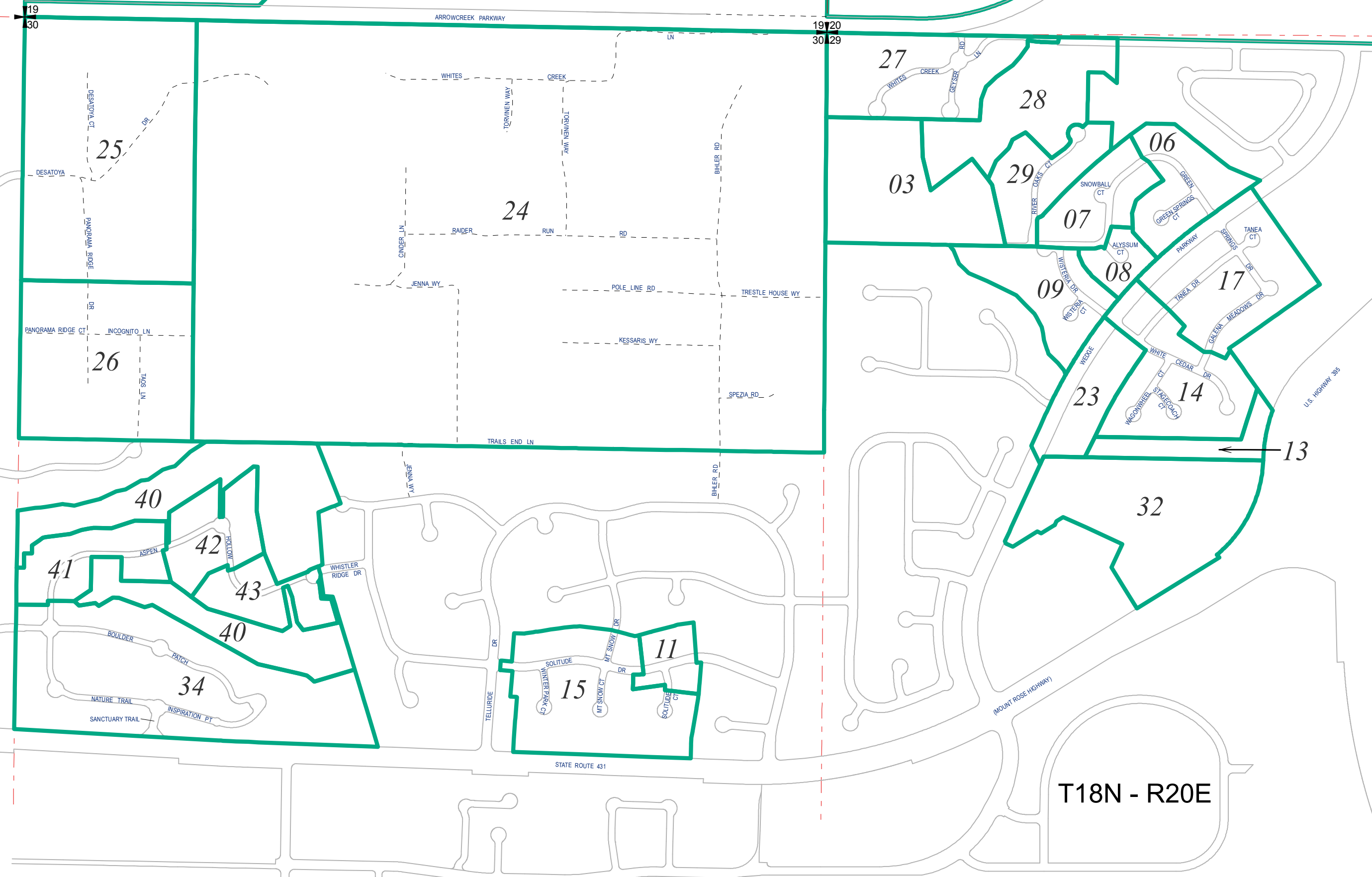

T18N - R20E