

STATE OF NEVADA  
**WASHOE COUNTY**  
**ASSESSOR'S OFFICE**  
 Joshua G. Wilson, Assessor

1001 East Ninth Street  
 Building D  
 Reno, Nevada 89512  
 (775) 328-2231

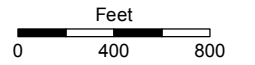

1 inch = 800 feet

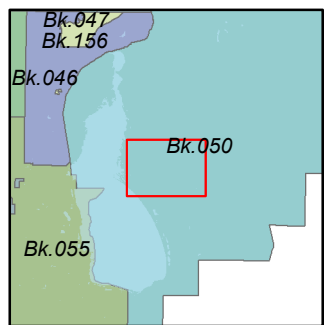
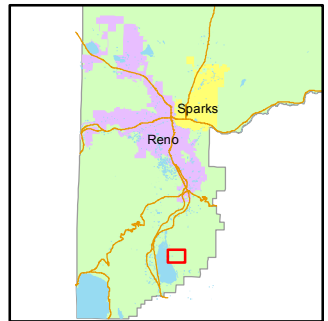

created by: CFB 04/01/2014

last updated: \_\_\_\_\_

NOTE: This map was prepared for the use of the Washoe County Assessor for assessment and illustrative purposes only. It does not represent a survey of the premises. No liability is assumed as to the sufficiency or accuracy of the data delineated hereon.

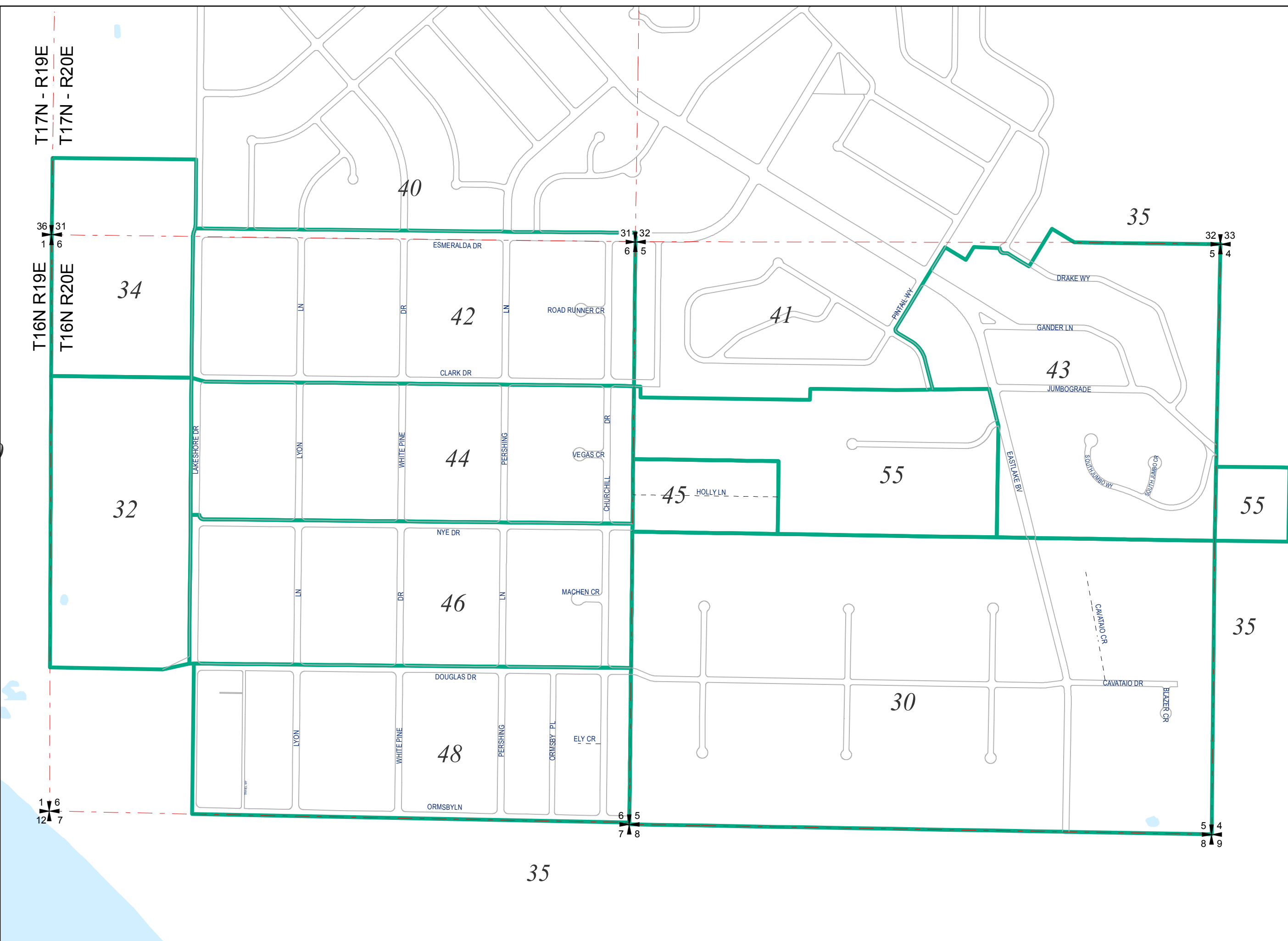

T17N - R19E  
 T17N - R20E

T16N R19E  
 T16N R20E

1 6  
 12 7

6 5  
 7 8

32 33  
 5 4

5 4  
 8 9

35