

(#4816)

CANTABRIA TOWNHOMES

PORTION OF THE SE 1/4 OF SEC. 5
T19N - R19E

039-05

039-49

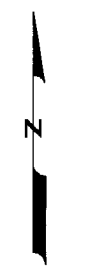
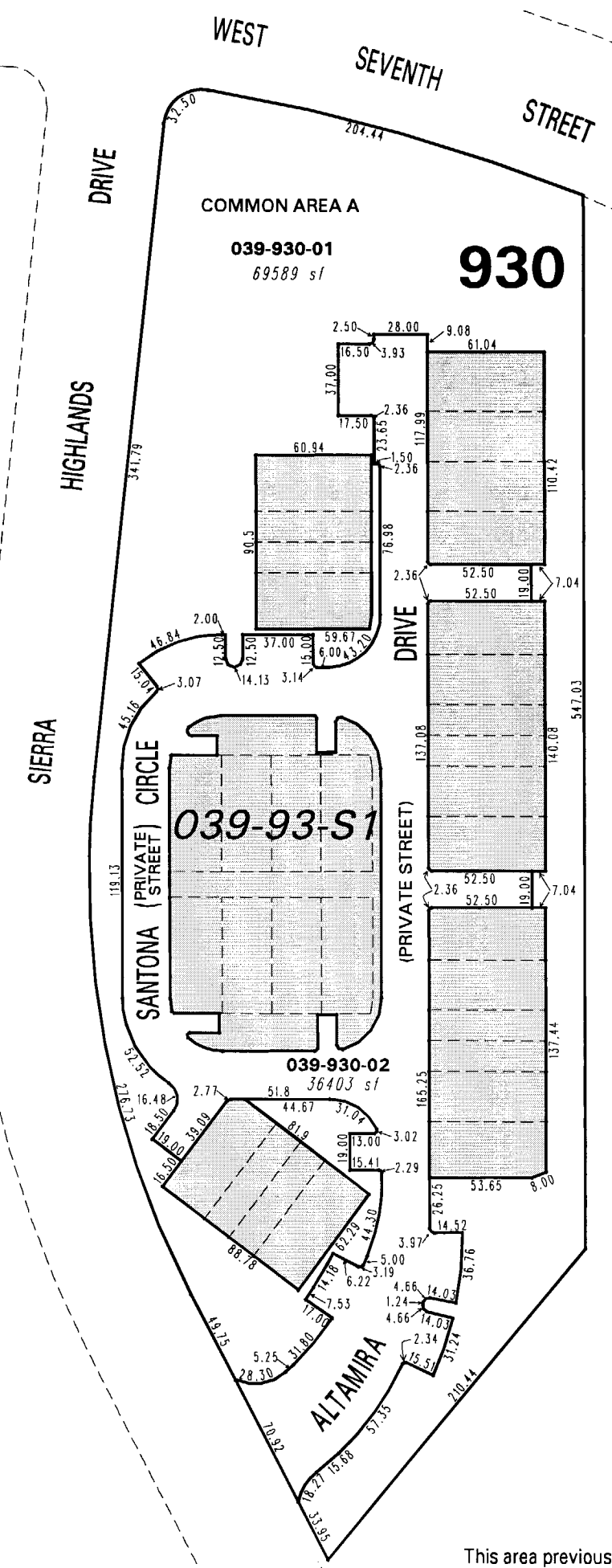

1" = 80'



NOTE: This map is prepared for the use of the Washoe County Assessor for assessment and illustrative purposes only. It does not represent a survey of the premises. No liability is assumed as to the sufficiency or the accuracy of the data delineated hereon.

Office of Washoe County Assessor, Nevada - Joshua G. Wilson

This area previously shown on 039-05

NOTE: Areas of parcels which are less than 2 acres are shown in square feet.

Drawn by	JL 08/29/07
Revised	