

027-55-S3

027-55-S3

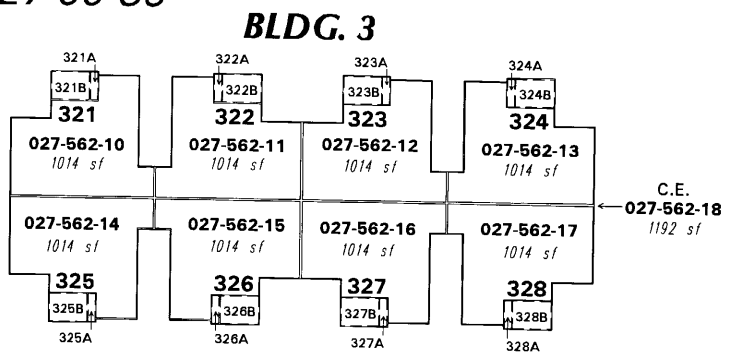

(#4843)
THE VILLAGE AT WILDCREEK
 A CONDOMINIUM SUBDIVISION

A POR. OF THE E 1/2 OF SEC. 31,
 AND A POR. OF THE W 1/2 OF SEC. 32,
 T20N - R20E
 (SECOND FLOOR)

027-55-S3

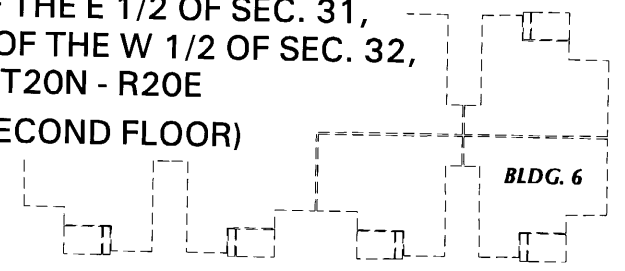
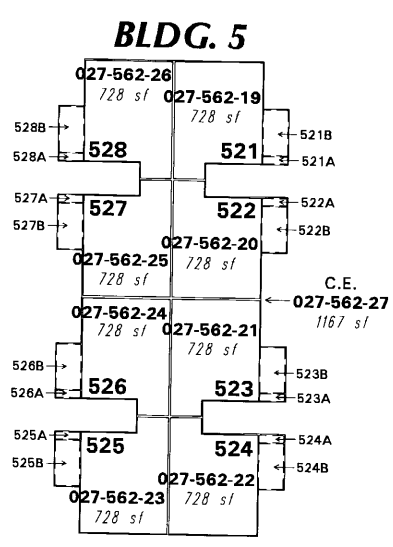
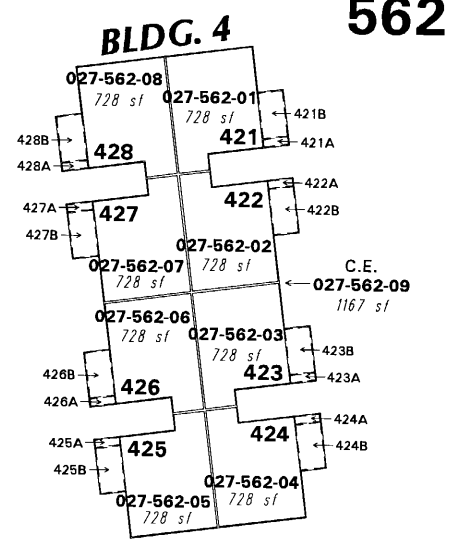

027-55-S3

027-55-S3

NOTES
 SEE PAGES 027-55 thru 027-55-S2 FOR
 BUILDING DETAILS AND DIMENSIONS
 SEE PAGE 027-55-S3 FOR
 BUILDING OVERVIEW
 SEE PAGE 027-56-S1 FOR FIRST FLOOR
 C.E. = COMMON ELEMENT
 L.C.E. = LIMITED COMMON ELEMENT

L.C.E. KEY
 BLDG. NO. → 217A ← L.C.E.
 FLOOR UNIT NO.

UNIT NO. KEY
 BLDG. NO. → 217 ← UNIT NO.
 FLOOR

This area previously shown on 027-20

NOTE: This map is prepared for the use of the Washoe County Assessor for assessment and illustrative purposes only. It does not represent a survey of the premises. No liability is assumed as to the sufficiency or the accuracy of the data delineated herein.

Office of Washoe County Assessor, Nevada - Joshua G. Wilson

NOTE: Areas of parcels which are less than 2 acres are shown in square feet.

Drawn by NLH 01/08/08
 Revised _____
 ARC INFO 9.2 WINDOWS 2000 5.0

