

AMENDED PLAT OF
DONNER CREEK VILLAGE
A CONDOMINIUM
1st LEVEL OWNERSHIP

PHASE 3
A 1/56TH INTEREST EACH IN COMMON AREA

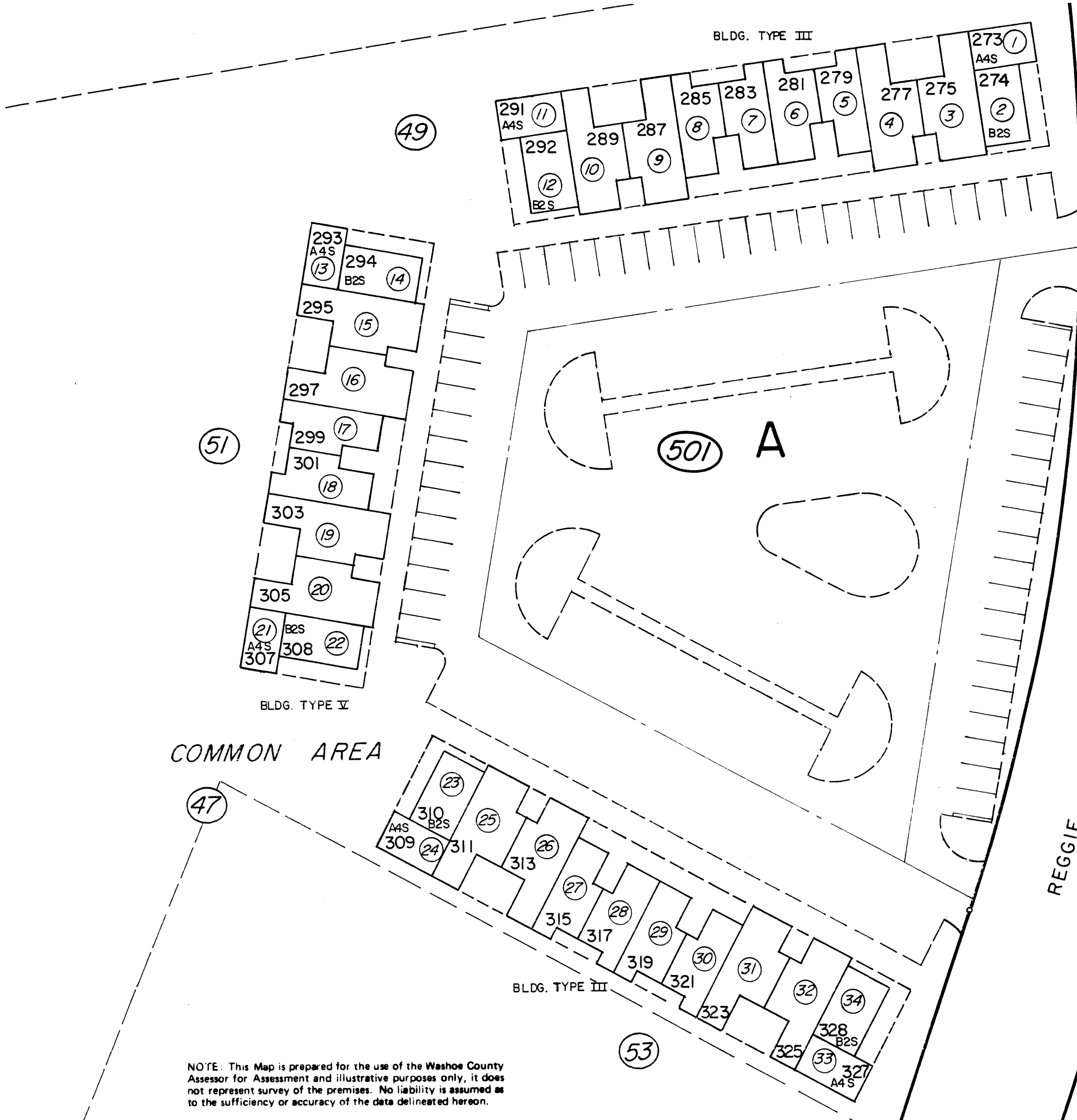

ROAD

REGGIE

44

NOTE: EXCEPT ON A4S, B2S & B3S
ODD NUMBERED UNITS ARE FIRST
FLOOR AND EVEN NUMBERED
UNITS SECOND FLOOR. ON A4S,
B2S & B3S OWNERSHIP IS
BOTH FIRST AND SECOND FLOOR.

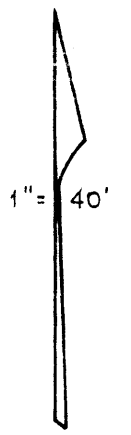

COMMON AREA

NOTE: This Map is prepared for the use of the Washoe County Assessor for Assessment and illustrative purposes only, it does not represent survey of the premises. No liability is assumed as to the sufficiency or accuracy of the data delineated hereon.

Assessor's Map County of Washoe, Nevada
NOTE - ASSESSOR'S BLOCK NUMBERS SHOWN IN ELLIPSES
ASSESSOR'S PARCEL NUMBERS SHOWN IN CIRCLES

drawn by MARY CRAIG 12/80
revised 6/82
superseded