

STATE OF NEVADA
WASHOE COUNTY
ASSESSOR'S OFFICE
Joshua G. Wilson, Assessor

1001 East Ninth Street
Building D
Reno, Nevada 89512
(775) 328-2231

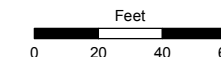

1 inch = 60 feet



created by: NLH 5/03/2012

last updated: _____

area previously shown on map(s)

NOTE: This map was prepared for the use of the Washoe County Assessor for assessment and illustrative purposes only. It does not represent a survey of the premises. No liability is assumed as to the sufficiency or accuracy of the data delineated hereon.

(#1327)
SIERRA LOMA UNIT NO. 2
A DENSITY SUBDIVISION

A POR. OF THE SW ¼ OF SEC. 4
T19N - R19E

LOT DETAIL - NOT TO SCALE

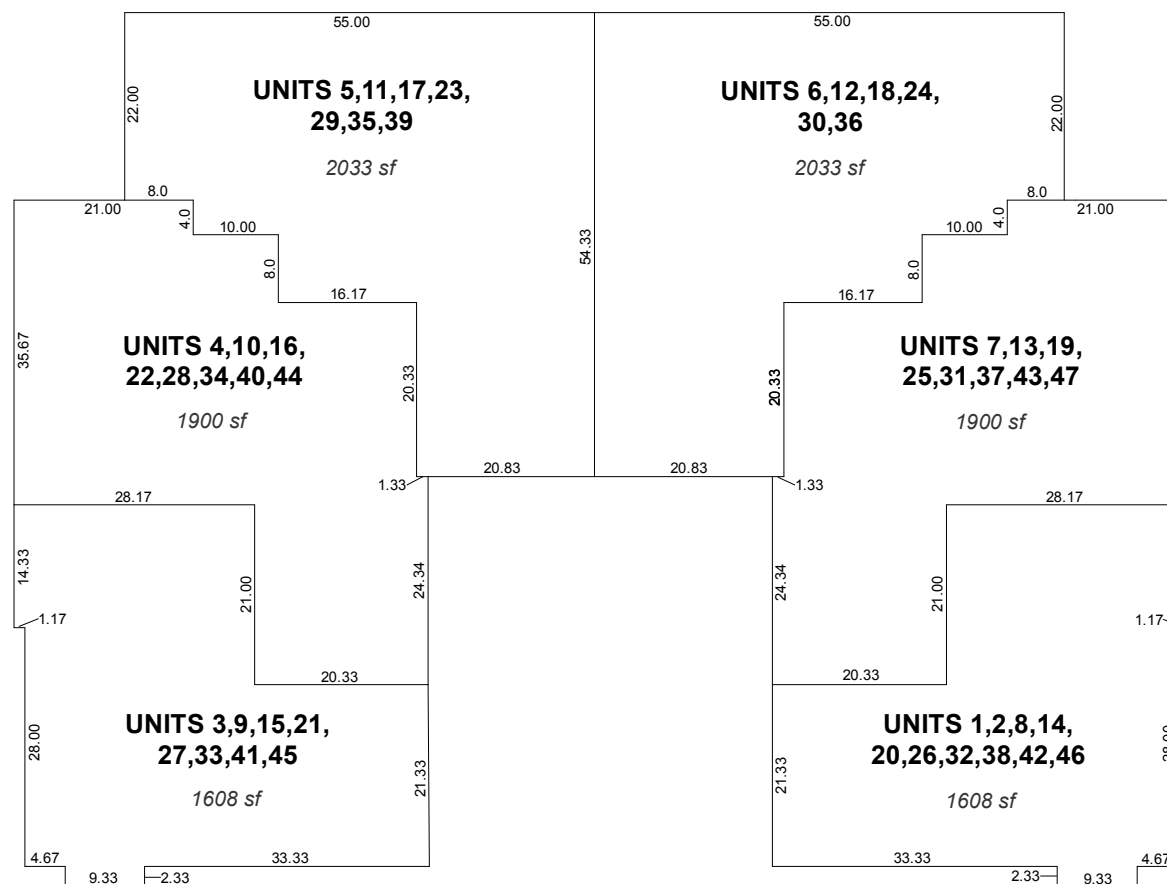

SEE PAGE 001-33 FOR COMMON AREA PARCEL
AND PAGE 001-33-S1 FOR UNIT PARCELS