

161-10

161-08

CARAT AVENUE

**(#4183)
DOUBLE DIAMOND RANCH
VILLAGE 7**

A PLANNED UNIT DEVELOPMENT

POR. SE 1/4 SECTION 9
AND POR. NE 1/4 SECTION 16
T18N - R20E

161-22

BOOK 160

161-19

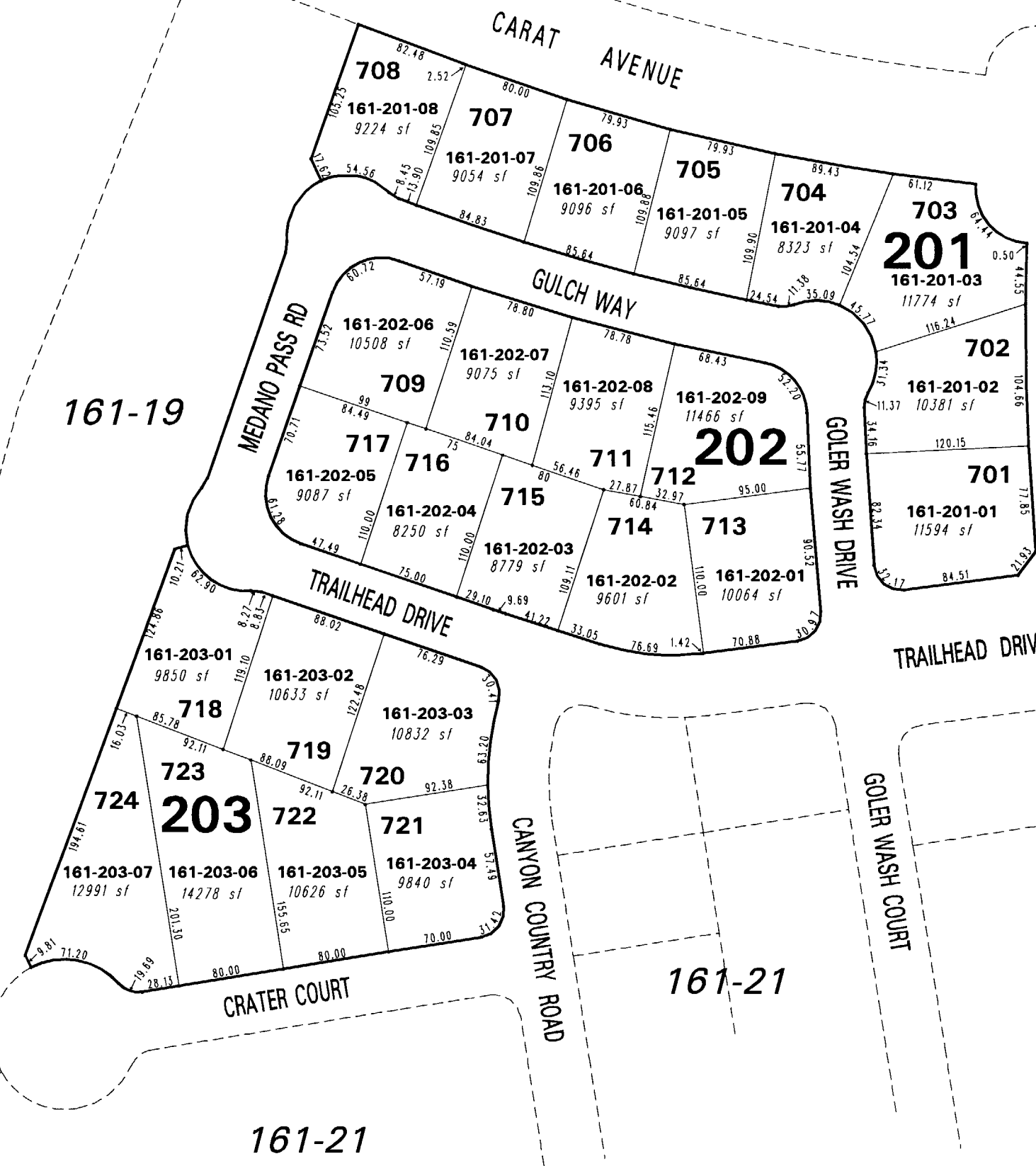

161-21

161-21

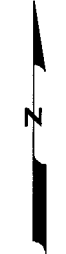

1" = 100'



NOTE: This map is prepared for the use of the Washoe County Assessor for assessment and illustrative purposes only. It does not represent a survey of the premises. No liability is assumed as to the sufficiency or the accuracy of the data delineated hereon.

Office of Washoe County Assessor, Nevada - Robert W. McGowan

This area previously shown on 161-18

NOTE: Areas of parcels which are less than 2 acres are shown in square feet.

Drawn by	HCS	04/09/03
Revised	HCS	6/12/03 PK 3/2/06