

Assessor's Map Number

130-22-S1

STATE OF NEVADA
WASHOE COUNTY
ASSESSOR'S OFFICE
Joshua G. Wilson, Assessor

1001 East Ninth Street
Building D
Reno, Nevada 89512
(775) 328-2231

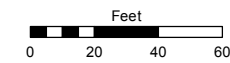

1 inch = 60 feet

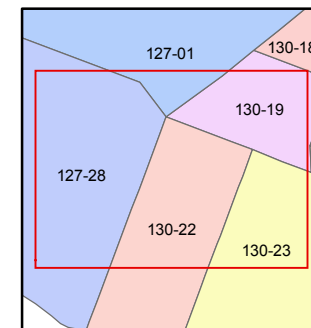
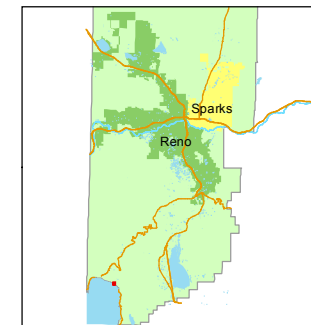

created by: KSB 9/27/11

last updated: _____

area previously shown on map(s)

NOTE: This map was prepared for the use of the Washoe County Assessor for assessment and illustrative purposes only. It does not represent a survey of the premises. No liability is assumed as to the sufficiency or accuracy of the data delineated herein.

COUNTRY CLUB DR.

LAKESHORE

BOULEVARD

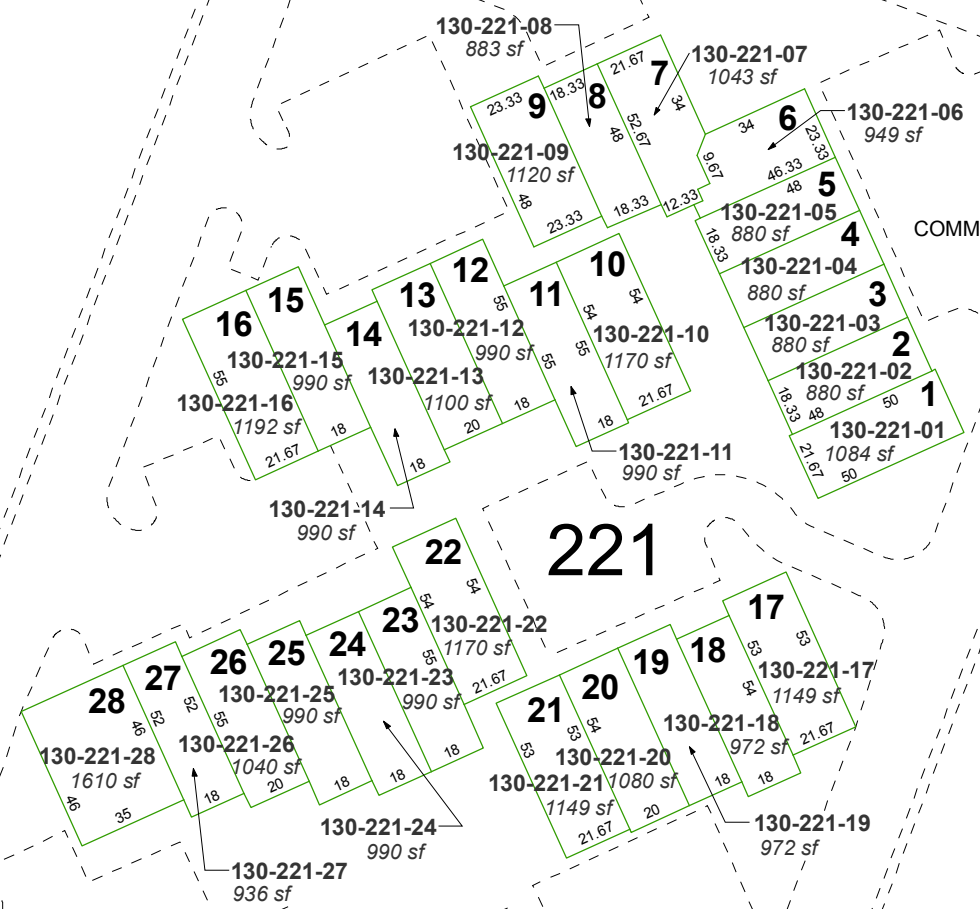

(#1051)
A RESUBDIVISION OF
999 LAKESHORE
A TOWNHOUSE

PORTION OF SECTION 22
T16N - R18E

UNITS ONLY

130-22-S2