

(#1787)
ROUNDHOUSE VILLAGE
 A TOWNHOUSE DEVELOPMENT

A POR. OF THE NE 1/4 OF THE SE 1/4 OF SEC. 6,
 T19N - R20E

031-11

Assessor's Map Number

031-42

STATE OF NEVADA
WASHOE COUNTY
ASSESSOR'S OFFICE
 Joshua G. Wilson, Assessor

1001 East Ninth Street
 Building D
 Reno, Nevada 89512
 (775) 328-2231

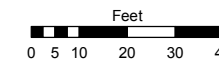

1 inch = 40 feet

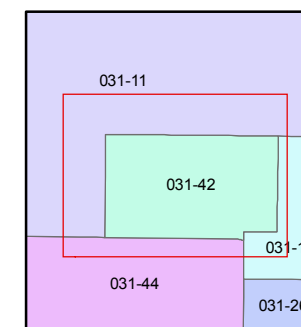
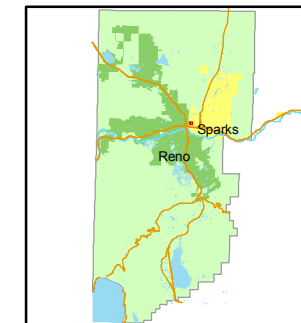

created by: NLH 4/28/2010

last updated: _____

area previously shown on map(s) _____

NOTE: This map was prepared for the use of the Washoe County Assessor for assessment and illustrative purposes only. It does not represent a survey of the premises. No liability is assumed as to the sufficiency or accuracy of the data delineated hereon.

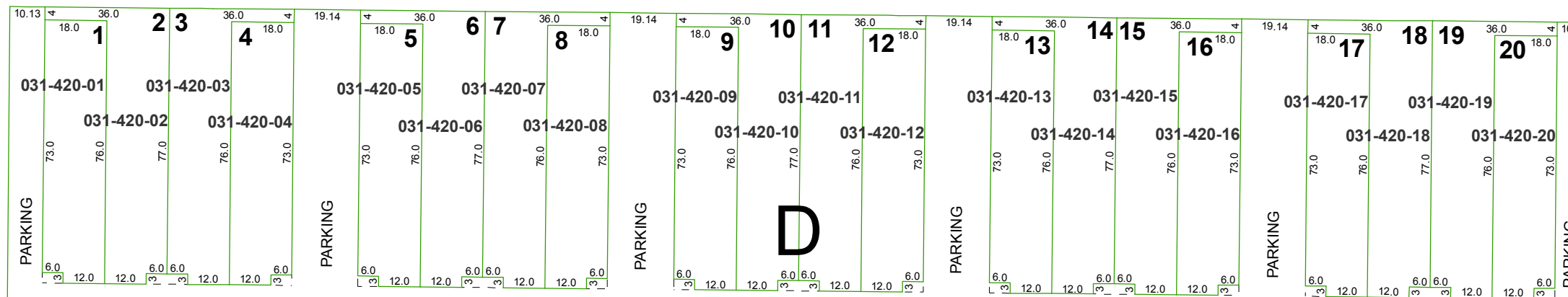

031-11

TYPICAL BUILDING UNITS
 NOT TO SCALE

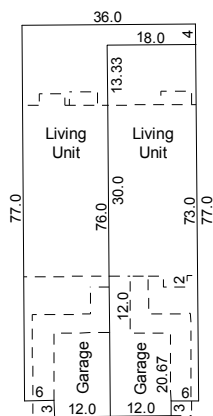

BLOCK D

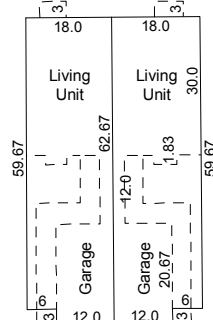

BLOCKS A, B, & C

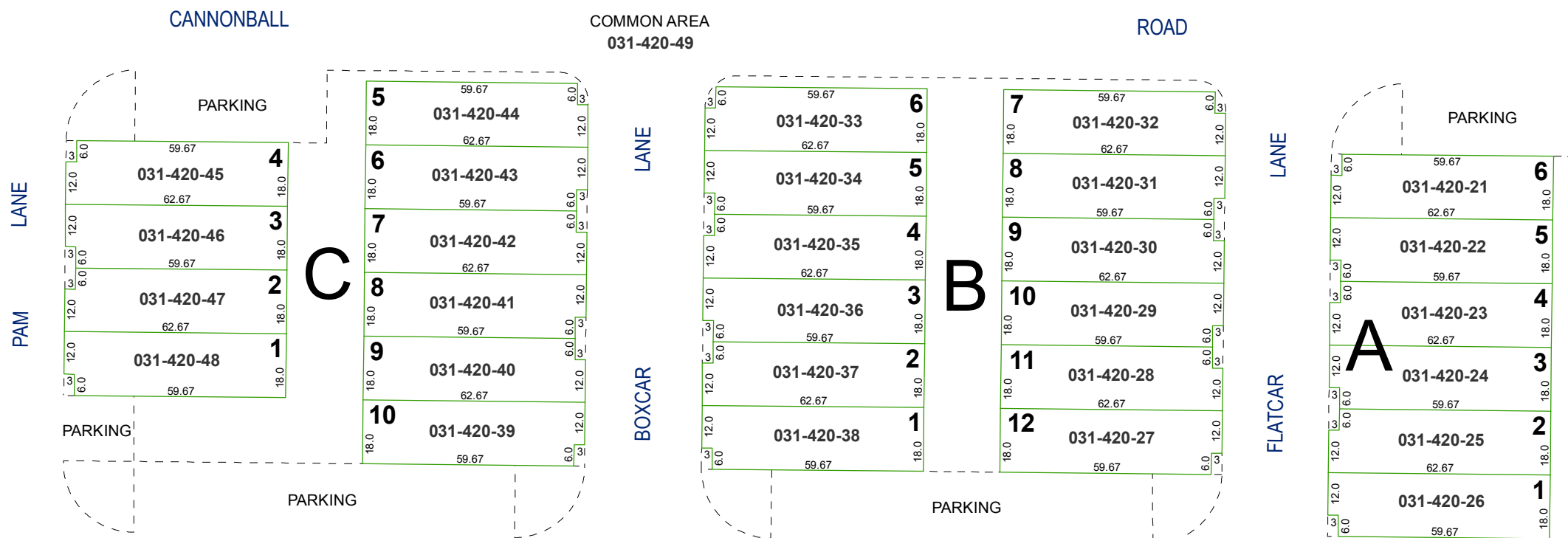

031-44

031-10