

(#1962)
CLEAR ACRE CONDOMINIUMS
A CONDOMINIUM

PORTION SE 1/4 SECTION 36
T20N - R19E

(#4943)
REVERSION TO ACREAGE
of AMENDED PORTION (#2282)

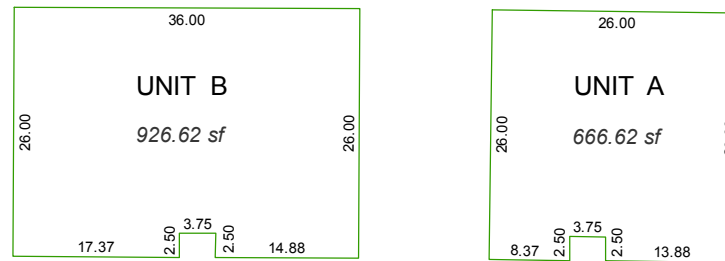

TYPICAL UNITS
SCALE: 1" = 20'

Assessor's Map Number

004-38-S4

STATE OF NEVADA
WASHOE COUNTY
ASSESSOR'S OFFICE
Joshua G. Wilson, Assessor

1001 East Ninth Street
Building D
Reno, Nevada 89512
(775) 328-2231

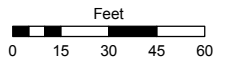

1 inch = 60 feet



created by: KSB 7/12/10

last updated: _____

area previously shown on map(s)

NOTE: This map was prepared for the use of the Washoe County Assessor for assessment and illustrative purposes only. It does not represent a survey of the premises. No liability is assumed as to the sufficiency or accuracy of the data delineated hereon.