

(#2083)

# WHISPERING SPRINGS (AMENDED)

A CONDOMINIUM - (LOWER FLOOR)

POR. SE 1/4 SECTION 36

T20N - R19E

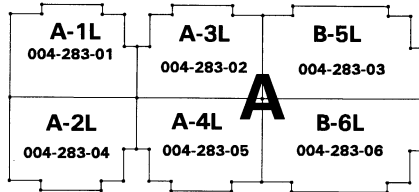

283

TRIPP DRIVE

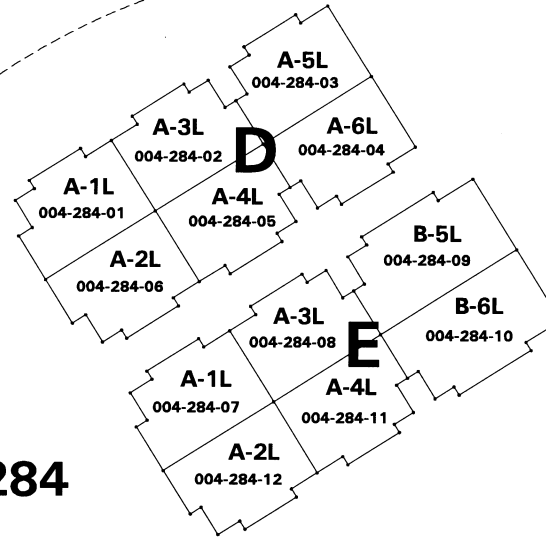

284

ORR DITCH

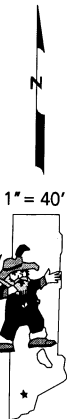
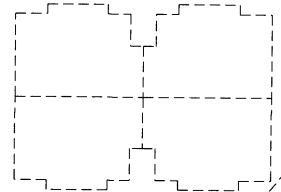
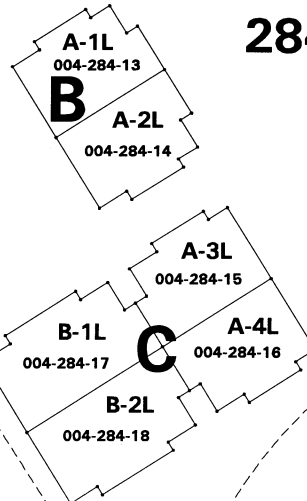

NOTE: This map is prepared for the use of the Washoe County Assessor for assessment and illustrative purposes only. It does not represent a survey of the premises. No liability is assumed as to the sufficiency or the accuracy of the data delineated hereon.

Office of Washoe County Assessor, Nevada - Robert W. McGowan

This area previously shown on \_\_\_\_\_

NOTE: Areas of parcels which are less than 2 acres are shown in square feet.

Drawn by HCS 06/26/03  
 Revised by \_\_\_\_\_  
 \_\_\_\_\_