

BOOK 522

VISTA BOULEVARD

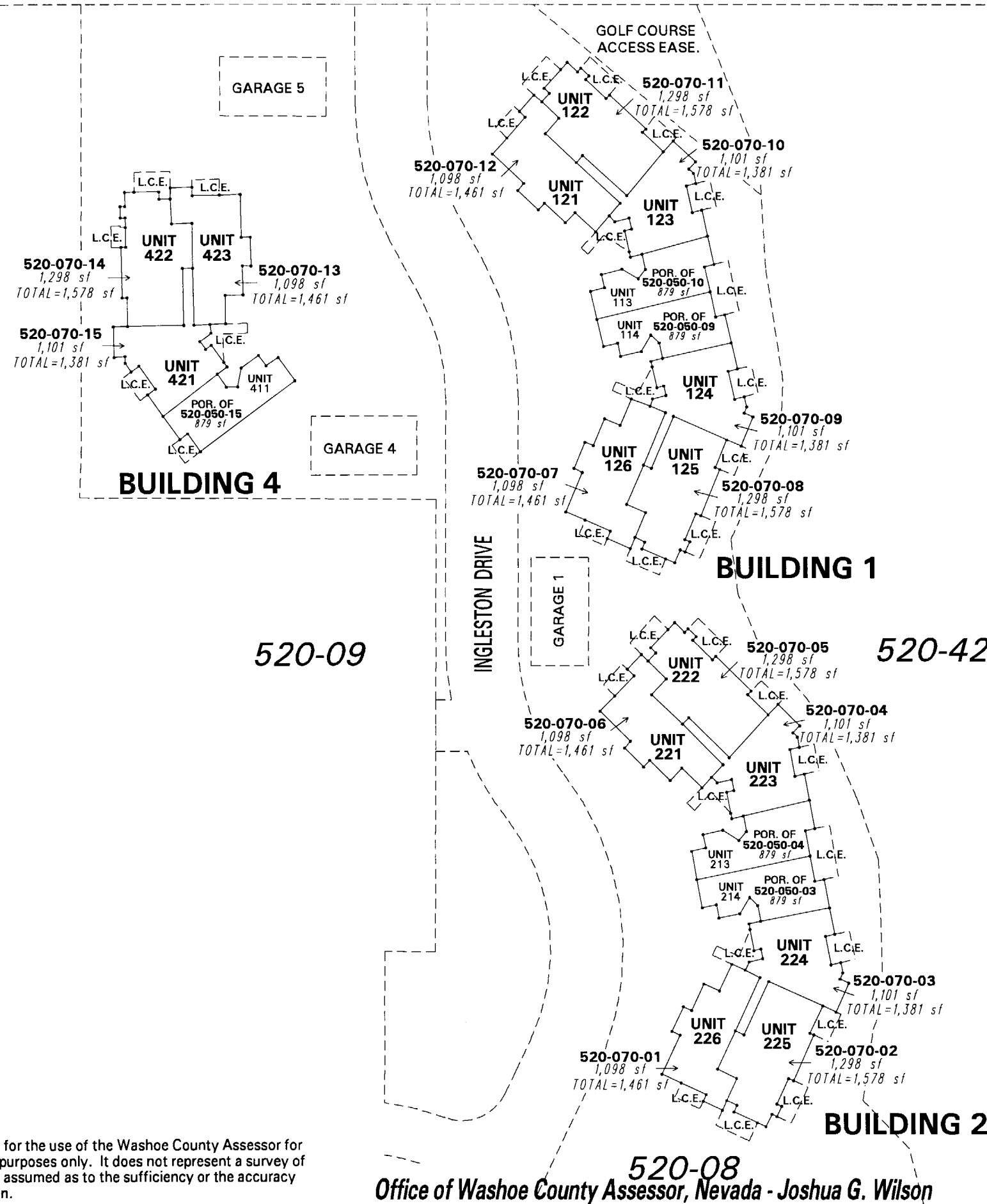

**(#3584)  
WINGFIELD SPRINGS  
UNIT TWENTY-FOUR A  
A CONDOMINIUM SUBDIVISION  
PLANNED DEVELOPMENT**

**PORTION NW 1/4 SECTION 13  
T20N - R20E**

- NOTES:
- DIMENSIONS AND UNIT AREAS GIVEN ARE TO INSIDE WALLS
  - SEE 520-08-S1 FOR COMPLETE SECOND FLOOR DIMENSIONS
  - TOTAL UNIT AREA INCLUDES AREA FOR GARAGE
  - SEE 520-05 FOR FIRST FLOOR AREAS
  - L.C.E. = LIMITED COMMON ELEMENT

**SECOND FLOOR UNITS**

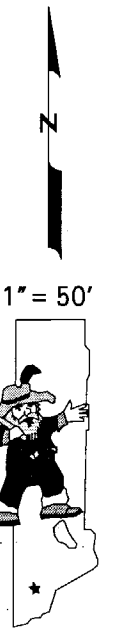

NOTE: This map is prepared for the use of the Washoe County Assessor for assessment and illustrative purposes only. It does not represent a survey of the premises. No liability is assumed as to the sufficiency or the accuracy of the data delineated hereon.

Office of Washoe County Assessor, Nevada - Joshua G. Wilson

This area previously shown on 522-67

NOTE: Areas of parcels which are less than 2 acres are shown in square feet.

Drawn by DSR 08/28/98  
 Revised DSR 9/9/98 \* CFB 12/3/99  
DSR 4/12/00 PK 11/21/05 NLH 02/02/07