

BOOK 522

VISTA BOULEVARD

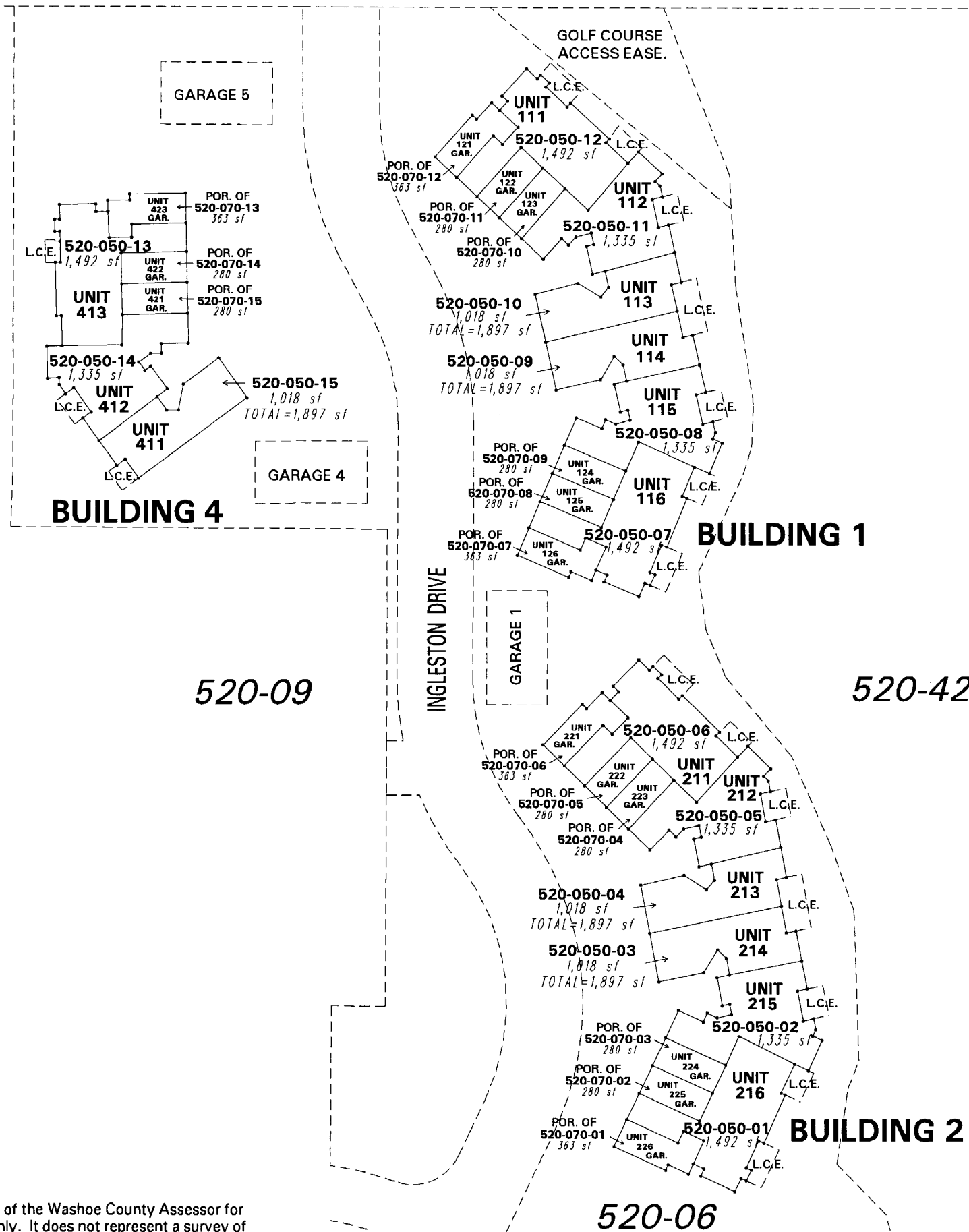

**(#3584)
WINGFIELD SPRINGS
UNIT TWENTY-FOUR A
A CONDOMINIUM SUBDIVISION
PLANNED DEVELOPMENT**

**PORTION NW 1/4 SECTION 13
T20N - R20E**

NOTES:

DIMENSIONS AND UNIT AREAS GIVEN ARE TO INSIDE WALLS

SEE 520-06-S1 FOR COMPLETE FIRST FLOOR DIMENSIONS

TOTAL UNIT AREA INCLUDES AREA FOR GARAGE AND/OR SECOND FLOOR

SEE 520-07 FOR SECOND FLOOR AREAS

L.C.E. = LIMITED COMMON ELEMENT

FIRST FLOOR UNITS

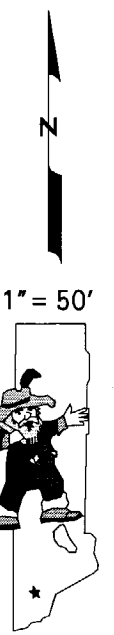

NOTE: This map is prepared for the use of the Washoe County Assessor for assessment and illustrative purposes only. It does not represent a survey of the premises. No liability is assumed as to the sufficiency or the accuracy of the data delineated hereon.

Office of Washoe County Assessor, Nevada - Joshua G. Wilson

This area previously shown on 522-65

Drawn by DSR 08/28/98
 Revised DSR 9/9/98 * CFB 12/2/99
DSR 4/12/00 PK 11/21/05 NLH 02/01/07

NOTE: Areas of parcels which are less than 2 acres are shown in square feet.