

**(#4348)
GRANITE RIDGE PHASE 3**

POR. S 1/2 SECTION 31
T20N - R19E
AND POR. N 1/2 SECTION 6
T19N - R19E

204-60

204-65

30' PRIVATE ACCESS,
WATERLINE, AND MAINTENANCE
ACCESS ROAD ESMT.

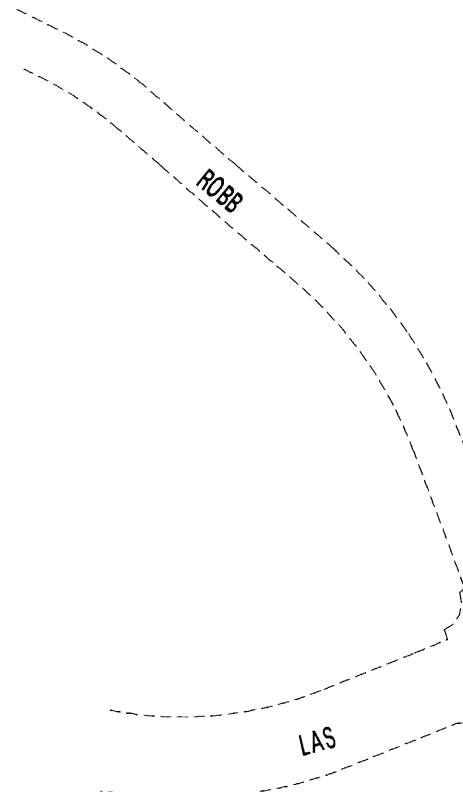

204-65

204-61

COMMON AREA
PARCEL C
204-711-15
2929 sf

204-54

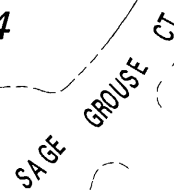

204-01

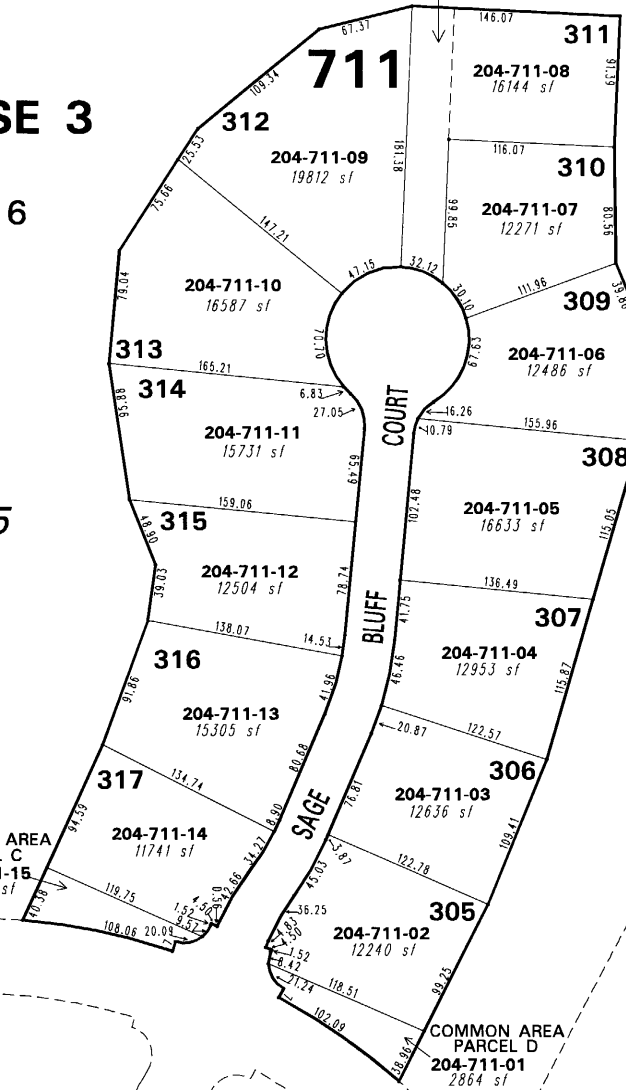

204-01

NGS STATION
"CHALK BLUFF"
N 14,862838.955
E 2,260,459.842

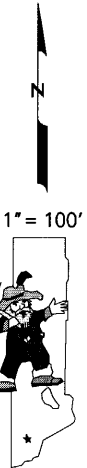

This area previously shown on 204-65

NOTE: This map is prepared for the use of the Washoe County Assessor for assessment and illustrative purposes only. It does not represent a survey of the premises. No liability is assumed as to the sufficiency or the accuracy of the data delineated hereon.

Office of Washoe County Assessor, Nevada - Joshua G. Wilson

NOTE: Areas of parcels which are less than 2 acres are shown in square feet.

Drawn by PK 06/24/04
Revised NLH 06/01/07