

Assessor's Map Number

123-26-S6

STATE OF NEVADA
WASHOE COUNTY
ASSESSOR'S OFFICE
Joshua G. Wilson, Assessor

1001 East Ninth Street
Building D
Reno, Nevada 89512
(775) 328-2231

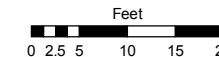

1 inch = 20 feet

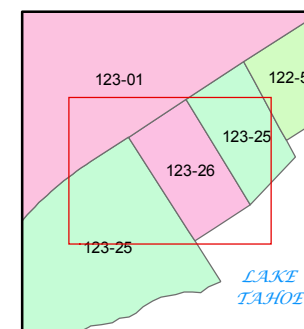
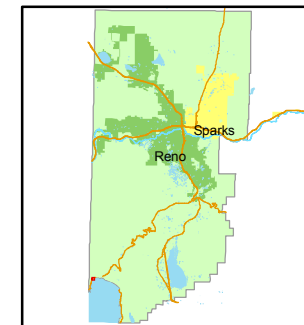

created by: NLH 8/04/2010

last updated: _____

area previously shown on map(s)

(#1173)
CRYSTAL TOWER
A CONDOMINIUM
A POR. OF THE SE ¼ OF SEC. 18
T16N - R18E
1/10 INTEREST TO EACH UNIT
IN COMMON AREA
SIXTH FLOOR

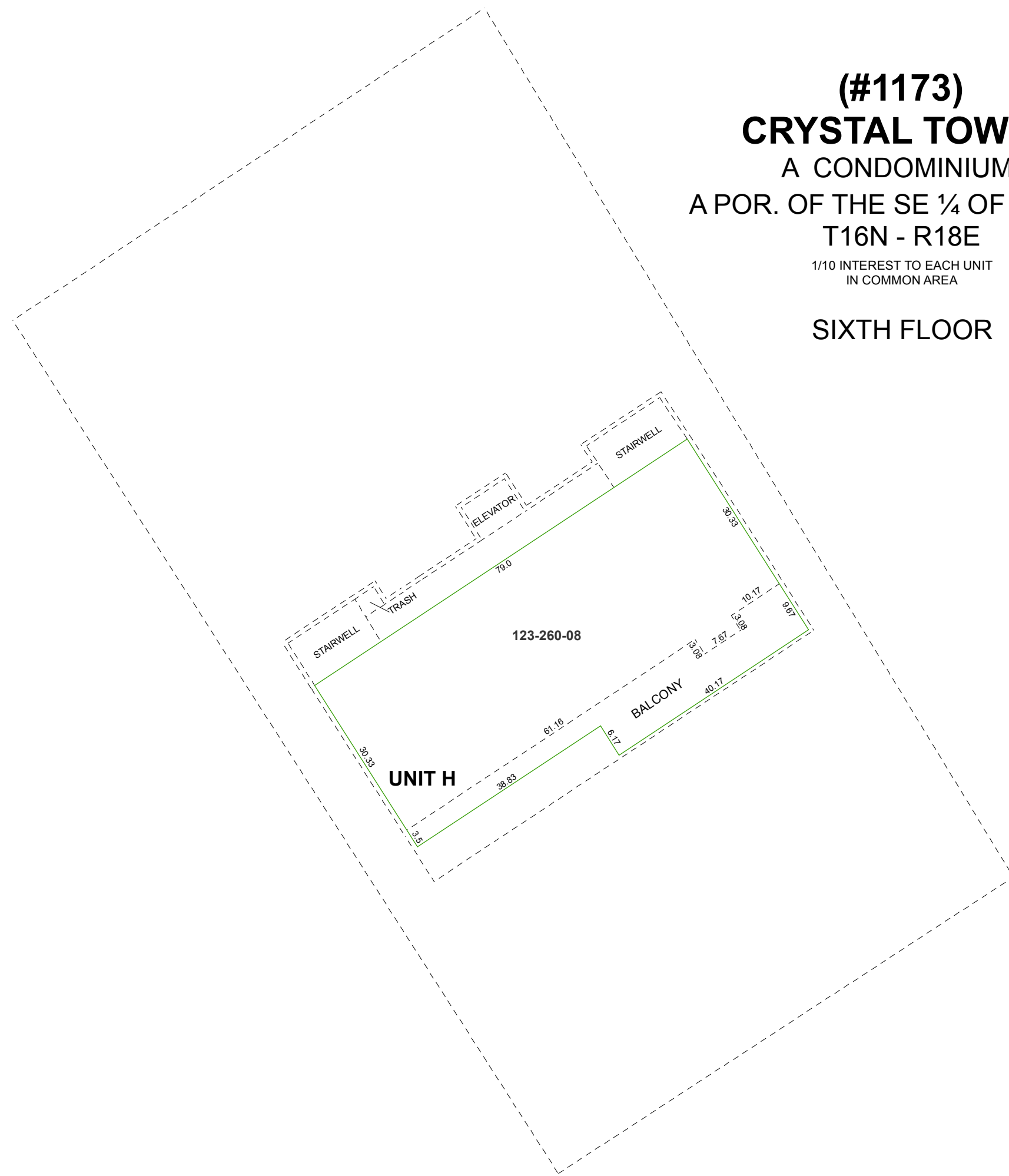

NOTE: This map was prepared for the use of the Washoe County Assessor for assessment and illustrative purposes only. It does not represent a survey of the premises. No liability is assumed as to the sufficiency or accuracy of the data delineated hereon.