

043-32-S4

043-32-S1

30' Sanitary Sewer,  
Access & PUE

30' Sanitary Sewer,  
Access & PUE

Building Exterior

043-03

PARCEL MAPS 4102, 4103 AND RECORD OF SURVEY 4369  
**SIERRA PINES PROFESSIONAL PLAZA**  
A COMMERCIAL CONDOMINIUM  
PORTION OF SECTION 6  
T18N - R20E

043-32-S2

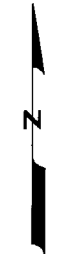
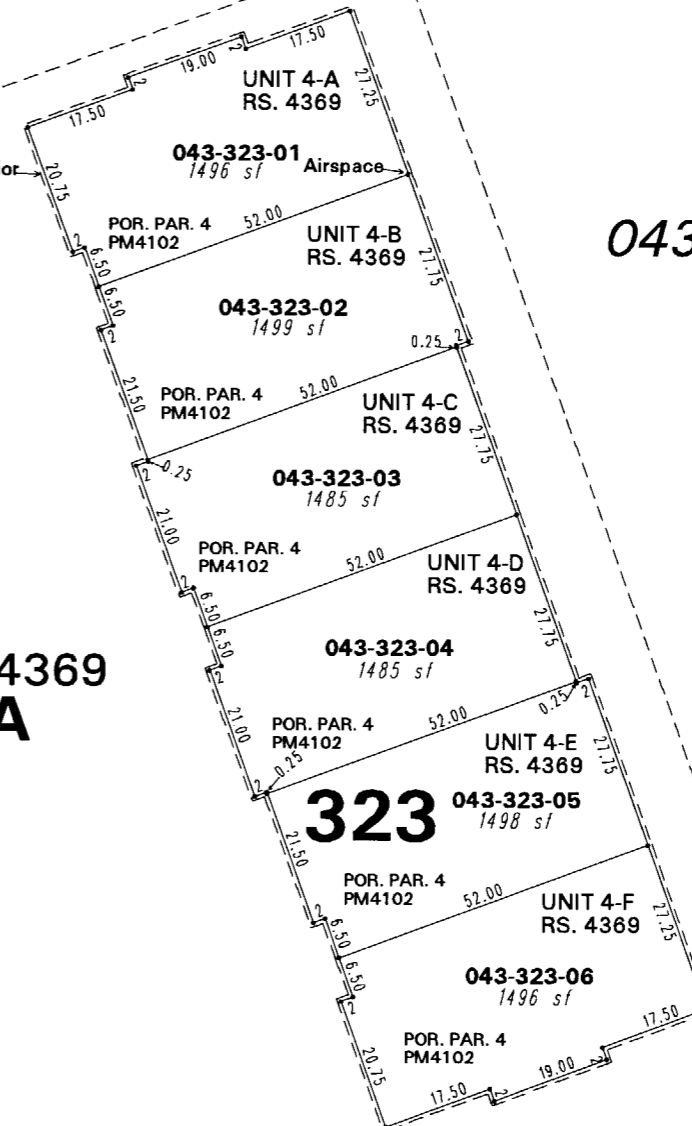

1" = 30'



043-03

NOTE: This map is prepared for the use of the Washoe County Assessor for assessment and illustrative purposes only. It does not represent a survey of the premises. No liability is assumed as to the sufficiency or the accuracy of the data delineated hereon.

Office of Washoe County Assessor, Nevada - Robert W. McGowan

This area previously shown on 43-03

NOTE: Areas of parcels which are less than 2 acres are shown in square feet.

Drawn by	PK 05/08/04
Revised	