

(#4698)  
THE VILLAGE AT IDLEWILD PARK  
PORTION OF THE NE 1/4 SECTION 15  
T19N - R19E  
ground floor units

010-57-S3

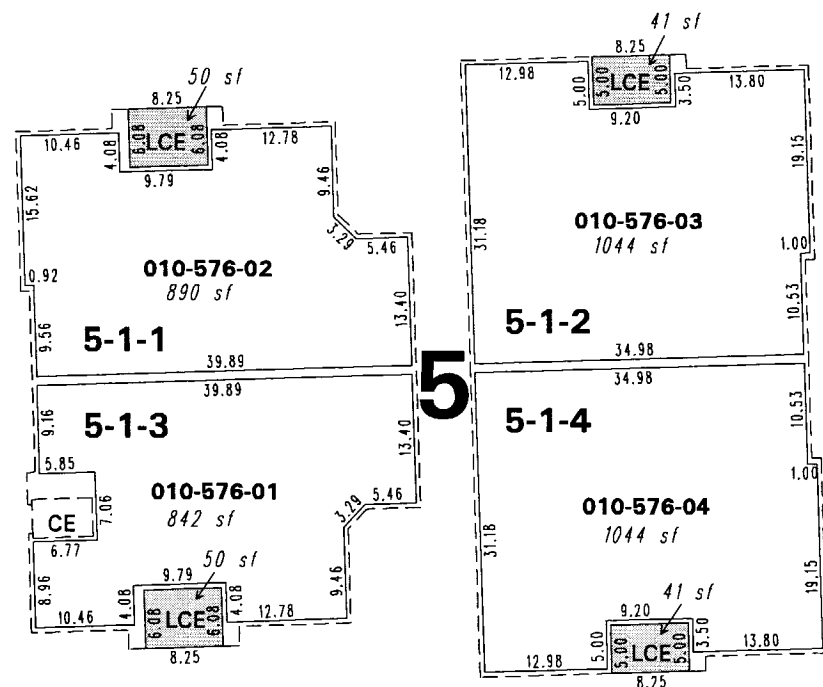

010-58

576

LEGEND

CE Common Element  
LCE Limited Common Element

**2** Building Number

**UNIT 2-1-8**  
BUILDING FLOOR UNIT  
NUMBER NUMBER NUMBER

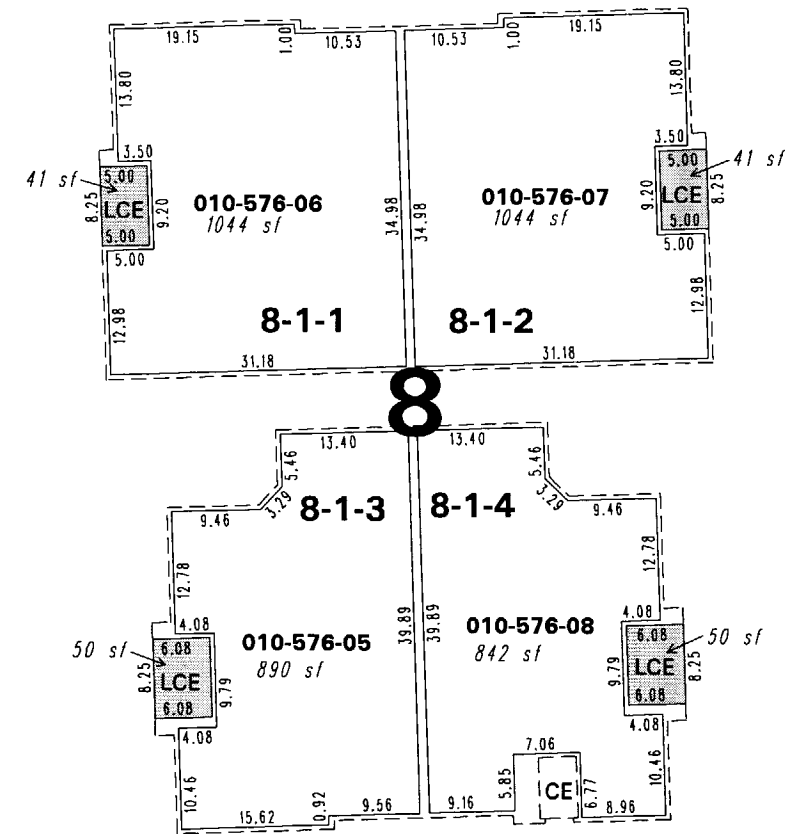

010-58-S3

1" = 20'



NOTE: This map is prepared for the use of the Washoe County Assessor for assessment and illustrative purposes only. It does not represent a survey of the premises. No liability is assumed as to the sufficiency or the accuracy of the data delineated hereon.

Office of Washoe County Assessor, Nevada - Robert W. McGowan

This area previously shown on 010-05

Drawn by	CFB 10/6/2006
Revised	

NOTE: Areas of parcels which are less than 2 acres are shown in square feet.