

AMENDED
IDLEWILD RIVERFRONT
CONDOMINIUMS

10-53-S-7

A CONDOMINIUM SUBDIVISION

BUILDING IV

UNITS ONLY

1/45 INTEREST EACH IN COMMON AREA

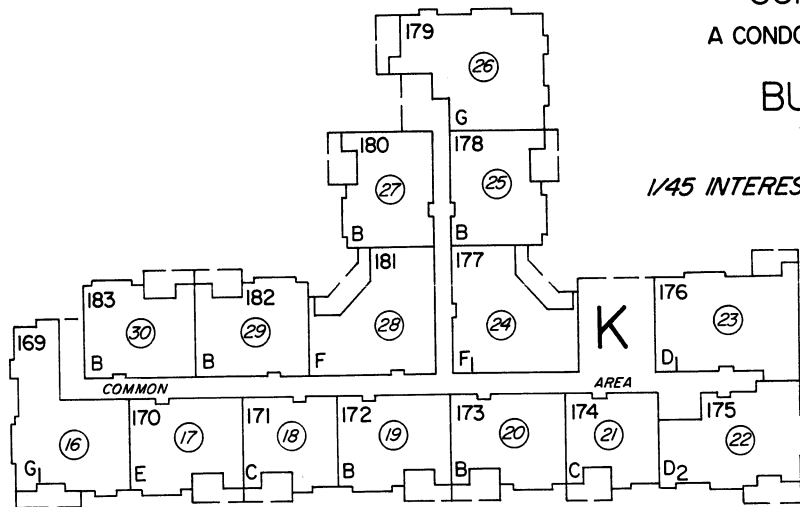

SECOND FLOOR UNITS

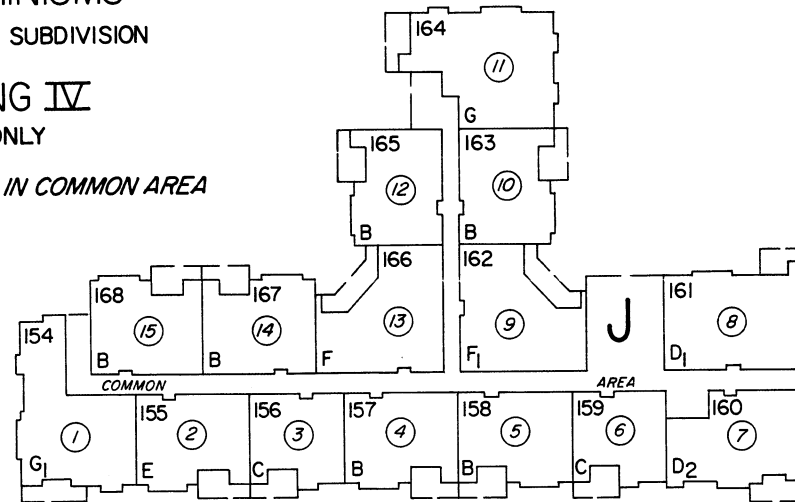

FIRST FLOOR UNITS

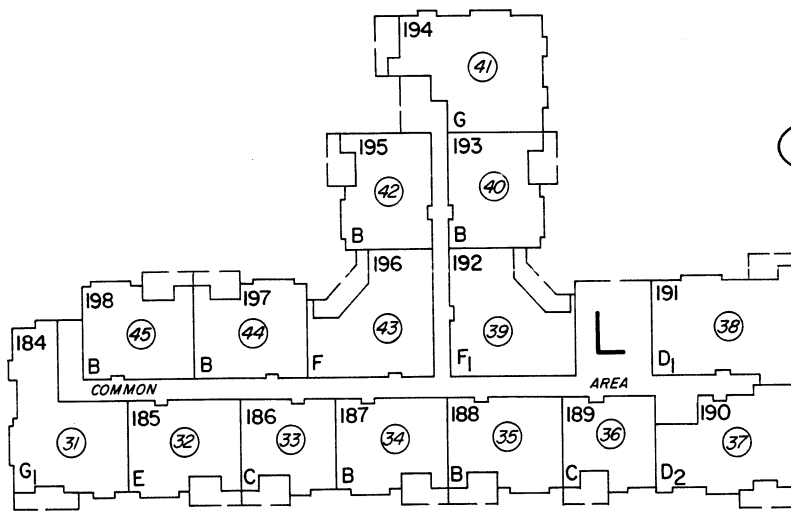

THIRD FLOOR UNITS

536

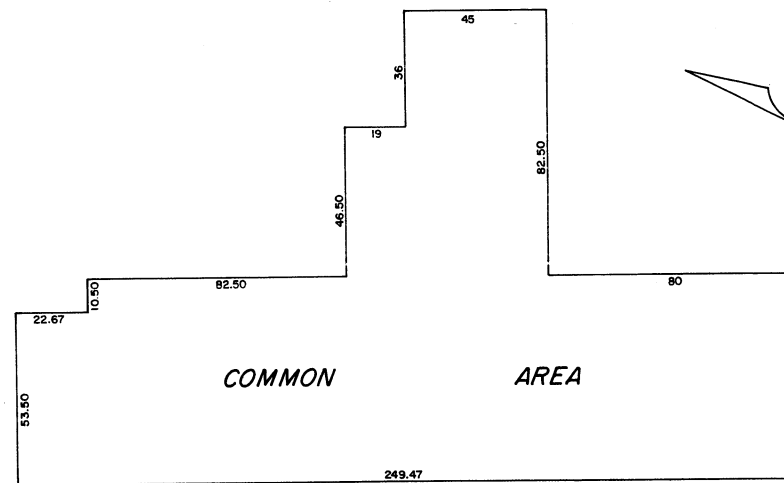

PARKING LEVEL

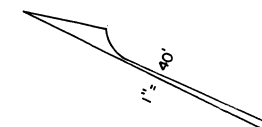

NOTE: This Map is prepared for the use of the Washoe County Assessor for Assessment and illustrative purposes only, it does not represent survey of the premises. No liability is assumed as to the sufficiency or accuracy of the data delineated hereon.

Assessor's Map County of Washoe, Nevada

NOTE - ASSESSOR'S BLOCK NUMBERS SHOWN IN ELLIPSES
ASSESSOR'S PARCEL NUMBERS SHOWN IN CIRCLES

drawn by	CFB 6/80
revised	
superseded	