

007-28

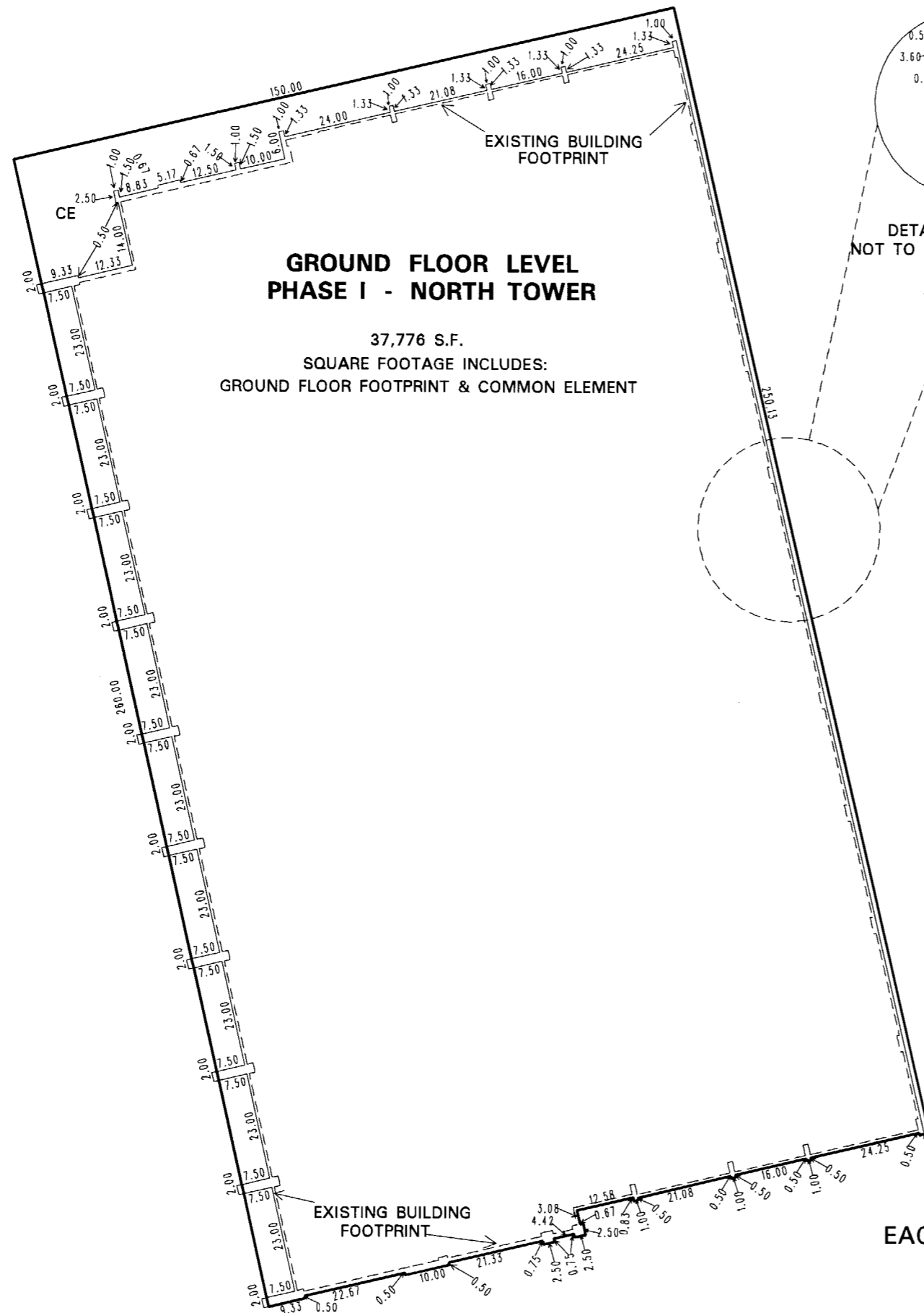

**GROUND FLOOR LEVEL
PHASE I - NORTH TOWER**

37,776 S.F.
SQUARE FOOTAGE INCLUDES:
GROUND FLOOR FOOTPRINT & COMMON ELEMENT

DETAIL NOT TO SCALE

NOTE: SEE 007-46-S8 FOR PROJECT OVERVIEW

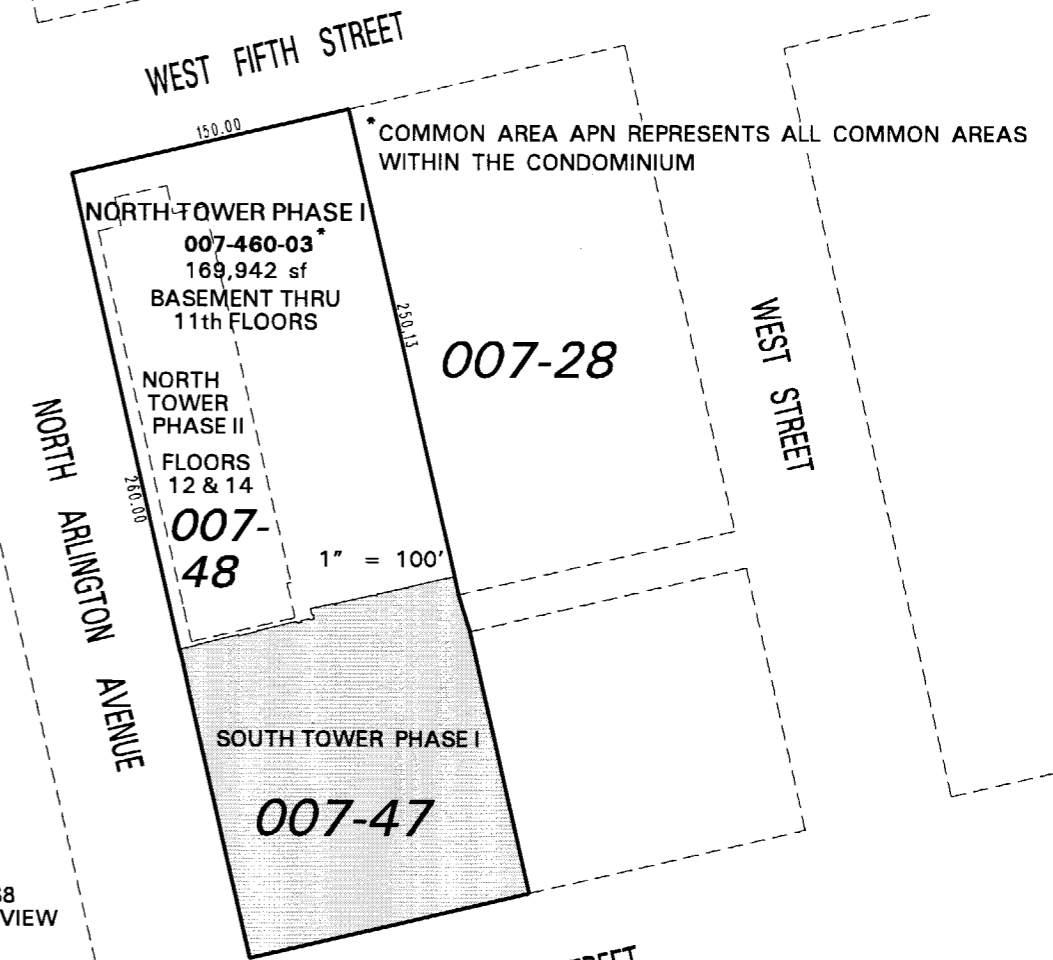

NORTH TOWER PHASE I
007-460-03*
169,942 sf
BASEMENT THRU
11th FLOORS

NORTH TOWER PHASE II
FLOORS
12 & 14

007-48

SOUTH TOWER PHASE I
007-47

1" = 100'

WEST FOURTH STREET

(#4606)

BELVEDERE TOWERS
A CONDOMINIUM SUBDIVISION - PHASE I
PORTION OF THE NW 1/4 SECTION 11,
T19N - R19E

EACH UNIT HAS A 1/158TH INTEREST IN COMMON AREA PARCEL

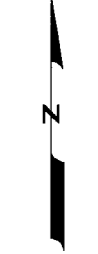

1" = 30'



NOTE: This map is prepared for the use of the Washoe County Assessor for assessment and illustrative purposes only. It does not represent a survey of the premises. No liability is assumed as to the sufficiency or the accuracy of the data delineated hereon.

Office of Washoe County Assessor, Nevada - Joshua G. Wilson

This area previously shown on 007-28

Drawn by PK 3/29/06
Revised JL 3/13/07

NOTE: Areas of parcels which are less than 2 acres are shown in square feet.