

(#475A)

RENO HIGHLANDS SUBDIVISION

PORTION OF THE NW 1/4 SEC. 3

T19N - R19E

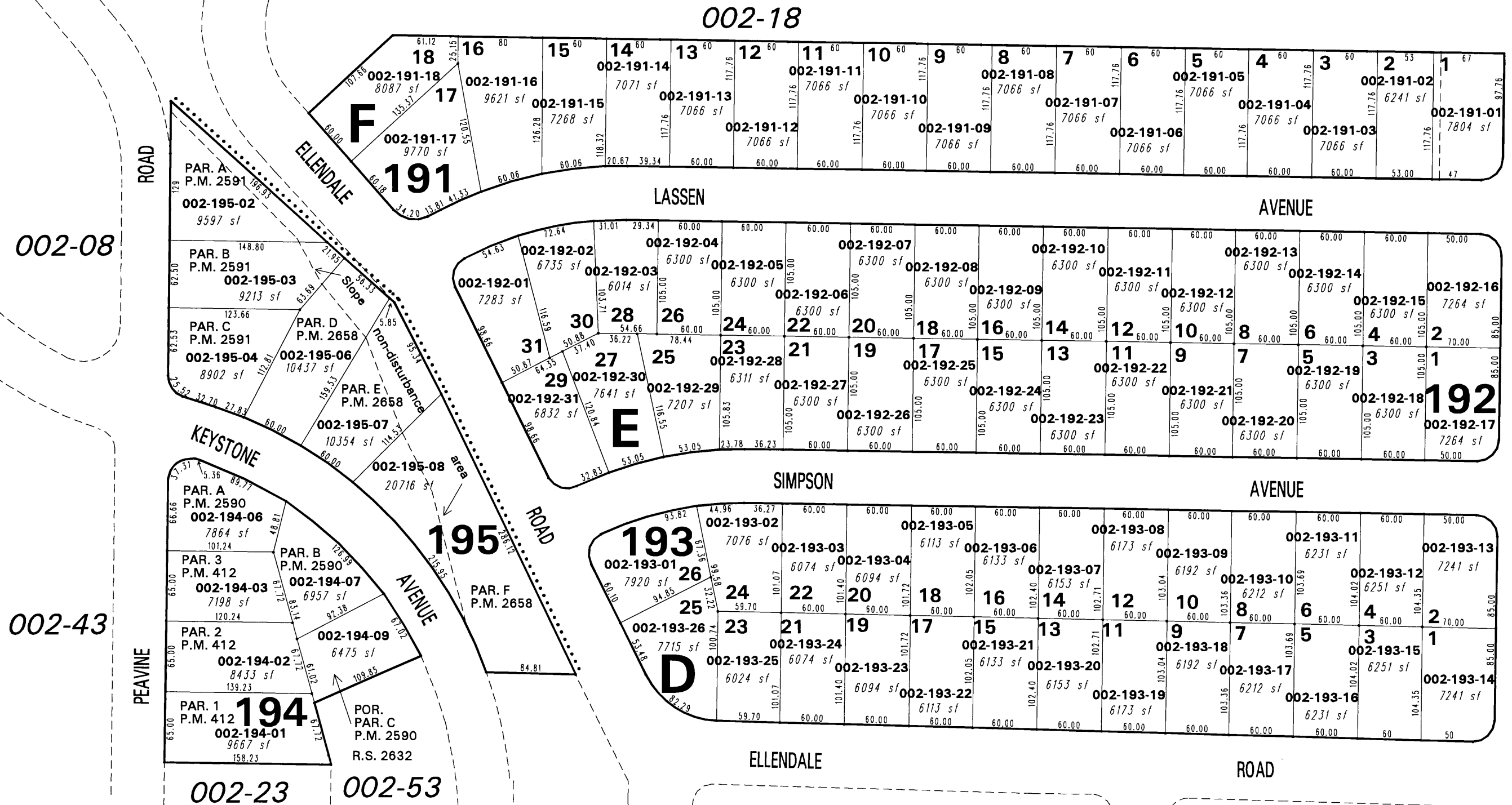

002-08

002-43

DRIVE

002-55

COLEMAN

1" = 100'



NOTE: This map is prepared for the use of the Washoe County Assessor for assessment and illustrative purposes only. It does not represent a survey of the premises. No liability is assumed as to the sufficiency or the accuracy of the data delineated hereon.

Office of Washoe County Assessor, Nevada - Joshua G. Wilson

This area previously shown on _____

NOTE: Areas of parcels which are less than 2 acres are shown in square feet.

Drawn by	JL 05/10/07
Revised	