

ESPLANADE AT NORTHGATE (#5381)

A CONDOMINIUM SUBDIVISION

PORTION OF SE¼ SECTION 1, T19N - R18E

UNIT DETAILS

BUILDING TYPE D
FIRST FLOOR

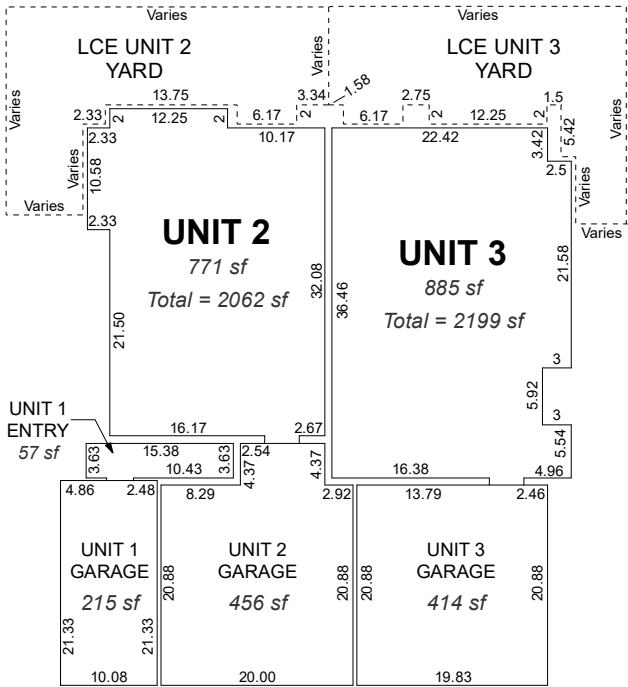

BUILDING TYPE E
FIRST FLOOR

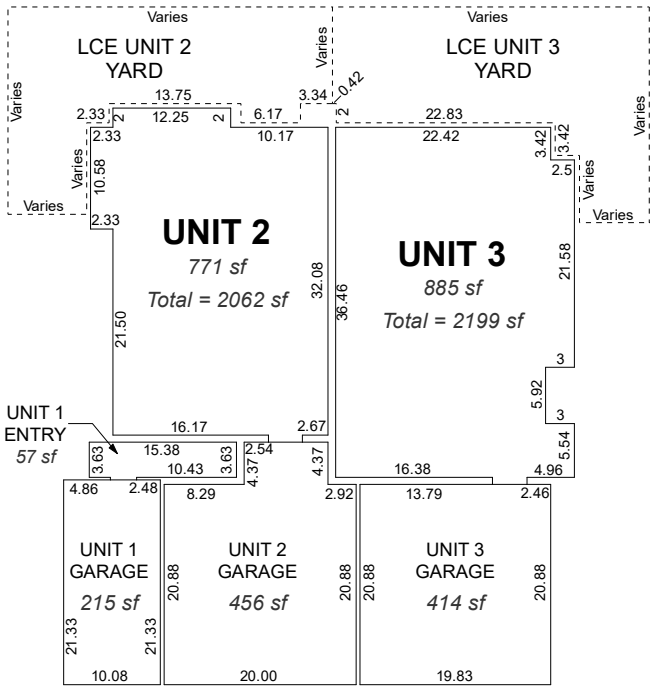

SECOND FLOOR

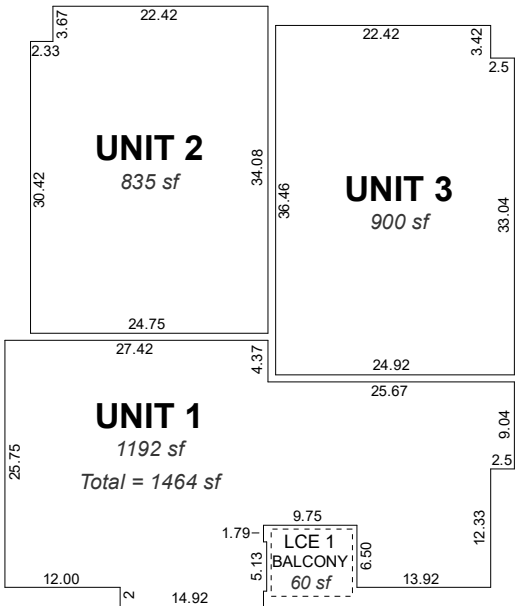

SECOND FLOOR

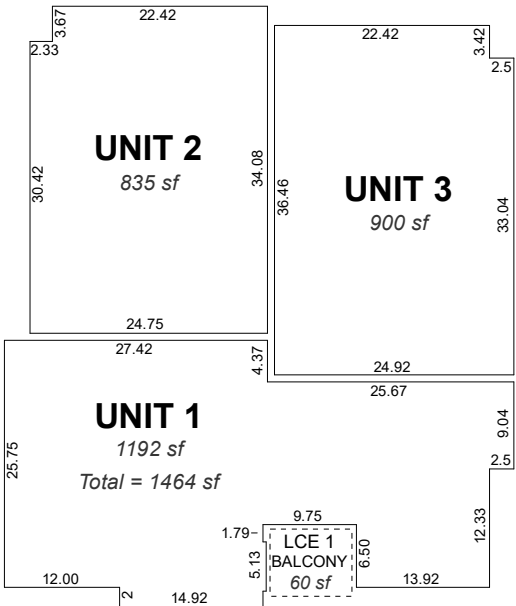

NOTES:

LCE = LIMITED COMMON ELEMENT
Areas for LCE yards vary (Units 2 & 3)

Total square footage of each unit includes
garage area.

Assessor's Map Number

208-73-S2

STATE OF NEVADA

WASHOE COUNTY
ASSESSOR'S OFFICE

Michael E. Clark, Assessor

1001 East Ninth Street
Building D
Reno, Nevada 89512
(775) 328-2231



1 inch = 20 feet



created by: SR 07/14/2020

last updated:

area previously shown on map(s)

NOTE: This map was prepared for the use of the Washoe County Assessor for assessment and illustrative purposes only. It does not represent a survey of the premises. No liability is assumed as to the sufficiency or accuracy of the data delineated hereon.