

(#4350)
SILVERADO RANCH ESTATES
UNIT 9

PORTION OF THE SE ¼ SEC. 31
T20N - R19E
AND THE NW ¼ SEC. 5 & NE ¼ SEC. 6
T19N -R19E

WASHOE CO.
CITY OF RENO

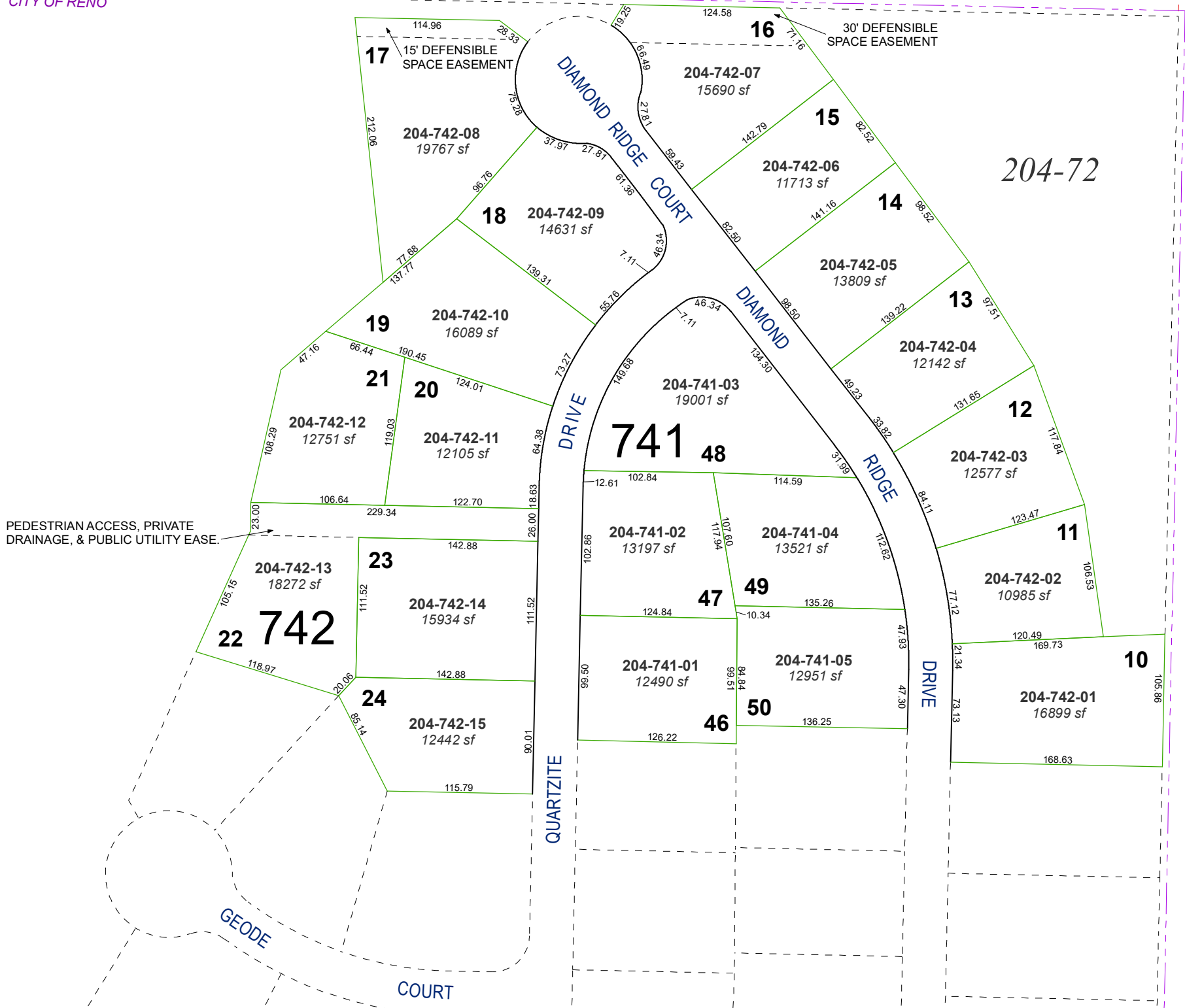

Section 31
Section 32

Assessor's Map Number

204-74

STATE OF NEVADA
WASHOE COUNTY
ASSESSOR'S OFFICE
1001 East Ninth Street, Building D
Reno, Nevada 89512
(775) 328-2231

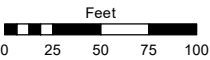

1 inch = 100 feet

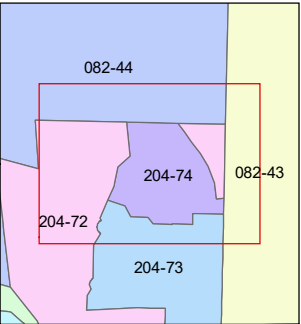
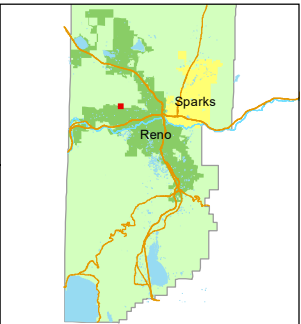

created by: KGC 9/27/2024

updated: _____

area previously shown on map(s):

204-01, 204-35

NOTE: This map was prepared for the use of the Washoe County Assessor for assessment and illustrative purposes only. It does not represent a survey of the premises. No liability is assumed as to the sufficiency or accuracy of the data delineated herein.