

(#160)
FLANIGAN TOWNSITE
PORTION OF THE NW 1/4 OF SEC. 31
T27N - R19E

T27N - 18E T27N - R19E

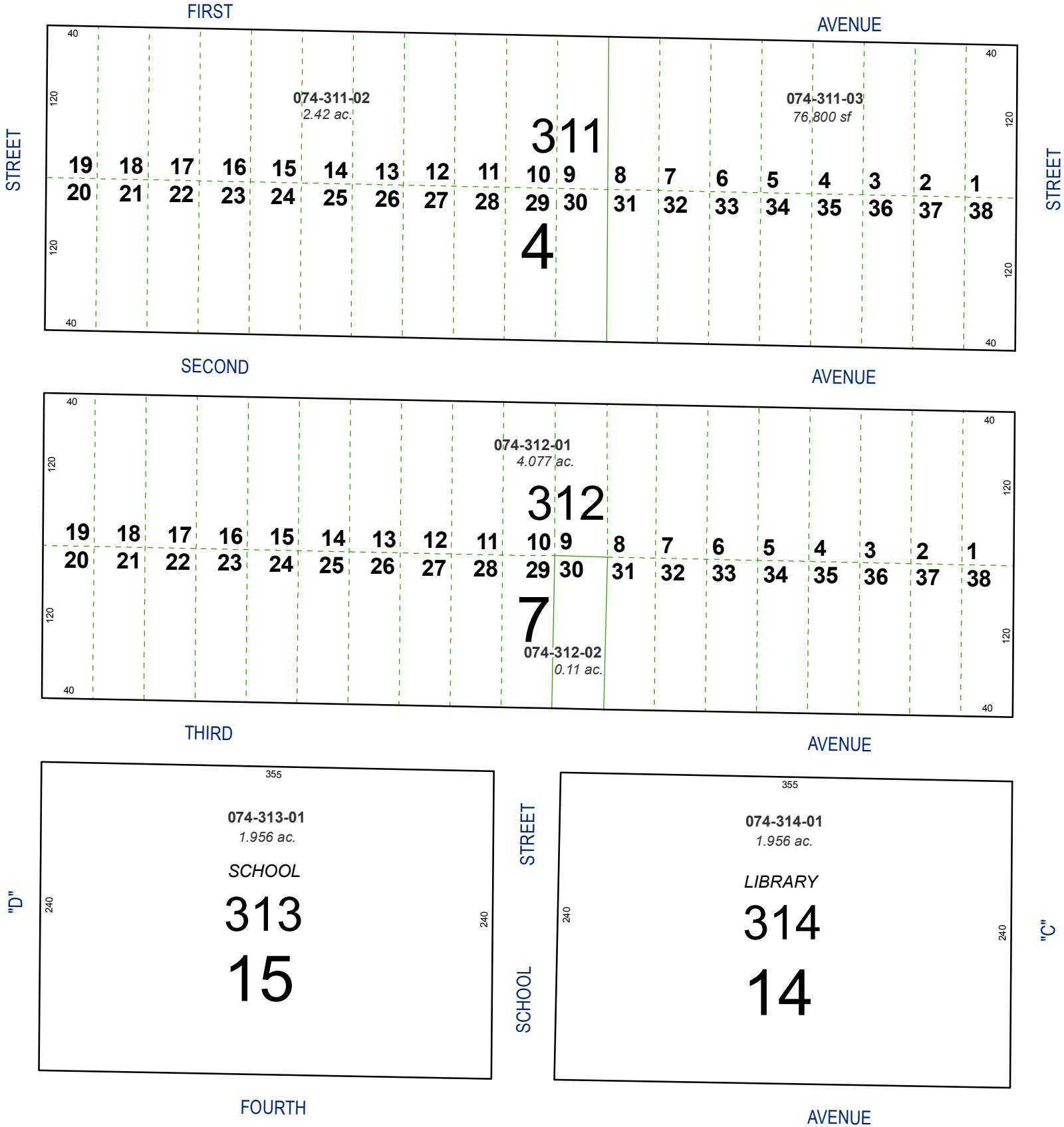

Assessor's Map Number

074-31

STATE OF NEVADA
WASHOE COUNTY
ASSESSOR'S OFFICE

Joshua G. Wilson, Assessor

1001 East Ninth Street
Building D
Reno, Nevada 89512
(775) 328-2231

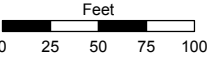

1 inch = 100 feet

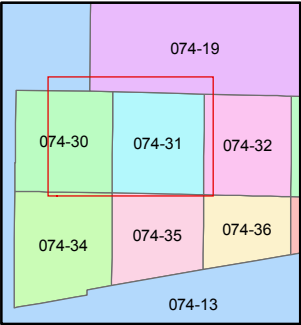
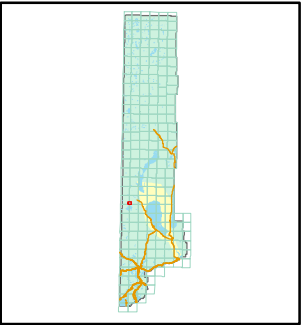

created by: TWT 1/3/2011

last updated: _____

area previously shown on map(s)

NOTE: This map was prepared for the use of the Washoe County Assessor for assessment and illustrative purposes only. It does not represent a survey of the premises. No liability is assumed as to the sufficiency or accuracy of the data delineated hereon.