

(#4789)
THE PALLADIO
A CONDOMINIUM SUBDIVISION
A POR. OF THE SE 1/4 OF SEC. 11
T19N - R19E

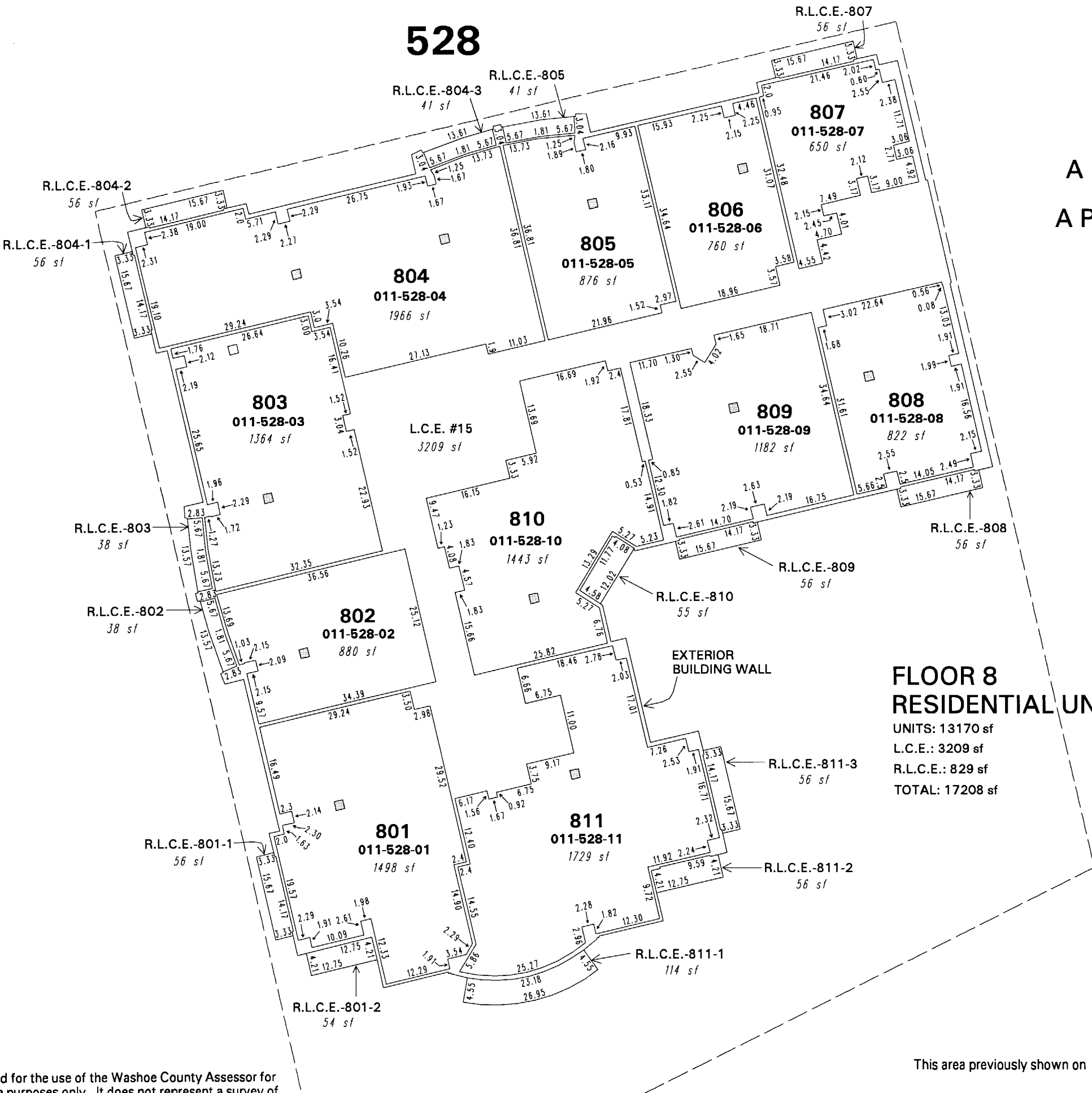

NOTES:
■ = CONCRETE COLUMN
L.C.E. = LIMITED COMMON ELEMENT
R.L.C.E. = RESIDENTIAL LIMITED COMMON ELEMENT
SEE PG. 011-52-S1 FOR THE
COMBINED COMMON ELEMENT
PARCELS FOR ALL FLOORS

**FLOOR 8
RESIDENTIAL UNITS**
UNITS: 13170 sf
L.C.E.: 3209 sf
R.L.C.E.: 829 sf
TOTAL: 17208 sf

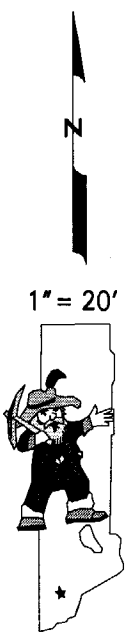

NOTE: This map is prepared for the use of the Washoe County Assessor for assessment and illustrative purposes only. It does not represent a survey of the premises. No liability is assumed as to the sufficiency or the accuracy of the data delineated hereon.

Office of Washoe County Assessor, Nevada - Joshua G. Wilson

This area previously shown on 011-11

NOTE: Areas of parcels which are less than 2 acres are shown in square feet.

Drawn by NLH 06/19/07
Revised _____
ARC/INFO 9.2 WINDOWS 2000 5.0