

(#4568)
RIVERWALK CONDOMINIUMS
A POR. OF THE SE 1/4 OF SEC. 11,
T19N - R19E

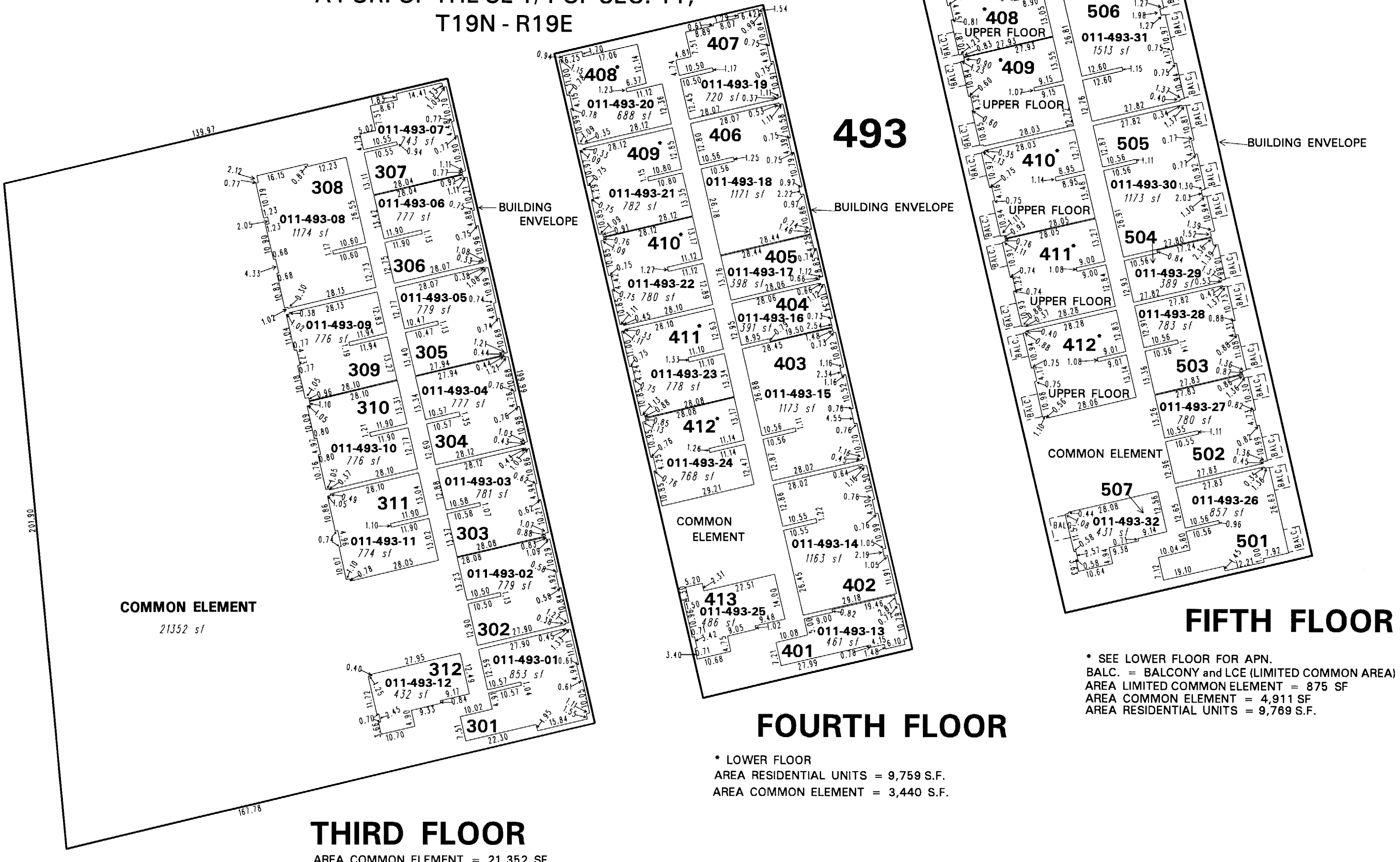

NOTE: This map is prepared for the use of the Washoe County Assessor for assessment and illustrative purposes only. It does not represent a survey of the premises. No liability is assumed as to the sufficiency or the accuracy of the data delineated hereon.

Office of Washoe County Assessor, Nevada - Joshua G. Wilson

This area previously shown on 011-04

NOTE: Areas of parcels which are less than 2 acres are shown in square feet.

Drawn by PK 12/6/05
Revised NLH 8/27/07 NLH 11/02/07