

Assessor's Map Number

006-43-S1

STATE OF NEVADA
WASHOE COUNTY
ASSESSOR'S OFFICE

1001 East Ninth Street, Building D
Reno, Nevada 89512
(775) 328-2231



1 inch = 40 feet

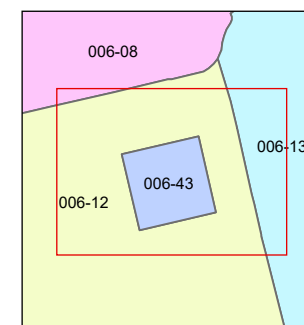
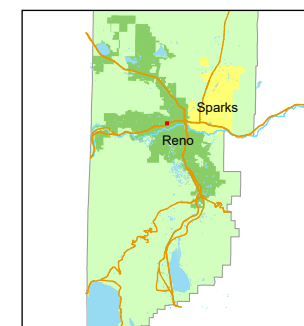

created by: KSB 4/20/2026

updated: _____

area previously shown on map(s):

006-12

NOTE: This map was prepared for the use of the Washoe County Assessor for assessment and illustrative purposes only. It does not represent a survey of the premises. No liability is assumed as to the sufficiency or accuracy of the data delineated herein.

PARCEL MAP (#5801)

POR. OF NE ¼ SECTION 10
T19N - R19E

SECOND FLOOR

432

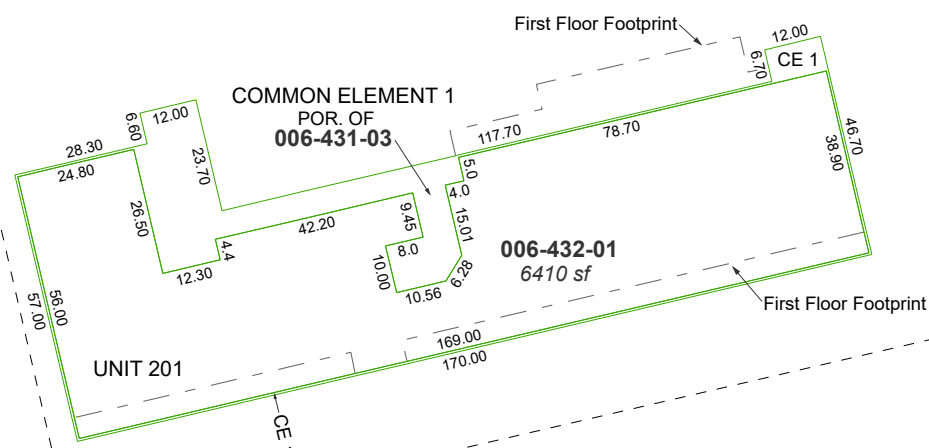

NOTES:

COMMON ELEMENT 1 is a vertical parcel with portions on the Basement Level, First Floor & Second Floor. The total parcel area consists of all 3 levels.

Further subdivision of Units 101, 102, 201 and the Common Element shall be performed by deed and successive Record of Survey Maps through the function of a Commercial Subdivision per NRS 278.325.

CE = COMMON ELEMENT

UNIVERSITY TERRACE

VINE STREET

CANAL STREET

W. SEVENTH STREET