

Assessor's Map Number

002-57-S4

STATE OF NEVADA
WASHOE COUNTY
ASSESSOR'S OFFICE

1001 East Ninth Street, Building D
Reno, Nevada 89512
(775) 328-2231

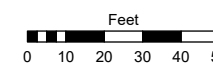

1 inch = 50 feet

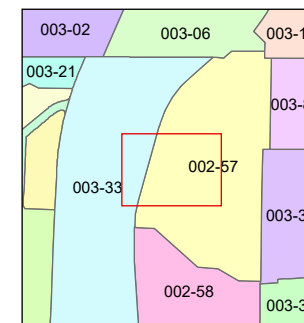
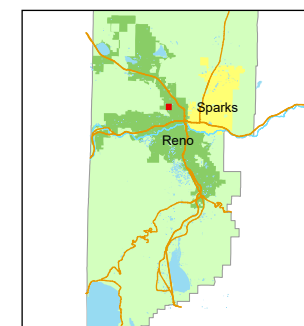

created by: KSB 5/15/2026

updated: _____

area previously shown on map(s):

002-57-S1

NOTE: This map was prepared for the use of the Washoe County Assessor for assessment and illustrative purposes only. It does not represent a survey of the premises. No liability is assumed as to the sufficiency or accuracy of the data delineated herein.

002-57-S3

PUBLIC UTILITY, STORM DRAIN & SEWER EASEMENT

PRIVATE DRAINAGE EASEMENT

PUBLIC STORM DRAIN EASE.

UNION PACIFIC RAILROAD

574

WAY

WINZE

002-57-S1

002-57-S1

(#5623)
COTTAGES AT COMSTOCK
NORTH - PHASE 2
A PLANNED UNIT DEVELOPMENT

POR. OF NW ¼ SECTION 35 &
SW ¼ SECTION 26
T20N - R19E

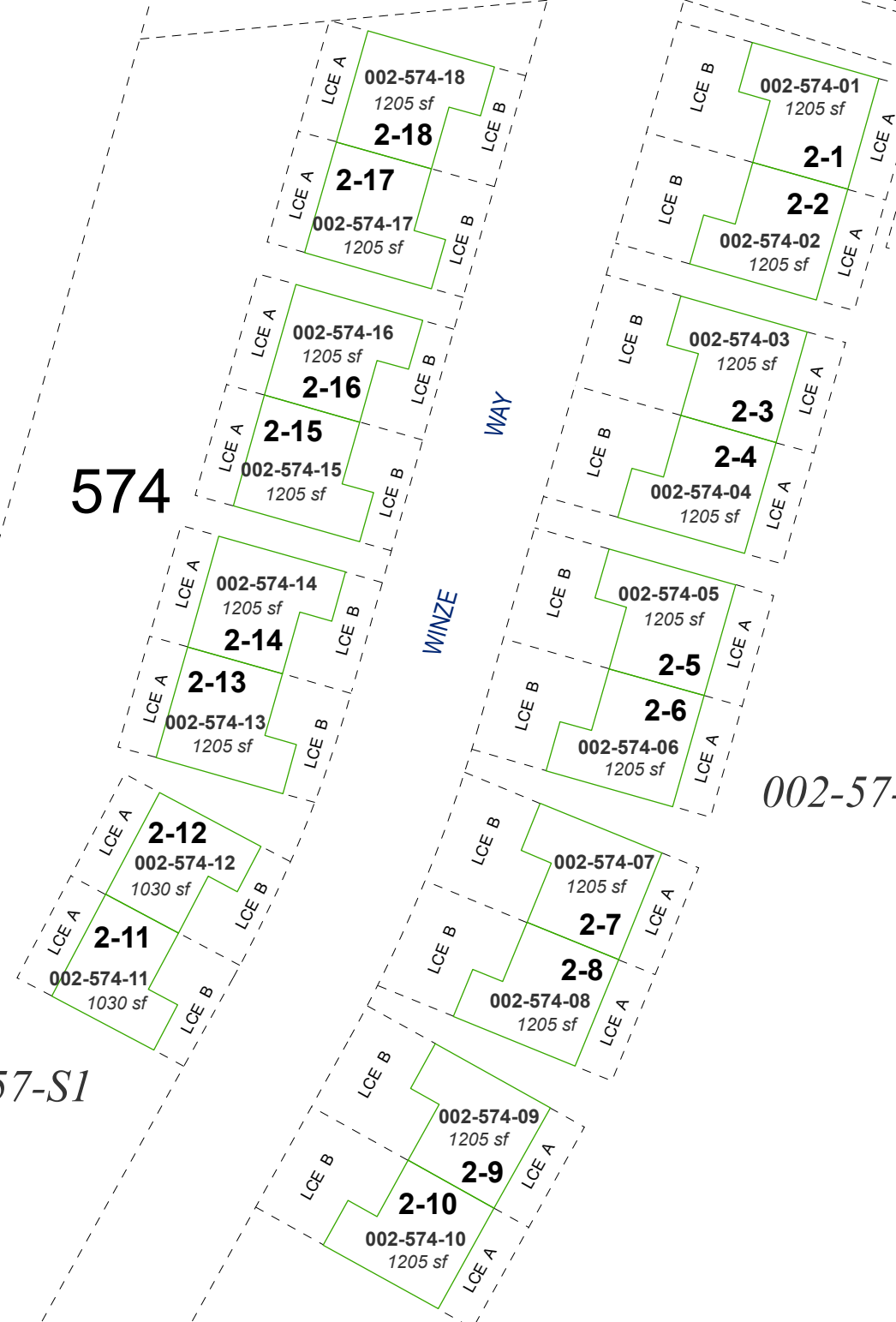

UNIT DETAILS ARE SHOWN ON 002-57

LCE = LIMITED COMMON ELEMENT